

TYLER COUNTY COMMISSIONERS COURT
SPECIAL MEETING

November 16, 2007 ---- 8:30 a.m.

THE STATE OF TEXAS ON THIS THE 16th day of November, 2007 the
Commissioners' Court in and for Tyler County, Texas convened in a Special Meeting at
the Commissioners' Courtroom in Woodville, Texas, the following members of the Court
present, to wit:

JACQUES L. BLANCHETTE	COUNTY JUDGE
MARTIN NASH	COMMISSIONER, PCT. #1
RUSTY HUGHES	COMMISSIONER, PCT. #2
JOE MARSHALL	COMMISSIONER, PCT. #3
JACK WALSTON	COMMISSIONER, PCT. #4
DONECE GREGORY	COUNTY CLERK, EX OFFICIO

The following were absent: none thereby constituting a quorum. In addition to
the above were:

JOYCE MOORE	COUNTY AUDITOR
JOE SMITH	CRIMINAL DISTRICT ATTORNEY
SHARON FULLER	COUNTY TREASURER

The invocation was delivered by Judge Blanchette.

A motion was made by Commissioner Walston and seconded by Commissioner Marshall
to approve the minutes of November 12, 2007. All voted yes and none no.

The County Auditor called attention to an additional invoice for lawyer's insurance for
Jerome Owens, District Judge. This is not a budgeted item. A motion was made by
Commissioner Nash and seconded by **Commissioner Hughes** to approve paying the
bills, including the lawyer's liability insurance for Judge Owens, as submitted by the
County Auditor. All voted and none no. SEE ATTACHED CLAIMS LIST

Commissioner Walston motioned to approve the **line item transfers** as presented by the
County Auditor. The motion was seconded by **Commissioner Nash**. All voted yes and
none no. SEE ATTACHED

A motion was made by **Commissioner Hughes** to approve the **County Treasurer's**
monthly report. **Commissioner Marshall** seconded this motion. All voted yes and
none no. SEE ATTACHED REPORT

Mike Walker and David Waxman presented the projected cuts to come within the
funding of the **grant** for **generators** and installation for sites in **Tyler County and the**
Tyler County Hospital. By deleting fencing, shed covers, and installation of generators
for Rockland and Seneca Water Supply, the lowest bid from McKinney & McMillan
would come within budget. Hopefully Tyler County Water Supply and Seneca Water
Supply can fund the shortfall. A motion was made by **Commissioner Walston** and
seconded by **Commissioner Hughes** to award the **bid** to McKinney and McMillan from
Jacksonville with the changes as presented by Mr. Walker and Mr. Waxman. All voted
yes and none no.

Commissioner Marshall motioned to grant a permit for a gas **pipeline** beneath **CR 4400**
in **Precinct #3**. The motion was seconded by **Commissioner Walston**. All voted yes
and none no. SEE ATTACHED

A motion was made by **Commissioner Walston** and seconded by **Commissioner Nash**
to grant a permit for a gas **pipeline** beneath **CR 4320** in **Precinct #4**. All voted yes and
none no. SEE ATTACHED

Item #9 was deferred until Mr. Powers could be present to present a contract from
Netdata for Justice of Peace, Pct. #3.

By conference call, Milton Powers, reported the cost of \$39,000 for a five year contract for **case management software** for Justice of Peace for Precincts #2, #3 and #4. Bill Moser, representing Netdata, called attention to the maintenance being an annual fee. JP #1 already has this software. A motion was made by **Commissioner Nash** and seconded by **Commissioner Walston** to approve the purchase of the software. Commissioner Nash and Commissioner Walston moved to amended their motion to include this purchase will not be paid until 2008 due to allowance in the budget. All voted yes and none no.

Alex Rawls, Sr. presented a request for a statement of "no opposition" on behalf of **IMEX, Inc. Recycling Facility** to be located on 17.53 acres in the M.McCormick Survey, Abst. #472.(old Allison Pole Mill site) **Commissioner Marshall** was concerned about the court being responsible for environmental issues and motioned to table this item until it could be reviewed by Joe Smith. **Commissioner Walston** seconded this motion. All voted yes and none no.

A motion was made by **Commissioner Walston** to advertise for proposals on **workers compensation**, as requested by Joyce Moore. **Commissioner Marshall** seconded this motion. All voted yes and none no.

Commissioner Marshall motioned to appoint Robert Allison to the **Tyler County Hospital Board** replacing Jim Parker who had moved out of Precinct #3. **Commissioner Walston** seconded this motion. All voted yes and none no.

Commissioner Walston motioned to approve the disposal of **office equipment** from the **county clerk's department** being an old Minolta 4233 copier and a broken Okidata 321 printer. **Commissioner Marshall** seconded the motion. All voted yes and none no.

Sandy Abshire presented an **employment and training assistance program** called "Experience Works". The federal government pays **wages** while they are learning for age 55 and older participants who meet eligibility guidelines. This program allows 20 hours a week for a period of six months with a cap of two years. This was an informational presentation only and no action was taken.

Information report- Auditor's report is ready but not on agenda
County Judge- meeting with the Governor and Todd Staples at an economic summit

Members of the court canvassed the General Election Results. A motion was made by Commissioner Nash and seconded by Commissioner Hughes to accept the results of the election. All voted yes and none no. SEE ATTACHED

Commissioner Walston motioned the meeting adjourned. Commissioner Hughes seconded the motion. All voted yes and none no.

THERE BEING NO FURTHER BUSINESS, THE MEETING ADJOURNED: 10:45 a.m.

I, Donece Gregory, County Clerk and ex officio member of the Tyler County Commissioners Court, do hereby certify to the fact that the above is a true and correct record of the Tyler County Commissioners Court session held on November 16, 2007.

Witness my hand and seal of office on this the 10th day of December, 2007.

Attest:

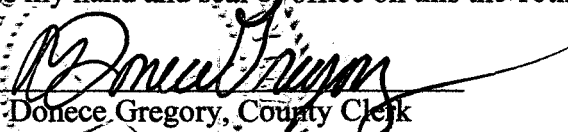
Donece Gregory, County Clerk
Tyler County, Texas

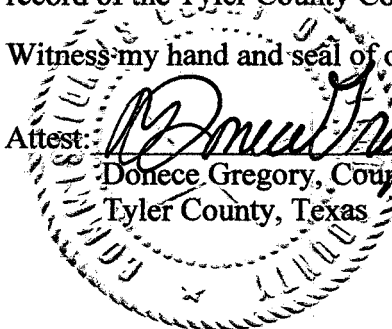

Commissioners Court

Packet Contents for November 16, 2007

NOTE: The Friday Agenda had to be posted before the Tuesday meeting took place, therefore, tabled items that were not previously requested to be placed on Friday's Agenda were unable to be posted on Friday's Agenda.

Copy of the posted Agenda for 8:30 AM with the following supporting documentation

Copy of the posted Agendas for 11:00 AM & 2:00 PM

1. Commissioners' Court Minutes. enclosed November 12th Special Meeting
not enclosed November 13th Regular meeting
2. no documentation enclosed
3. no documentation enclosed
4. County Treasurer monthly report
5. **MOVE TO AFTER ITEM #14: CANVASS THE ELECTION RESULTS**
6. no documentation enclosed
7. Permit for Gas Pipeline CR 4400 enclosed
8. Permit for Gas Pipeline CR 4320 enclosed
9. no documentation enclosed
10. Application information for IMEX, Inc. Recycling Facility
11. no documentation enclosed
12. no documentation enclosed
13. no documentation enclosed
14. Experience Works Fact Sheet
- MOVE ITEM #5 TO HERE: CANVASS THE ELECTION RESULTS**
15. no documentation enclosed

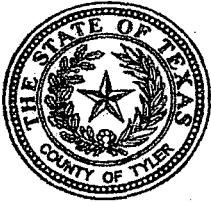

*All + Joyce, Joe
Sharon*

TYLER COUNTY COMMISSIONERS COURT
November 16, 2007 Tyler County Courthouse, Room 101
8:30 A.M. Woodville, Texas

NOTICE Is hereby given that a *Special Meeting* of the Tyler County Commissioners Court will be held on the date stated above, at which time the following subjects will be discussed: TIME 2:45pm

Blanchette

AGENDA

NOV 09 2007

DONECE GREGORY, COUNTY CLERK
TYLER COUNTY, TEXAS

Donece Gregory

CALL TO ORDER

- Establish quorum
- Invocation

1. CONSIDER/APPROVE: Commissioners' Court Minutes. - November 12, 2007 (Special Meeting);
November 13, 2007 (Regular Meeting) *X*

*N/A
w/n
A/m*

2. CONSIDER/APPROVE: Pay Tyler County Bills. - Joyce Moore, County Auditor

- Blm - may be a duplication of IRS for Judge Owens

*ATTN to for Lawyers Ins
for Judge Owens*

3. CONSIDER/APPROVE: Budget line item transfers. - Joyce Moore, County Auditor

4. CONSIDER/APPROVE: County Treasurer monthly report. - Sharon Fuller, County Treasurer

5. CONSIDER/APPROVE: Canvass the Election Results of the November 6th Constitutional Amendment Election. - Donece Gregory, County Auditor

6. CONSIDER/APPROVE: Bid for installation of ¹⁷generators and a 900 KW generator with installation for the Tyler County Hospital as required by the Tyler County Disaster Recovery - Generator Project through ORCA. - Jack Walston, Commissioner, Pct. 4
David Waxman - Lowbid Mollinway *Mike Walker?*

7. CONSIDER/APPROVE: Permit for Gas Pipeline beneath Tyler County Road 4400 ("CR 4400"). - Joe Marshall, Commissioner Pct. 3

8. CONSIDER/APPROVE: Permit for Gas Pipeline beneath Tyler County Road 4320 ("CR 4320"). - Jack Walston, Commissioner Pct. 4

9. CONSIDER/APPROVE: Contracts on Netdata. - Milton Powers, Justice of the Peace, Pct. 3

10. CONSIDER/APPROVE: Statement of "No Opposition" to IMEX, Inc. Recycling Facility at A0472 M. MCCORMICK, ACRES 17.53. - Alex L. Rawls, Sr.

11. CONSIDER/APPROVE: Go out for proposals on Workers Compensation. - Joyce Moore, County Auditor

12. CONSIDER/APPROVE: Hospital Board Appointment of Robert Allison. - Joe Marshall, Commissioner Pct. 3
J. K. Parker

13. CONSIDER/APPROVE: Office Equipment disposal (Copy Machine and printer; Minolta 4233 and Oki 321). - Donece Gregory, County Clerk

w/m

6 mths to 2 years max of 20 hrs
week

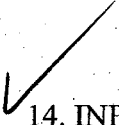

14. INFORMATIONAL PRESENTATION: Experience Works. Sandy Abshire – Employment & Training Assistant.

15. INFORMATIONAL REPORTS: (This item is included on the Agenda to receive announcements from the Court members and/or other Elected Officials and Department Heads of Tyler County.)

Economic summit

> ADJOURN

Jacques L. Blanchette

JACQUES L. BLANCHETTE
County Judge

I do hereby certify that the above Notice of Meeting of the Tyler County Commissioners Court is a true and correct copy of said Notice and that I posted a true and correct copy of said Notice in the Tyler County Courthouse at a place readily accessible to the general public at all times and that said Notice remained so posted continuously for at least 72 hours preceding the scheduled time of said meeting, as is required by Article 6252-17, V.T.C.S.

Executed on November 9 2007

Donece Gregory, Tyler County Clerk

By: *Jackie Skinner* (Deputy)

X/H to acct GADVASS

W/H to ads 10:45 AM

EXCEPT RECORDS FROM 11/16/2007 TO 11/16/2007 DATE-TO-BE-PAID

VENDOR NAME	ACCOUNT #	ACCOUNT NAME	ITEM/REASON	INVOICE #	VP DATE	DATE TBP	PO NO	AMOUNT
A T & T	2000 010-405-009	TELEPHONE	LONG DISTANCE	02	03/15/2000	/ /		.47
AFLAC INSURANCE	2000 010-202-100	SALARIES PAYABLE	AFLAC INS	05122000	05/12/2000	05/31/2000		110.59
AFLAC INSURANCE	2000 010-202-100	SALARIES PAYABLE	AFLAC INS	05122000	05/12/2000	05/31/2000		110.59
BRANCH, HERBERT	2007 010-361-002	STATE COMPTROLLER	CIVIL FEES	103106A	11/01/2006	10/31/2006		394.20
BURKS, LLOYD KELVIN	2000 010-426-045	U S MARSHALL TRAN	TRANSPORT	6506	07/28/2000	07/28/2000		119.36
COKER, RICKY	2000 010-426-045	U S MARSHALL TRAN	TRANSPORT	6600	07/28/2000	07/28/2000		298.40
DOCHES COMMUNITY CREDIT	2000 010-202-100	SALARIES PAYABLE	CREDIT UNION	05122000	05/12/2000	05/31/2000		1,485.00
DOCHES COMMUNITY CREDIT	2000 010-202-100	SALARIES PAYABLE	CREDIT UNION	05122000	05/12/2000	05/31/2000		1,485.00
DOCHES COMMUNITY CREDIT	2003 010-202-100	SALARIES PAYABLE	CHECK: 058719 AUTO	05142003	05/14/2003	05/14/2003		68.59
DOCHES COMMUNITY CREDIT	2003 010-202-100	SALARIES PAYABLE	CREDIT UNION	05142003	05/14/2003	05/14/2003		68.59
FICA	2003 010-202-100	SALARIES PAYABLE	CHECK: 058719 AUTO	05142003	05/14/2003	05/14/2003		42.35
FICA	2003 010-402-002	SOCIAL SECURITY	CHECK: 058719 AUTO	05142003	05/14/2003	05/14/2003		42.35
FICA	2003 010-202-100	SALARIES PAYABLE	FICA	05142003	05/14/2003	05/14/2003		42.35
FICA	2003 010-402-002	SOCIAL SECURITY	FICA	05142003	05/14/2003	05/14/2003		42.35
FIT	2003 010-202-100	SALARIES PAYABLE	CHECK: 058719 AUTO	05142003	05/14/2003	05/14/2003		14.35
FIT	2003 010-202-100	SALARIES PAYABLE	FIT	05142003	05/14/2003	05/14/2003		14.35
FRED VOL. FIRE DEPARTME	2000 010-401-026	RURAL FIRE PROTEC	RURAL FIRE	FRED FEB	02/08/2000	01/14/2000		75.00
FULLER, JOHN	2000 010-426-045	U S MARSHALL TRAN	TRANSPORT	6505	07/28/2000	07/28/2000		119.36
GALL'S INC	2000 010-419-033	RADIO REPAIR	TRAINING	5438	07/28/2000	07/28/2000		176.91
GUILLORY, BRIAN M	2000 010-426-045	U S MARSHALL TRAN	TRANSPORT	6597	07/28/2000	07/28/2000		1,014.26
GUILLORY, RICHARD ALLEN	2000 010-426-045	U S MARSHALL TRAN	TRANSPORT	6598	07/28/2000	07/28/2000		119.36
JOHNSON, BEN ROSS	2000 010-426-045	U S MARSHALL TRAN	TRANSPORT	6599	07/28/2000	07/28/2000		238.72
JOHNSTON, WANDA	2000 010-402-012	TRAINING & EDUCAT	REIMB	6705	07/28/2000	07/28/2000		595.05
KIRKWOOD, CHARLES EDWAR	2004 010-415-061	PETIT JURORS	PETIT JURY 11-16-04	09238CEK	11/17/2004	11/16/2004		6.00
LEE, INA	2000 010-426-045	U S MARSHALL TRAN	TRANSPORT	6507	07/28/2000	07/28/2000		179.04
MASHAW, JEFFREY C	2000 010-426-045	U S MARSHALL TRAN	TRANSPORT	6501	07/28/2000	07/28/2000		298.40
MCCARVER, MATT	2003 010-442-010	REPAIRS TO COURTH	TCJ 3826202 3824344	L7985019L	01/21/2003	12/42/0039		17.25
MEDICARE - ELECTRONIC T	2003 010-202-100	SALARIES PAYABLE	CHECK: 058719 AUTO	05142003	05/14/2003	05/14/2003		9.90
MEDICARE - ELECTRONIC T	2003 010-402-002	SOCIAL SECURITY	CHECK: 058719 AUTO	05142003	05/14/2003	05/14/2003		9.90
MEDICARE - ELECTRONIC T	2003 010-202-100	SALARIES PAYABLE	MEDICARE	05142003	05/14/2003	05/14/2003		9.90
MEDICARE - ELECTRONIC T	2003 010-402-002	SOCIAL SECURITY	MEDICARE	05142003	05/14/2003	05/14/2003		9.90
MEREDITH, WAYNE	2000 010-419-040	LIABILITY INSURAN	REIMB	6379	07/28/2000	07/28/2000		223.64
NATIONWIDE RETIREMENT S	2000 010-202-100	SALARIES PAYABLE	NACD	05122000	05/12/2000	05/31/2000		1,246.64
NET SALARIES	2003 010-202-100	SALARIES PAYABLE	CHECK: 058719 AUTO	05142003	05/14/2003	05/14/2003		500.00
NET SALARIES	2003 010-202-100	SALARIES PAYABLE	NET SALARIES	05142003	05/14/2003	05/14/2003		500.00
OGDEN, MARY I	2000 010-427-024	TRAVEL & EDUCATIO	TRAVEL	6596	07/28/2000	07/28/2000		88.14
OWENS, JEROME 1A JUDICI	2000 010-421-012	EDUCATION,GOVERN	REIMB	07252000	07/28/2000	07/28/2000		408.00
OWENS, JEROME 1A JUDICI	2004 010-421-012	EDUCATION,GOVERN	TRAVEL REIMBURSEMEN	08312004	09/02/2004	09/02/2004		1,732.91
PHILLIPS, VIRGINIA	1999 010-401-050	ELECTION EXPENSE	ELECTION	003	11/05/1999	11/05/1999		68.24
POLICE & FIREMAN'S INSU	2000 010-202-100	SALARIES PAYABLE	POLICE INSURANCE	05122000	05/12/2000	05/31/2000		319.01
POLICE & FIREMAN'S INSU	2000 010-202-100	SALARIES PAYABLE	POLICE INSURANCE	05122000	05/12/2000	05/31/2000		319.01
PUBLIC NET XCHANGE	2000 010-401-009	PROBATION TELEPHO	INTERNET SERVICE	7018	07/28/2000	07/28/2000		23.20
RILEY, JAMES A	1999 010-401-050	ELECTION EXPENSE	ELECTION	002	11/05/1999	11/05/1999		68.24
RISINGER, MICHAEL	2000 010-419-015	WITNESS EXPENSE	MEALS	6378	07/28/2000	07/28/2000		35.56
SAN HOUSTON ELECTRIC CO	2004 010-436-049	AID TO INDIGENTS	DEBRA GORE	12712	07/01/2004	07/01/2004		35.00
SAN HOUSTON ELECTRIC CO	2007 010-436-049	AID TO INDIGENTS	VIVIAN LEE	15986	01/02/2007	01/02/2007		35.00
SECURITY INSURANCE SERV	2006 010-402-014	BONDS, INSURANCE	ERRORS & OMISSIONS	269921	06/29/2006	06/30/2006		2,917.62
STANDARD INSURANCE COMP	2000 010-202-100	SALARIES PAYABLE	STANDARD COUNTY LIF	05122000	05/12/2000	05/31/2000		43.48
STATE COMPTROLLER-EFT	2006 010-361-002	STATE COMPTROLLER	CIVIL FEES	103106A	11/01/2006	10/31/2006		394.20
STATE COMPTROLLER-EFT	2006 010-363-028	COUNTY CLERK FEES	CIVIL FEES	103106B	11/01/2006	10/31/2006		589.00
STATE COMPTROLLER-EFT	2006 010-363-038	INDIGENT CIVIL LE	CIVIL FEES	103106D	11/01/2006	10/31/2006		123.50
STATE COMPTROLLER-EFT	2006 010-361-005	PAYMENT IN LIEU O	CIVIL FEES	103106E	11/01/2006	10/31/2006		1,040.00
STATE COMPTROLLER-EFT	2006 010-361-002	STATE COMPTROLLER	CIVIL FEES	103106F	11/01/2006	10/31/2006		1,342.50
STATE COMPTROLLER-EFT	2006 010-361-002	STATE COMPTROLLER	CIVIL FEES	103106G	11/01/2006	10/31/2006		2,673.00
STATE COMPTROLLER-EFT	2006 010-363-038	INDIGENT CIVIL LE	CIVIL FEES	103106H	11/01/2006	10/31/2006		256.50

EXCEPT RECORDS FROM 11/16/2007 TO 11/16/2007 DATE-TO-BE-PAID

VENDOR NAME	ACCOUNT #	ACCOUNT NAME	ITEM/REASON	INVOICE #	VP DATE	DATE TBP	PO NO	AMOUNT
STATE COMPTROLLER-EFT	2006 010-361-002	STATE COMPTROLLER	CRIMINAL COST FEES	103006V	11/01/2006	10/31/2006		387.00
STATE COMPTROLLER-EFT	2007 010-361-002	STATE COMPTROLLER	CIVIL FEES/QRTRLY R	07312007A	07/30/2007	07/30/2007		444.60
STATE COMPTROLLER-EFT	2007 010-361-002	STATE COMPTROLLER	CIVIL FEES/QRTRLY R	07312007B	07/30/2007	07/30/2007		737.00
STATE COMPTROLLER-EFT	2007 010-363-038	INDIGENT CIVIL LE	CIVIL FEES/QRTRLY R	07312007D	07/30/2007	07/30/2007		166.25
STATE COMPTROLLER-EFT	2007 010-361-002	STATE COMPTROLLER	CIVIL FEES/QRTRLY R	07312007E	07/30/2007	07/30/2007		1,320.00
STATE COMPTROLLER-EFT	2007 010-361-002	STATE COMPTROLLER	CIVIL FEES/QRTRLY R	07312007F	07/30/2007	07/30/2007		2,103.25
STATE COMPTROLLER-EFT	2007 010-361-002	STATE COMPTROLLER	CIVIL FEES/QRTRLY R	07312007G	07/30/2007	07/30/2007		2,178.00
STATE COMPTROLLER-EFT	2007 010-363-038	INDIGENT CIVIL LE	CIVIL FEES/QRTRLY R	07312007H	07/30/2007	07/30/2007		779.00
STATE COMPTROLLER-EFT	2007 010-361-002	STATE COMPTROLLER	STATECRIMINALCOST&F	07312007DD	07/30/2007	07/30/2007		555.00
STATE COMPTROLLER-EFT	2007 010-363-021	JUSTICE-OF-PEACE	STATECRIMINALCOST&F	07312007EE	07/30/2007	07/30/2007		580.00
STATE COMPTROLLER-EFT	2007 010-363-038	INDIGENT CIVIL LE	QUARTERLY REPORT	10-07V	10/31/2007	10/31/2007		147.25
STATE COMPTROLLER-EFT	2007 010-361-002	STATE COMPTROLLER	QUARTERLY REPORT	10-07W	10/31/2007	10/31/2007		1,240.00
STATE COMPTROLLER-EFT	2007 010-361-002	STATE COMPTROLLER	QUARTERLY REPORT	10-07X	10/31/2007	10/31/2007		1,969.00
STATE COMPTROLLER-EFT	2007 010-361-002	STATE COMPTROLLER	QUARTERLY REPORT	10-07Y	10/31/2007	10/31/2007		2,029.50
STATE COMPTROLLER-EFT	2007 010-363-038	INDIGENT CIVIL LE	QUARTERLY REPORT	10-07Z	10/31/2007	10/31/2007		769.50
SYLESTINE, WILLIAM CLAY	2000 010-426-045	U S MARSHALL TRAN	TRANSPORT	6502	07/28/2000	07/28/2000		671.40
TEXAS COUNTY & DISTRICT	2000 010-202-100	SALARIES PAYABLE	TCDRS-RETIREMENT	05122000	05/12/2000	05/31/2000		4,230.76
TEXAS COUNTY & DISTRICT	2000 010-402-003	RETIREMENT	TCDRS-RETIREMENT	05122000	05/12/2000	05/31/2000		321.07
TEXAS COUNTY & DISTRICT	2000 010-407-003	RETIREMENT	TCDRS-RETIREMENT	05122000	05/12/2000	05/31/2000		175.53
TEXAS COUNTY & DISTRICT	2000 010-409-003	RETIREMENT	TCDRS-RETIREMENT	05122000	05/12/2000	05/31/2000		59.67
TEXAS COUNTY & DISTRICT	2000 010-410-003	RETIREMENT	TCDRS-RETIREMENT	05122000	05/12/2000	05/31/2000		36.59
TEXAS COUNTY & DISTRICT	2000 010-411-003	RETIREMENT	TCDRS-RETIREMENT	05122000	05/12/2000	05/31/2000		160.42
TEXAS COUNTY & DISTRICT	2000 010-412-003	RETIREMENT	TCDRS-RETIREMENT	05122000	05/12/2000	05/31/2000		44.41
TEXAS COUNTY & DISTRICT	2000 010-413-003	RETIREMENT	TCDRS-RETIREMENT	05122000	05/12/2000	05/31/2000		45.03
TEXAS COUNTY & DISTRICT	2000 010-414-003	RETIREMENT	TCDRS-RETIREMENT	05122000	05/12/2000	05/31/2000		44.41
TEXAS COUNTY & DISTRICT	2000 010-419-003	RETIREMENT	TCDRS-RETIREMENT	05122000	05/12/2000	05/31/2000		486.96
TEXAS COUNTY & DISTRICT	2000 010-420-003	RETIREMENT	TCDRS-RETIREMENT	05122000	05/12/2000	05/31/2000		286.81
TEXAS COUNTY & DISTRICT	2000 010-421-003	RETIREMENT	TCDRS-RETIREMENT	05122000	05/12/2000	05/31/2000		210.84
TEXAS COUNTY & DISTRICT	2000 010-422-003	RETIREMENT	TCDRS-RETIREMENT	05122000	05/12/2000	05/31/2000		101.70
TEXAS COUNTY & DISTRICT	2000 010-423-003	RETIREMENT	TCDRS-RETIREMENT	05122000	05/12/2000	05/31/2000		125.71
TEXAS COUNTY & DISTRICT	2000 010-424-003	RETIREMENT	TCDRS-RETIREMENT	05122000	05/12/2000	05/31/2000		23.57
TEXAS COUNTY & DISTRICT	2000 010-425-003	RETIREMENT	TCDRS-RETIREMENT	05122000	05/12/2000	05/31/2000		24.40
TEXAS COUNTY & DISTRICT	2000 010-426-003	RETIREMENT	TCDRS-RETIREMENT	05122000	05/12/2000	05/31/2000		1,915.55
TEXAS COUNTY & DISTRICT	2000 010-427-003	RETIREMENT	TCDRS-RETIREMENT	05122000	05/12/2000	05/31/2000		596.79
TEXAS COUNTY & DISTRICT	2000 010-428-003	RETIREMENT	TCDRS-RETIREMENT	05122000	05/12/2000	05/31/2000		23.57
TEXAS COUNTY & DISTRICT	2000 010-429-003	RETIREMENT	TCDRS-RETIREMENT	05122000	05/12/2000	05/31/2000		23.57
TEXAS COUNTY & DISTRICT	2000 010-430-003	RETIREMENT	TCDRS-RETIREMENT	05122000	05/12/2000	05/31/2000		57.27
TEXAS COUNTY & DISTRICT	2000 010-438-003	RETIREMENT	TCDRS-RETIREMENT	05122000	05/12/2000	05/31/2000		120.12
TEXAS COUNTY & DISTRICT	2000 010-439-003	RETIREMENT	TCDRS-RETIREMENT	05122000	05/12/2000	05/31/2000		56.03
TEXAS COUNTY & DISTRICT	2000 010-442-003	RETIREMENT	TCDRS-RETIREMENT	05122000	05/12/2000	05/31/2000		58.22
TEXAS COUNTY & DISTRICT	2000 010-202-100	SALARIES PAYABLE	TCDRS-RETIREMENT	05122000	05/12/2000	05/31/2000		4,230.76
TEXAS COUNTY & DISTRICT	2000 010-402-003	RETIREMENT	TCDRS-RETIREMENT	05122000	05/12/2000	05/31/2000		321.07
TEXAS COUNTY & DISTRICT	2000 010-407-003	RETIREMENT	TCDRS-RETIREMENT	05122000	05/12/2000	05/31/2000		175.53
TEXAS COUNTY & DISTRICT	2000 010-409-003	RETIREMENT	TCDRS-RETIREMENT	05122000	05/12/2000	05/31/2000		59.67
TEXAS COUNTY & DISTRICT	2000 010-410-003	RETIREMENT	TCDRS-RETIREMENT	05122000	05/12/2000	05/31/2000		36.59
TEXAS COUNTY & DISTRICT	2000 010-411-003	RETIREMENT	TCDRS-RETIREMENT	05122000	05/12/2000	05/31/2000		160.42
TEXAS COUNTY & DISTRICT	2000 010-412-003	RETIREMENT	TCDRS-RETIREMENT	05122000	05/12/2000	05/31/2000		44.41
TEXAS COUNTY & DISTRICT	2000 010-413-003	RETIREMENT	TCDRS-RETIREMENT	05122000	05/12/2000	05/31/2000		45.03
TEXAS COUNTY & DISTRICT	2000 010-414-003	RETIREMENT	TCDRS-RETIREMENT	05122000	05/12/2000	05/31/2000		44.41
TEXAS COUNTY & DISTRICT	2000 010-419-003	RETIREMENT	TCDRS-RETIREMENT	05122000	05/12/2000	05/31/2000		486.96
TEXAS COUNTY & DISTRICT	2000 010-420-003	RETIREMENT	TCDRS-RETIREMENT	05122000	05/12/2000	05/31/2000		286.81
TEXAS COUNTY & DISTRICT	2000 010-421-003	RETIREMENT	TCDRS-RETIREMENT	05122000	05/12/2000	05/31/2000		210.84
TEXAS COUNTY & DISTRICT	2000 010-422-003	RETIREMENT	TCDRS-RETIREMENT	05122000	05/12/2000	05/31/2000		101.70
TEXAS COUNTY & DISTRICT	2000 010-423-003	RETIREMENT	TCDRS-RETIREMENT	05122000	05/12/2000	05/31/2000		125.71
TEXAS COUNTY & DISTRICT	2000 010-424-003	RETIREMENT	TCDRS-RETIREMENT	05122000	05/12/2000	05/31/2000		23.57

EXCEPT RECORDS FROM 11/16/2007 TO 11/16/2007 DATE-TO-BE-PAID

VENDOR NAME	ACCOUNT #	ACCOUNT NAME	ITEM/REASON	INVOICE #	VP DATE	DATE TBP	PO NO	AMOUNT
TEXAS COUNTY & DISTRICT	2000 010-425-003	RETIREMENT	TCDRS-RETIREMENT	05122000	05/12/2000	05/31/2000		24.40
TEXAS COUNTY & DISTRICT	2000 010-426-003	RETIREMENT	TCDRS-RETIREMENT	05122000	05/12/2000	05/31/2000		1,915.55
TEXAS COUNTY & DISTRICT	2000 010-427-003	RETIREMENT	TCDRS-RETIREMENT	05122000	05/12/2000	05/31/2000		596.79
TEXAS COUNTY & DISTRICT	2000 010-428-003	RETIREMENT	TCDRS-RETIREMENT	05122000	05/12/2000	05/31/2000		23.57
TEXAS COUNTY & DISTRICT	2000 010-429-003	RETIREMENT	TCDRS-RETIREMENT	05122000	05/12/2000	05/31/2000		23.57
TEXAS COUNTY & DISTRICT	2000 010-430-003	RETIREMENT	TCDRS-RETIREMENT	05122000	05/12/2000	05/31/2000		57.27
TEXAS COUNTY & DISTRICT	2000 010-438-003	RETIREMENT	TCDRS-RETIREMENT	05122000	05/12/2000	05/31/2000		120.12
TEXAS COUNTY & DISTRICT	2000 010-439-003	RETIREMENT	TCDRS-RETIREMENT	05122000	05/12/2000	05/31/2000		56.03
TEXAS COUNTY & DISTRICT	2000 010-442-003	RETIREMENT	TCDRS-RETIREMENT	05122000	05/12/2000	05/31/2000		58.22
TEXAS COUNTY & DISTRICT	2003 010-202-100	SALARIES PAYABLE	CHECK: 058719 AUTO	05142003	05/14/2003	05/14/2003		47.81-
TEXAS COUNTY & DISTRICT	2003 010-402-003	RETIREMENT	CHECK: 058719 AUTO	05142003	05/14/2003	05/14/2003		55.32-
TEXAS COUNTY & DISTRICT	2003 010-202-100	SALARIES PAYABLE	TCDRS-RETIREMENT	05142003	05/14/2003	05/14/2003		47.81
TEXAS COUNTY & DISTRICT	2003 010-402-003	RETIREMENT	TCDRS-RETIREMENT	05142003	05/14/2003	05/14/2003		55.32
TEXAS DEPARTMENT OF CRI	2007 010-401-050	ELECTION EXPENSE	15 HRS @ 7.00	111606J	11/17/2004	11/16/2004		105.00
TEXAS DEPARTMENT OF PAR	2000 010-363-034	COUNTY CLERK FINE	DONNIE MCINNIS	6706	07/28/2000	07/28/2000		560.00
THE STANDARD INSURANCE	2000 010-426-004	HOSPITALIZATION	STANDARD VOL LIFE		02/25/2000	/ /		401.86
TYLER COUNTY COLLECTION	2006 010-496-037	TRANSFER TO COLLE	TRNS FROM GEN FUND	013106C	01/11/2006	01/31/06C		12,500.00
TYLER COUNTY HEALTH	2000 010-202-100	SALARIES PAYABLE	TYLER COUNTY HEALTH	05122000	05/12/2000	05/31/2000		444.96
TYLER COUNTY HEALTH	2000 010-402-004	HOSPITALIZATION	TYLER COUNTY HEALTH	05122000	05/12/2000	05/31/2000		625.00
TYLER COUNTY HEALTH	2000 010-405-004	HOSPITALIZATION	TYLER COUNTY HEALTH	05122000	05/12/2000	05/31/2000		125.00
TYLER COUNTY HEALTH	2000 010-407-004	HOSPITALIZATION	TYLER COUNTY HEALTH	05122000	05/12/2000	05/31/2000		375.00
TYLER COUNTY HEALTH	2000 010-411-004	HOSPITALIZATION	TYLER COUNTY HEALTH	05122000	05/12/2000	05/31/2000		250.00
TYLER COUNTY HEALTH	2000 010-412-004	HOSPITALIZATION	TYLER COUNTY HEALTH	05122000	05/12/2000	05/31/2000		125.00
TYLER COUNTY HEALTH	2000 010-413-004	HOSPITALIZATION	TYLER COUNTY HEALTH	05122000	05/12/2000	05/31/2000		125.00
TYLER COUNTY HEALTH	2000 010-414-004	HOSPITALIZATION	TYLER COUNTY HEALTH	05122000	05/12/2000	05/31/2000		125.00
TYLER COUNTY HEALTH	2000 010-419-004	HOSPITALIZATION	TYLER COUNTY HEALTH	05122000	05/12/2000	05/31/2000		500.00
TYLER COUNTY HEALTH	2000 010-420-004	HOSPITALIZATION	TYLER COUNTY HEALTH	05122000	05/12/2000	05/31/2000		500.00
TYLER COUNTY HEALTH	2000 010-421-004	HOSPITALIZATION	TYLER COUNTY HEALTH	05122000	05/12/2000	05/31/2000		250.00
TYLER COUNTY HEALTH	2000 010-422-004	HOSPITALIZATION	TYLER COUNTY HEALTH	05122000	05/12/2000	05/31/2000		125.00
TYLER COUNTY HEALTH	2000 010-423-004	HOSPITALIZATION	TYLER COUNTY HEALTH	05122000	05/12/2000	05/31/2000		125.00
TYLER COUNTY HEALTH	2000 010-424-004	HOSPITALIZATION	TYLER COUNTY HEALTH	05122000	05/12/2000	05/31/2000		125.00
TYLER COUNTY HEALTH	2000 010-425-004	HOSPITALIZATION	TYLER COUNTY HEALTH	05122000	05/12/2000	05/31/2000		125.00
TYLER COUNTY HEALTH	2000 010-426-004	HOSPITALIZATION	TYLER COUNTY HEALTH	05122000	05/12/2000	05/31/2000		3,225.00
TYLER COUNTY HEALTH	2000 010-427-004	HOSPITALIZATION	TYLER COUNTY HEALTH	05122000	05/12/2000	05/31/2000		750.00
TYLER COUNTY HEALTH	2000 010-428-004	HOSPITALIZATION	TYLER COUNTY HEALTH	05122000	05/12/2000	05/31/2000		125.00
TYLER COUNTY HEALTH	2000 010-429-004	HOSPITALIZATION	TYLER COUNTY HEALTH	05122000	05/12/2000	05/31/2000		125.00
TYLER COUNTY HEALTH	2000 010-430-004	HOSPITALIZATION	TYLER COUNTY HEALTH	05122000	05/12/2000	05/31/2000		125.00
TYLER COUNTY HEALTH	2000 010-438-004	HOSPITALIZATION	TYLER COUNTY HEALTH	05122000	05/12/2000	05/31/2000		250.00
TYLER COUNTY HEALTH	2000 010-439-004	HOSPITALIZATION	TYLER COUNTY HEALTH	05122000	05/12/2000	05/31/2000		125.00
TYLER COUNTY HEALTH	2000 010-442-004	HOSPITALIZATION	TYLER COUNTY HEALTH	05122000	05/12/2000	05/31/2000		125.00
UNLOCKING POTENTIAL INS	2000 010-426-024	TRAVEL & EDUCATIO	TRAINING	6395	07/28/2000	07/28/2000		321.30
VERIZON WIRELESS	2001 010-438-007	SUPPLIES AND OPER	VERIZON WIRELESS		02/08/2001	/ /		5.18
VIKING OFFICE PRODUCTS	1999 010-420-007	OFFICE SUPPLIES	MAG	652381	05/10/1999	06/10/1999		36.65
WAL-MART COMMUNITY	2000 010-419-007	OFFICE SUPPLIES	SUPPLIES	6375	07/28/2000	07/28/2000		192.99
WESTFALL, LETHA	2006 010-401-050	ELECTION EXPENSE	15 HRS @ 7.00	111606J	11/17/2004	11/16/2004		105.00
WILSON, MARK	2000 010-426-045	U S MARSHALL TRAN	TRANSPORT	6503	07/28/2000	07/28/2000		432.68
WILSON, WILLIAM MICHAEL	2000 010-426-045	U S MARSHALL TRAN	TRANSPPORT	6504	07/28/2000	07/28/2000		238.72
WOOD, ROBERT H.	2000 010-401-099	CONTINGENCY FOR M	RENT CHILD WELFARE	4456	07/28/2000	07/28/2000		100.00

79,154.44

EXCEPT RECORDS FROM 11/16/2007 TO 11/16/2007 DATE-TO-BE-PAID

VENDOR NAME	ACCOUNT #	ACCOUNT NAME	ITEM/REASON	INVOICE #	VP DATE	DATE TBP	PO NO	AMOUNT
AFLAC INSURANCE	2000 021-202-100	SALARIES PAYABLE	AFLAC INS	05122000	05/12/2000	05/31/2000		69.09
AFLAC INSURANCE	2000 021-202-100	SALARIES PAYABLE	AFLAC INS	05122000	05/12/2000	05/31/2000		69.09
DOCHES COMMUNITY CREDIT	2000 021-202-100	SALARIES PAYABLE	CREDIT UNION	05122000	05/12/2000	05/31/2000		284.00
DOCHES COMMUNITY CREDIT	2000 021-202-100	SALARIES PAYABLE	CREDIT UNION	05122000	05/12/2000	05/31/2000		284.00
GARDNER OIL, INC.	2004 021-451-029	GAS, OIL, GREASE	PCT1 PREM UNLEADED	65995	01/12/2004	10/16/2004		546.75
GARDNER OIL, INC.	2004 021-451-029	GAS, OIL, GREASE	PCT1 DIESEL FUEL	65998	01/12/2004	10/16/2004		314.70
GARDNER OIL, INC.	2004 021-451-029	GAS, OIL, GREASE	PCT1 PREM UNLEADED	66141	01/12/2004	10/16/2004		480.70
GARDNER OIL, INC.	2004 021-451-029	GAS, OIL, GREASE	PCT1 DYED DIESEL	66143	01/12/2004	10/16/2004		314.70
GARDNER OIL, INC.	2004 021-451-029	GAS, OIL, GREASE	PCT1 PREM UNLEADED	66249	01/12/2004	10/16/2004		473.40
GARDNER OIL, INC.	2004 021-451-029	GAS, OIL, GREASE	PCT1 KEYLOCK DIESEL	44954	01/12/2004	10/16/2004		43.89
HERCULES FENCE COMPANY	2002 021-451-028	MACHINERY MAINTEN	PCT1 REPL CON FAN &	1287	07/05/2002	/ /		217.30
NATIONWIDE RETIREMENT S	2000 021-202-100	SALARIES PAYABLE	NACO	05122000	05/12/2000	05/31/2000		25.00
STANDARD INSURANCE COMP	2000 021-202-100	SALARIES PAYABLE	STANDARD COUNTY LIF	05122000	05/12/2000	05/31/2000		13.00
TEXAS COUNTY & DISTRICT	2000 021-202-100	SALARIES PAYABLE	TCDRS-RETIREMENT	05122000	05/12/2000	05/31/2000		390.79
TEXAS COUNTY & DISTRICT	2000 021-448-003	RETIREMENT	TCDRS-RETIREMENT	05122000	05/12/2000	05/31/2000		461.68
TEXAS COUNTY & DISTRICT	2000 021-202-100	SALARIES PAYABLE	TCDRS-RETIREMENT	05122000	05/12/2000	05/31/2000		390.79
TEXAS COUNTY & DISTRICT	2000 021-448-003	RETIREMENT	TCDRS-RETIREMENT	05122000	05/12/2000	05/31/2000		461.68
TYLER COUNTY HEALTH	2000 021-448-004	HOSPITALIZATION	TYLER COUNTY HEALTH	05122000	05/12/2000	05/31/2000		875.00

 5,715.56

EXCEPT RECORDS FROM 11/16/2007 TO 11/16/2007 DATE-TO-BE-PAID

VENDOR NAME	ACCOUNT #	ACCOUNT NAME	ITER/REASON	INVOICE #	VP DATE	DATE TBP	PO NO	AMOUNT
AFLAC INSURANCE	2000 022-202-100	SALARIES PAYABLE	AFLAC INS	05122000	05/12/2000	05/31/2000		51.90
AFLAC INSURANCE	2000 022-202-100	SALARIES PAYABLE	AFLAC INS	05122000	05/12/2000	05/31/2000		51.90
PAGING NETWORK OF HOUST	2000 022-451-035	UTILITIES	011-528927	01	03/10/2000	/ /		9.03
TEXAS COUNTY & DISTRICT	2000 022-202-100	SALARIES PAYABLE	TCDRS-RETIREMENT	05122000	05/12/2000	05/31/2000		425.76
TEXAS COUNTY & DISTRICT	2000 022-448-003	RETIREMENT	TCDRS-RETIREMENT	05122000	05/12/2000	05/31/2000		503.02
TEXAS COUNTY & DISTRICT	2000 022-202-100	SALARIES PAYABLE	TCDRS-RETIREMENT	05122000	05/12/2000	05/31/2000		425.76
TEXAS COUNTY & DISTRICT	2000 022-448-003	RETIREMENT	TCDRS-RETIREMENT	05122000	05/12/2000	05/31/2000		503.02
TYLER COUNTY HEALTH	2000 022-202-100	SALARIES PAYABLE	TYLER COUNTY HEALTH	05122000	05/12/2000	05/31/2000		91.85
TYLER COUNTY HEALTH	2000 022-448-004	HOSPITALIZATION	TYLER COUNTY HEALTH	05122000	05/12/2000	05/31/2000		750.00

								2,812.24

EXCEPT RECORDS FROM 11/16/2007 TO 11/16/2007 DATE-TO-BE-PAID

VENDOR NAME	ACCOUNT #	ACCOUNT NAME	ITEM/REASON	INVOICE #	VP DATE	DATE TBP	PO NO	AMOUNT
AFLAC INSURANCE	2000 023-202-100	SALARIES PAYABLE	AFLAC INS	05122000	05/12/2000	05/31/2000		27.71
AFLAC INSURANCE	2000 023-202-100	SALARIES PAYABLE	AFLAC INS	05122000	05/12/2000	05/31/2000		27.71
DOCHES COMMUNITY CREDIT	2000 023-202-100	SALARIES PAYABLE	CREDIT UNION	05122000	05/12/2000	05/31/2000		20.00
DOCHES COMMUNITY CREDIT	2000 023-202-100	SALARIES PAYABLE	CREDIT UNION	05122000	05/12/2000	05/31/2000		20.00
HERCULES FENCE COMPANY	2003 023-453-045	PURCHASE OF EQUIP	PCT3 KENWOOD PORTA	2036	07/15/2003	/ /		380.00
P.S.I.	2000 023-451-035	UTILITIES	PCT III	007548	07/10/2000	04/14/2000		40.31
STANDARD INSURANCE COMP	2000 023-202-100	SALARIES PAYABLE	STANDARD COUNTY LIF	05122000	05/12/2000	05/31/2000		16.03
TEXAS COUNTY & DISTRICT	2000 023-202-100	SALARIES PAYABLE	TCDRS-RETIREMENT	05122000	05/12/2000	05/31/2000		413.82
TEXAS COUNTY & DISTRICT	2000 023-448-003	RETIREMENT	TCDRS-RETIREMENT	05122000	05/12/2000	05/31/2000		488.89
TEXAS COUNTY & DISTRICT	2000 023-202-100	SALARIES PAYABLE	TCDRS-RETIREMENT	05122000	05/12/2000	05/31/2000		413.82
TEXAS COUNTY & DISTRICT	2000 023-448-003	RETIREMENT	TCDRS-RETIREMENT	05122000	05/12/2000	05/31/2000		488.89
TYLER COUNTY HEALTH	2000 023-448-004	HOSPITALIZATION	TYLER COUNTY HEALTH	05122000	05/12/2000	05/31/2000		750.00
WAL-MART COMMUNITY	2001 023-451-040	MISCELLANEDUS SUP	ACCT 60322020002015	603220202015	08/23/2001	/ /		16.00

 3,103.18

EXCEPT RECORDS FROM 11/16/2007 TO 11/16/2007 DATE-TO-BE-PAID

VENDOR NAME	ACCOUNT #	ACCOUNT NAME	ITEM/REASON	INVOICE #	VP DATE	DATE TBP	PO NO	AMOUNT
CYPRESS CREEK WATER	2000 037-451-035	UTILITIES	ACCOUNT # 235	01	03/10/2000	/ /		18.96
TEXAS COUNTY & DISTRICT	2000 037-202-100	SALARIES PAYABLE	TCDRS-RETIREMENT	05122000	05/12/2000	05/31/2000		58.14
TEXAS COUNTY & DISTRICT	2000 037-448-003	RETIREMENT	TCDRS-RETIREMENT	05122000	05/12/2000	05/31/2000		68.68
TEXAS COUNTY & DISTRICT	2000 037-202-100	SALARIES PAYABLE	TCDRS-RETIREMENT	05122000	05/12/2000	05/31/2000		58.14
TEXAS COUNTY & DISTRICT	2000 037-448-003	RETIREMENT	TCDRS-RETIREMENT	05122000	05/12/2000	05/31/2000		68.68
TYLER COUNTY HEALTH	2000 037-448-004	HOSPITALIZATION	TYLER COUNTY HEALTH	05122000	05/12/2000	05/31/2000		250.00

								522.60

EXCEPT RECORDS FROM 11/16/2007 TO 11/16/2007 DATE-TO-BE-PAID

VENDOR NAME	ACCOUNT #	ACCOUNT NAME	ITEM/REASON	INVOICE #	VP DATE	DATE TBP	PO NO	AMOUNT
BROOKSHIRE BROS.	2000 049-492-005	RESTITUTION MISC.	JAHOS,WHEELER,OLIVE	5804	07/28/2000	07/28/2000		348.44
BROOKSHIRE BROS.	2006 049-492-005	RESTITUTION MISC.	JAHOS,WHEELER,OLIVE	5804	07/28/2000	07/28/2000		348.44
BROOKSHIRE BROS.	2006 049-492-005	RESTITUTION MISC.	JAHOS,WHEELER,OLIVE	5804	07/28/2000	07/28/2000		348.44
BROOKSHIRE BROS.	2006 049-492-005	RESTITUTION MISC.	JAHOS,WHEELER,OLIVE	5804	07/28/2000	07/28/2000		348.44
DOVER, BILL L	2000 049-492-005	RESTITUTION MISC.	C. FAIRCHILD	5808	07/28/2000	07/28/2000		110.00
GODWIN'S	2000 049-492-005	RESTITUTION MISC.	JAHOS,DOUGHTY,MORRI	5806	07/28/2000	07/28/2000		438.90
HARRIS COUNTRY MKT	2000 049-492-005	RESTITUTION MISC.	ARTHUR GREEN	5811	07/28/2000	07/28/2000		30.00
HILLTOP GROCERY	2000 049-492-005	RESTITUTION MISC.	J. SANCHES	5805	07/28/2000	07/28/2000		90.00
J K FOOD #2	2000 049-492-005	RESTITUTION MISC.	ANGELA SEAY	5809	07/28/2000	07/28/2000		42.75
JOC # 5	2000 049-492-005	RESTITUTION MISC.	MCNEIL,SIMMONS,BOON	5810	07/28/2000	07/28/2000		111.72
LONE STAR STOP #1	2000 049-492-005	RESTITUTION MISC.	MCGEE,HILHOUSE,WARR	5802	07/28/2000	07/28/2000		189.62
PIZZA HUT	2000 049-492-005	RESTITUTION MISC.	JOANN JAHOS	5807	07/28/2000	07/28/2000		50.97
TYLER COUNTY AUTO PARTS	2000 049-492-005	RESTITUTION MISC.	CHARLIE FAIRCHILD	5812	07/28/2000	07/28/2000		237.25
WEST MAGNOLIA DRIVE-IN	2000 049-492-005	RESTITUTION MISC.	GARDNER,PHILLIPS,FO	5803	07/28/2000	07/28/2000		325.00

 3,019.97

EXCEPT RECORDS FROM 11/16/2007 TO 11/16/2007 DATE-TO-BE-PAID

VENDOR NAME	ACCOUNT #	ACCOUNT NAME	ITEM/REASON	INVOICE #	VP DATE	DATE TBP	PO NO	AMOUNT
KY'S TREASURES	1999 050-492-005	MISCELLANEOUS	A SWEARINGEN	5272	06/16/1999	06/17/1999		151.79
TELETOUCH COMMUNICATION	2000 050-492-005	MISCELLANEOUS	RADIO	400649	07/28/2000	07/28/2000		750.00

								901.79

EXCEPT RECORDS FROM 11/16/2007 TO 11/16/2007 DATE-TO-BE-PAID

VENDOR NAME	ACCOUNT #	ACCOUNT NAME	ITER/REASON	INVOICE #	VP DATE	DATE TBP	PO NO	AMOUNT
AMERICAN EXPRESS	1999 053-451-015	TRAVEL/FURNISHED	TRAVEL	083199	08/31/1999	08/31/1999		378.67
AMERICAN EXPRESS	2007 053-451-015	TRAVEL/FURNISHED	TRAVEL	083199	08/31/1999	08/31/1999		378.67
AMERICAN EXPRESS	2007 053-451-015	TRAVEL/FURNISHED	TRAVEL	083199	08/31/1999	08/31/1999		378.67
ENVIRO-HEALTH SYSTEMS,	1999 053-451-007	SUPPLIES & OPERAT	ARTHUR THOMAS	308363	08/31/1999	08/31/1999		11.00
ENVIRO-HEALTH SYSTEMS,	1999 053-451-007	SUPPLIES & OPERAT	ARTHUR THOMAS	308523	08/31/1999	08/31/1999		38.00
MINOLTA-DIV KMBS USA	1999 053-437-007	CCP SUPPLIES & OP	COPIER	9082062175	08/31/1999	08/31/1999		121.83
MUSIC MOUNTAIN WATER CO	1999 053-451-007	SUPPLIES & OPERAT	WATER	AUGUST	08/31/1999	08/31/1999		59.00
QUILL CORPORATION	1999 053-437-007	CCP SUPPLIES & OP	SUPPLIES	3990306	08/31/1999	08/31/1999		142.17
QUILL CORPORATION	1999 053-437-007	CCP SUPPLIES & OP	SUPPLIES	3829115	08/31/1999	08/31/1999		44.53
QUILL CORPORATION	1999 053-437-007	CCP SUPPLIES & OP	SUPPLIES	3963795	08/31/1999	08/31/1999		23.96
ROGERS OFFICE SUPPLY	1999 053-451-007	SUPPLIES & OPERAT	SUPPLIES	362	08/31/1999	08/31/1999		45.14
ROGERS OFFICE SUPPLY	1999 053-451-007	SUPPLIES & OPERAT	SUPPLIES	394	08/31/1999	08/31/1999		27.80
ROGERS OFFICE SUPPLY	1999 053-451-007	SUPPLIES & OPERAT	SUPPLIES	337	08/31/1999	08/31/1999		69.96
ROGERS OFFICE SUPPLY	1999 053-451-007	SUPPLIES & OPERAT	SUPPLIES	273	08/31/1999	08/31/1999		274.00
ROGERS OFFICE SUPPLY	1999 053-451-007	SUPPLIES & OPERAT	SUPPLIES	522	08/31/1999	08/31/1999		45.27
SIMPSON, KENNY	2000 053-437-015	TRAVEL/FURNISHED	REIMB	07122000	07/28/2000	07/28/2000		154.40
TDCAA NOW TRUST FUND	2000 053-451-007	SUPPLIES & OPERAT	PLEAS,PROBATION	6277	07/28/2000	07/28/2000		45.00
TEXAS COUNTY & DISTRICT	2000 053-202-100	SALARIES PAYABLE	TCDRS-RETIREMENT	05122000	05/12/2000	05/31/2000		540.47
TEXAS COUNTY & DISTRICT	2000 053-437-003	CCP RETIREMENT	TCDRS-RETIREMENT	05122000	05/12/2000	05/31/2000		58.87
TEXAS COUNTY & DISTRICT	2000 053-451-003	RETIREMENT	TCDRS-RETIREMENT	05122000	05/12/2000	05/31/2000		579.66
TEXAS COUNTY & DISTRICT	2000 053-202-100	SALARIES PAYABLE	TCDRS-RETIREMENT	05122000	05/12/2000	05/31/2000		540.47
TEXAS COUNTY & DISTRICT	2000 053-437-003	CCP RETIREMENT	TCDRS-RETIREMENT	05122000	05/12/2000	05/31/2000		58.87
TEXAS COUNTY & DISTRICT	2000 053-451-003	RETIREMENT	TCDRS-RETIREMENT	05122000	05/12/2000	05/31/2000		579.66
TRIAD OFFICE SOLUTIONS	1999 053-437-007	CCP SUPPLIES & OP	PRINTER	00081034	08/31/1999	08/31/1999		288.00
TYLER COUNTY HEALTH	2000 053-437-004	CCP HOSPITALIZATI	TYLER COUNTY HEALTH	05122000	05/12/2000	05/31/2000		125.00
TYLER COUNTY HEALTH	2000 053-451-004	HOSPITALIZATION	TYLER COUNTY HEALTH	05122000	05/12/2000	05/31/2000		750.00
VIKING OFFICE PRODUCTS	1999 053-451-007	SUPPLIES & OPERAT	SUPPLIES	832189	08/31/1999	08/31/1999		41.94
WATTS, JAMES W P.E.	1999 053-451-016	PROFESSIONAL FEES	SOFTWARE	080999	08/31/1999	08/31/1999		348.28
WATTS, JAMES W P.E.	1999 053-451-016	PROFESSIONAL FEES	SOFTWARE	082699	08/31/1999	08/31/1999		463.33

 6,612.62

EXCEPT RECORDS FROM 11/16/2007 TO 11/16/2007 DATE-TO-BE-PAID

VENDOR NAME	ACCOUNT #	ACCOUNT NAME	ITEM/REASON	INVOICE #	VP DATE	DATE TBP	PO NO	AMOUNT
AFLAC INSURANCE	2000 054-202-100	SALARIES PAYABLE	AFLAC INS	05122000	05/12/2000	05/31/2000		23.20
AFLAC INSURANCE	2000 054-202-100	SALARIES PAYABLE	AFLAC INS	05122000	05/12/2000	05/31/2000		23.20
DOCHES COMMUNITY CREDIT	2000 054-202-100	SALARIES PAYABLE	CREDIT UNION	05122000	05/12/2000	05/31/2000		50.00
DOCHES COMMUNITY CREDIT	2000 054-202-100	SALARIES PAYABLE	CREDIT UNION	05122000	05/12/2000	05/31/2000		50.00
SHEFFIELD, TONYA	2000 054-437-007	ISP-OFFICE SUPPLI	SEXUAL ASSAULT SEM	7039A	08/11/2000	08/11/2008		75.00
SHEFFIELD, TONYA	2000 054-437-007	ISP-OFFICE SUPPLI	SEXUAL ASSAULT SEM	7039	08/11/2000	08/11/2008		75.00
TAC	1999 054-437-005	ISP WORKER'S COMP	WORKER'S COMP FUND	06/01/99	06/16/1999	99/18/1999		9.64
TAC	1999 054-451-005	WORKERS COMPENSAT	WORKER'S COMP FUND	06/01/1999	06/16/1999	99/18/1999		17.61
TEXAS COUNTY & DISTRICT	2000 054-202-100	SALARIES PAYABLE	TCDRS-RETIREMENT	05122000	05/12/2000	05/31/2000		187.22
TEXAS COUNTY & DISTRICT	2000 054-437-003	ISP RETIREMENT	TCDRS-RETIREMENT	05122000	05/12/2000	05/31/2000		76.43
TEXAS COUNTY & DISTRICT	2000 054-451-003	RETIREMENT	TCDRS-RETIREMENT	05122000	05/12/2000	05/31/2000		144.76
TEXAS COUNTY & DISTRICT	2000 054-202-100	SALARIES PAYABLE	TCDRS-RETIREMENT	05122000	05/12/2000	05/31/2000		187.22
TEXAS COUNTY & DISTRICT	2000 054-437-003	ISP RETIREMENT	TCDRS-RETIREMENT	05122000	05/12/2000	05/31/2000		76.43
TEXAS COUNTY & DISTRICT	2000 054-451-003	RETIREMENT	TCDRS-RETIREMENT	05122000	05/12/2000	05/31/2000		144.76
TYLER COUNTY HEALTH	2000 054-437-004	ISP HOSPITALIZATI	TYLER COUNTY HEALTH	05122000	05/12/2000	05/31/2000		125.00
TYLER COUNTY HEALTH	2000 054-451-004	HOSPITALIZATION	TYLER COUNTY HEALTH	05122000	05/12/2000	05/31/2000		250.00
VIKING OFFICE PRODUCTS	1999 054-451-007	OFFICE SUPPLIES	OFFICE SUPPLIES	878405	08/31/1999	08/31/1999		109.19
WILSON INSURANCE	2000 054-437-007	ISP-OFFICE SUPPLI	18278935	JUVENILE PRO	07/28/2000	07/28/2000		52.50

 1,677.16

EXCEPT RECORDS FROM 11/16/2007 TO 11/16/2007 DATE-TO-BE-PAID

VENDOR NAME	ACCOUNT #	ACCOUNT NAME	ITEM/REASON	INVOICE #	VP DATE	DATE TBP	PO NO	AMOUNT
STATE COMPTROLLER-EFT	2006 056-492-083	PAYMENTS TO STATE	CRIMINAL COST FEES	103006D	11/01/2006	10/31/2006		58.50
STATE COMPTROLLER-EFT	2007 056-492-083	PAYMENTS TO STATE	STATECRIMINALCOST&F	07312007L	07/30/2007	07/30/2007		103.50

								162.00

EXCEPT RECORDS FROM 11/16/2007 TO 11/16/2007 DATE-TO-BE-PAID

VENDOR NAME	ACCOUNT #	ACCOUNT NAME	ITEM/REASON	INVOICE #	VP DATE	DATE TBP	PO NO	AMOUNT
STATE COMPTROLLER-EFT	2006 060-492-083	PAYMENTS TO THE S	CRIMINAL COST FEES	1030068	11/01/2006	10/31/2006		67.50
STATE COMPTROLLER-EFT	2007 060-492-083	PAYMENTS TO THE S	STATECRIMINALCOST&F	073120070	07/30/2007	07/30/2007		759.60

								827.10

EXCEPT RECORDS FROM 11/16/2007 TO 11/16/2007 DATE-TO-BE-PAID

VENDOR NAME	ACCOUNT #	ACCOUNT NAME	ITEM/REASON	INVOICE #	VP DATE	DATE TBP	PO NO	AMOUNT
STATE COMPTROLLER-EFT	2006 064-492-083	PAYMENTS TO STATE CRIMINAL COST FEES		103006J	11/01/2006	10/31/2006		1.80
STATE COMPTROLLER-EFT	2007 064-492-083	PAYMENTS TO STATE STATECRIMINALCOST&F		07312007R	07/30/2007	07/30/2007		1.35

								3.15

EXCEPT RECORDS FROM 11/16/2007 TO 11/16/2007 DATE-TO-BE-PAID

VENDOR NAME	ACCOUNT #	ACCOUNT NAME	ITER/REASON	INVOICE #	VP DATE	DATE TBP	PO NO	AMOUNT
STATE COMPTROLLER-EFT	2006 067-492-083	PAYMENTS TO STATE CRIMINAL COST FEES		103006U	11/01/2006	10/31/2006		1,296.66
STATE COMPTROLLER-EFT	2007 067-492-083	PAYMENTS TO STATE STATECRIMINALCOST&F		07312007CC	07/30/2007	07/30/2007		180.00

								1,476.66

EXCEPT RECORDS FROM 11/16/2007 TO 11/16/2007 DATE-TO-BE-PAID

VENDOR NAME	ACCOUNT #	ACCOUNT NAME	ITEM/REASON	INVOICE #	VP DATE	DATE TBP	PO NO	AMOUNT
STATE COMPTROLLER-EFT	2006 086-492-083	PAYMENTS TO STATE CRIMINAL COST FEES		1030065	11/01/2006	10/31/2006		1,123.20
STATE COMPTROLLER-EFT	2007 086-492-083	PAYMENTS TO STATE STATECRIMINALCOST&F		073120072	07/30/2007	07/30/2007		190.80
								----- 1,314.00
			TOTAL VOUCHERS					179,931.04

LINE ITEM TRANSFER-BUDGET AMENDMENT

Department & Fund: Commissioners Court Appropriations/General Fund

Date: December 14, 2007

Honorable Commissioners' Court of Tyler County:

I submit to you for consideration the following:

<u>Line Item</u>	<u>Budget</u>	<u>Amended</u>	<u>Increase (Decrease)</u>	<u>Additional Revenue</u>
Probation Telephone	\$ 2,000.00	\$ 2,300.00	\$ 300.00	
Advertising	2,000.00	9,000.00	7,000.00	
DETCOG Travel	1,000.00	1,200.00	200.00	
Independent Audit	15,000.00	16,000.00	1,000.00	
Tyler County Appraisal	163,597.00	184,378.00	20,781.00	
Allan Shivers Library	89,000.00	89,469.00	469.00	
Piney Woods Econ. Dev.	500.00	1,250.00	750.00	
Autopsies	15,000.00	20,500.00	5,500.00	
Election Expense	17,000.00	23,000.00	6,000.00	
Juvenile Detention	1,800.00	0.00	(1,800.00)	
Highway Coalition	5,415.00	0.00	(5,415.00)	
Liability Insurance	17,095.00	13,753.00	(3,342.00)	
COLA Retirement Exp.	15,000.00	0.00	(15,000.00)	
Cont. for Legal	20,000.00	4,500.00	(15,500.00)	
Postage for Postage Mtr.	38,000.00	44,000.00	6,000.00	
Cont. - Hospitalization	<u>30,000.00</u>	<u>23,057.00</u>	<u>(6,943.00)</u>	

Reason: Invalid assumptions underlying budget estimates of receipts and disbursements.

Approved Commissioners Court

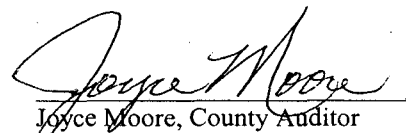
Joyce Moore, County Auditor

Attest County Clerk

LINE ITEM TRANSFER-BUDGET AMENDMENT

Department & Fund: County Clerk/General

Date: December 14, 2007

Honorable Commissioners' Court of Tyler County:

I submit to you for consideration the following:

<u>Line Item</u>	<u>Budget</u>	<u>Amended</u>	<u>Increase (Decrease)</u>	<u>Additional Revenue</u>
Bonds, Insurance	\$3,400.00	\$ 5,411.00	\$ 2,011.00	
Book Binding	2,450.00	439.00	(2,011.00)	
Office Supplies	5,000.00	6,500.00	1,500.00	
Purchase of Equipment	<u>3,700.00</u>	<u>2,200.00</u>	<u>(1,500.00)</u>	

Reason: Invalid assumptions underlying budget estimates of receipts and disbursements.

Approved Commissioners Court

Donée Gregory, County Clerk

Attest County Clerk

LINE ITEM TRANSFER-BUDGET AMENDMENT

Department & Fund: Veteran's Service

Date: December 14, 2007

Honorable Commissioners' Court of Tyler County:

I submit to you for consideration the following:

<u>Line Item</u>	<u>Budget</u>	<u>Amended</u>	<u>Increase (Decrease)</u>	<u>Additional Revenue</u>
Telephone	\$2,750.00	\$ 3,000.00	\$ 250.00	
Office Supplies	850.00	1,212.00	362.00	
Training & Education	<u>1,250.00</u>	<u>638.00</u>	<u>(612.00)</u>	

Reason: Invalid assumptions underlying budget estimates of receipts and disbursements.

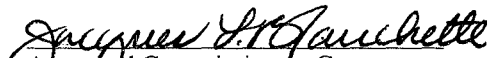
Approved Commissioners Court

Ellen Craig, Veteran Service Officer

Attest County Clerk

LINE ITEM TRANSFER-BUDGET AMENDMENT

Department & Fund: District Clerk & Jury Account/General Fund

Date: December 14, 2007

Honorable Commissioners' Court of Tyler County:

I submit to you for consideration the following:

<u>Line Item</u>	<u>Budget</u>	<u>Amended</u>	<u>Increase (Decrease)</u>	<u>Additional Revenue</u>
<u>District Clerk</u>				
Bonds & Insurance	\$ 2,412.00	\$ 2,972.00	\$ 560.00	
Training & Education	2,500.00	500.00	(2,000.00)	
<u>Jury Account</u>				
Court Appt'd Attorneys	65,000.00	86,524.00	21,524.00	
Grand Jury Commission	100.00	150.00	50.00	
Petit Jurors	28,800.00	16,350.00	(12,450.00)	
Grand Jurors	5,750.00	4,755.00	(995.00)	
Transcripts	5,500.00	851.00	(4,649.00)	
Food & Lodging/Jurors	1,000.00	70.00	(930.00)	
Miscellaneous Jury Exp.	300.00	0.00	(300.00)	
Psychiatric & Medical	<u>2,000.00</u>	<u>1,190.00</u>	<u>(810.00)</u>	

Reason: Invalid assumptions underlying budget estimates of receipts and disbursements.

Approved Commissioners Court

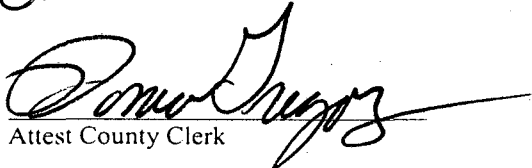
Attest County Clerk

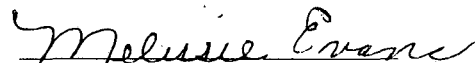
Melissie Evans, District Clerk

LINE ITEM TRANSFER-BUDGET AMENDMENT

Department & Fund: Justice of Peace, Pct. 4/General

Date: December 14, 2007

Honorable Commissioners' Court of Tyler County:

I submit to you for consideration the following:

<u>Line Item</u>	<u>Budget</u>	<u>Amended</u>	<u>Increase (Decrease)</u>	<u>Additional Revenue</u>
Telephone	\$ 700.00	\$ 1,400.00	\$ 700.00	
Training & Education	1,700.00	1,775.00	75.00	
Office Supplies	1,600.00	1,200.00	(400.00)	
Postage	<u>400.00</u>	<u>100.00</u>	<u>(300.00)</u>	

Reason: Invalid assumptions underlying budget estimates of receipts and disbursements.

Approved Commissioners Court

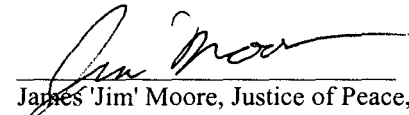
James 'Jim' Moore, Justice of Peace, Pct. 4

Attest County Clerk

LINE ITEM TRANSFER-BUDGET AMENDMENT

Department & Fund: County Court/General

Date: December 14, 2007

Honorable Commissioners' Court of Tyler County:

I submit to you for consideration the following:

<u>Line Item</u>	<u>Budget</u>	<u>Amended</u>	<u>Increase (Decrease)</u>	<u>Additional Revenue</u>
Court Reporter	\$4,500.00	\$ 6,500.00	\$ 2,000.00	
Court App't'd Attorneys	9,250.00	14,555.00	5,305.00	
Petit Jurors	6,500.00	1,500.00	(5,000.00)	
Commitments	<u>9,000.00</u>	<u>6,695.00</u>	<u>(2,305.00)</u>	

Reason: Invalid assumptions underlying budget estimates of receipts and disbursements.

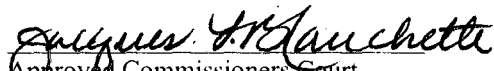
Approved Commissioners Court

Jacques Blanchette, County Judge

Attest County Clerk

LINE ITEM TRANSFER-BUDGET AMENDMENT

Department & Fund: Criminal District Attorney/General

Date: December 14, 2007

Honorable Commissioners' Court of Tyler County:

I submit to you for consideration the following:

<u>Line Item</u>	<u>Budget</u>	<u>Amended</u>	<u>Increase (Decrease)</u>	<u>Additional Revenue</u>
Office Supplies	\$3,500.00	\$ 5,100.00	\$ 1,600.00	
Witness Expense	<u>5,000.00</u>	<u>3,400.00</u>	<u>(1,600.00)</u>	

Reason: Invalid assumptions underlying budget estimates of receipts and disbursements.

Approved Commissioners Court

Joe Smith, Criminal District Attorney

Attest County Clerk

Dec 13 07 06:30p

Tyler County

4092836305

p. 3

LINE ITEM TRANSFER-BUDGET AMENDMENT

Department & Fund: Sheriff Department/General Fund

Date: December 14, 2007

Honorable Commissioners' Court of Tyler County:

I submit to you for consideration the following:

<u>Line Item</u>	<u>Budget</u>	<u>Amended</u>	<u>Increase (Decrease)</u>	<u>Additional Revenue</u>
Salaries	\$623,784.00	\$663,784.00	\$ 40,000.00	
Social Security	47,745.00	50,980.00	3,235.00	
Retirement	51,611.00	54,711.00	3,100.00	
Hospitalization	129,080.00	117,874.00	(11,206.00)	
Workers Comp	18,382.00	19,583.00	1,201.00	
Unemployment	1,845.00	2,120.00	275.00	
Vacation, Sick Pay, Relief	6,405.00	0.00	(6,405.00)	
Overtime	2,800.00	0.00	(2,800.00)	
Drug Task Force	13,900.00	0.00	(13,900.00)	
Park Security Services	10,000.00	0.00	(10,000.00)	
U. S. Marshall Transport	<u>20,000.00</u>	<u>16,500.00</u>	<u>(3,500.00)</u>	

Reason: Invalid assumptions underlying budget estimates of receipts and disbursements.

James H. Marchetti
Approved Commissioners Court

Jessie Wolf
Jessie Wolf, Tyler County Sheriff

[Signature]
Attest County Clerk

07 06:30p

Tyler County

4092836305

p. 4

LINE ITEM TRANSFER-BUDGET AMENDMENT

Department & Fund: Sheriff Department/General Fund

Date: December 14, 2007

Honorable Commissioners' Court of Tyler County:

I submit to you for consideration the following:

<u>Line Item</u>	<u>Budget</u>	<u>Amended</u>	<u>Increase (Decrease)</u>	<u>Additional Revenue</u>
Office Supplies	\$ 5,000.00	\$ 7,500.00	\$ 2,500.00	
Telephone	13,500.00	14,405.00	905.00	
Deputies Supplies	5,500.00	13,750.00	8,250.00	
Bonds. Law Enf. Liab.	500.00	600.00	100.00	
Tires & Tubes	6,500.00	9,150.00	2,650.00	
Liability Insurance	11,000.00	17,550.00	6,550.00	
Uniforms	4,500.00	8,095.00	3,595.00	
Employee Physicals	350.00	450.00	100.00	
U. S. Marshall Transport	16,500.00	5,500.00	(11,000.00)	
Repairs to Vehicles	17,500.00	10,000.00	(7,500.00)	
Gas, Oil, & Grease	80,000.00	78,950.00	(1,050.00)	
Lease Equipment	1,500.00	0.00	(1,500.00)	
Animal Control	1,500.00	0.00	(1,500.00)	
Travel & Education	2,100.00	0.00	(2,100.00)	

Reason: Invalid assumptions underlying budget estimates of receipts and disbursements.

Jacqueline Stanchette
Approved Commissioners Court

Drew Stinson
Attest County Clerk

Jessie Wolf
Jessie Wolf, Tyler County Sheriff

Dec 13 07 06:30p

Tyler County

4092836305

p. 2

LINE ITEM TRANSFER-BUDGET AMENDMENT

Department & Fund: Jail/General Fund

Date: December 14, 2007

Honorable Commissioners' Court of Tyler County:

I submit to you for consideration the following:

<u>Line Item</u>	<u>Budget</u>	<u>Amended</u>	<u>Increase (Decrease)</u>	<u>Additional Revenue</u>
Prisoner Meals	\$ 42,500.00	\$ 52,400.00	\$ 9,900.00	
Vacation, Sick Pay, Relief	3,300.00	0.00	(3,300.00)	
Overtime	1,200.00	0.00	(1,200.00)	
Jail Supplies	19,000.00	18,000.00	(1,000.00)	
Camera & Film	1,500.00	0.00	(1,500.00)	
Prisoner Medical	10,000.00	7,400.00	(2,600.00)	
Uniforms	<u>2,000.00</u>	<u>1,700.00</u>	(300.00)	

Reason: Invalid assumptions underlying budget estimates of receipts and disbursements.

Jacqueline W. Blanchette
 Approved Commissioners Court

Jessie Wolf
 Jessie Wolf, Tyler County Sheriff

Dana Suggs
 Attest County Clerk

LINE ITEM TRANSFER-BUDGET AMENDMENT

Department & Fund: Building Maintenance & Commissioners Court Appropriations/General Fund

Date: December 14, 2007

Honorable Commissioners' Court of Tyler County:

I submit to you for consideration the following:

<u>Line Item</u>	<u>Budget</u>	<u>Amended</u>	<u>Increase (Decrease)</u>	<u>Additional Revenue</u>
Contingency for Misc.	\$ 497,400.00	\$457,325.00	\$(40,075.00)	
Repairs to Nutrition Ctr.	2,500.00	5,000.00	2,500.00	
Repairs to Justice Center	20,000.00	25,500.00	5,500.00	
Wheat Bldg. Lease/Taxes	6,600.00	6,975.00	375.00	
Utilities - Tax Office 1	8,600.00	9,600.00	1,000.00	
Utilities - Nutrition Ctr.	9,000.00	13,200.00	4,200.00	
Utilities - Courthouse	26,000.00	29,500.00	3,500.00	
Utilities - Justice Center	<u>65,000.00</u>	<u>88,000.00</u>	<u>23,000.00</u>	

Reason: Invalid assumptions underlying budget estimates of receipts and disbursements.

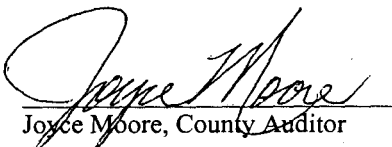
Joyce Moore, County Auditor

Approved Commissioners Court

Attest County Clerk

LINE ITEM TRANSFER-BUDGET AMENDMENT

Department & Fund: Road & Bridge, Pct. 1

Date: December 14, 2007

Honorable Commissioners' Court of Tyler County:

I submit to you for consideration the following:

Line Item	Budget	Amended	Increase (Decrease)	Additional Revenue
Beginning Balance	\$(224,452.00)	\$(167,612.00)	\$ 56,840.00	
Road Material	112,000.00	68,115.00	(43,885.00)	
Purchase of Equipment	147,151.00	133,338.00	(13,813.00)	
Machinery Maintenance	46,000.00	48,930.00	2,930.00	
Gas, Oil, & Grease	50,000.00	46,856.00	(3,144.00)	
Tires & Tubes	5,000.00	7,439.00	2,439.00	
Culverts	10,000.00	9,382.00	(618.00)	
Bridge Repair	4,921.00	2,018.00	(2,903.00)	
Salaries	189,348.00	193,148.00	3,800.00	
Social Security	14,486.00	14,736.00	250.00	
Retirement	15,641.00	16,276.00	635.00	
Workers Compensation	11,340.00	10,163.00	(1,177.00)	
Utilities	2,900.00	2,740.00	(160.00)	
Bonds	240.00	0.00	(240.00)	
Miscellaneous Supplies	2,500.00	2,305.00	(195.00)	
Association Dues	200.00	0.00	(200.00)	
Liability Insurance	<u>4,500.00</u>	<u>3,941.00</u>	<u>(559.00)</u>	

-0-

Reason: Invalid assumptions underlying budget estimates of receipts and disbursements.

Jacqueline J. Gauchette
Approved Commissioners Court

Martin Nash
Martin Nash, Commissioner, Pct. 1

Donna Suggs
Attest County Clerk

LINE ITEM TRANSFER-BUDGET AMENDMENT

Department & Fund: Emergency Operations Center

Date: December 14, 2007

Honorable Commissioners' Court of Tyler County:

I submit to you for consideration the following:

<u>Line Item</u>	<u>Budget</u>	<u>Amended</u>	<u>Increase (Decrease)</u>	<u>Additional Revenue</u>
Telephone	\$2,750.00	\$ 3,050.00	\$ 300.00	
Office Supplies	1,750.00	1,800.00	50.00	
Training & Education	<u>350.00</u>	<u>0.00</u>	<u>(350.00)</u>	

Reason: Invalid assumptions underlying budget estimates of receipts and disbursements.

James Blanchette
Approved Commissioners Court

Paul Dwyer
Attest County Clerk

John Paul Feeley by
John Paul Feeley, Emergency Mgmt. Coord.
Maryland Fawcett

TYLER COUNTY TREASURER'S REPORT

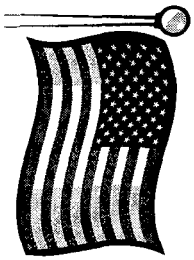

October 2007

First National Bank Now Account
Interest Rate 5.034%
(Per Depository Contract Agreement)
***This rate became available October 31, 2007.**

Sharon Fuller, County Treasurer
Woodville, Texas
Tyler County

Treasurer's Monthly Report

DATE	FUND NAME	BEGINNING BALANCE	RECEIPTS	DISBURSEMENTS	FUNDS BALANCE
October 2007	10 GENERAL FUND	\$ 3,729,961.59	\$ 222,032.13	\$ 319,102.85	\$ 3,632,890.87
	11 AD VALOREM	\$ 1,128.29	\$ 5.01	\$ -	\$ 1,133.30
	15 U.S. Marshall Transportation	\$ 7,375.81	\$ 1,479.45	\$ -	\$ 8,855.26
	20 GENERAL R&B	\$ 28,045.21	\$ 47,890.34	\$ 22,399.81	\$ 53,535.74
	21 R&B I	\$ 75,112.25	\$ 9,360.54	\$ 37,629.15	\$ 46,843.64
	22 R&B II	\$ 144,071.09	\$ 16,036.06	\$ 24,954.14	\$ 135,153.01
	23 R&B III	\$ 538,397.16	\$ 13,461.45	\$ 27,017.82	\$ 524,840.79
	24 R&B IV	\$ 391,801.97	\$ 13,572.54	\$ 30,005.59	\$ 375,368.92
	25 AIRPORT	\$ 36,920.35	\$ 874.32	\$ 2,434.01	\$ 35,360.66
	26 RODEO ARENA	\$ 3,048.20	\$ 1,643.54	\$ 414.58	\$ 4,277.16
	27 TDHCA OWNER OCCUPIED HOME GRANT	\$ -	\$ 43,530.48	\$ 43,548.70	\$ (18.22)
	28 ECONOMIC DEVELOPMENT	\$ 27,607.99	\$ 122.87	\$ -	\$ 27,730.86
	29 BENEVOLENCE FUND	\$ 52.93	\$ 10.22	\$ 85.00	\$ (21.85)
	30 DIST. CLERK APPROPRIATION	\$ 45,764.23	\$ 203.70	\$ -	\$ 45,967.93
	31 CO. CLERK RMP	\$ 191,741.62	\$ 7,045.52	\$ 2,062.34	\$ 196,724.80
	32 CDA FORFEITURE	\$ 13,576.28	\$ 60.43	\$ 320.26	\$ 13,316.45
	33 SHERIFF FORFEITURE	\$ 37,349.19	\$ 166.25	\$ 1,272.69	\$ 36,242.75
	34 DISTRICT CLERK RPM	\$ 8,026.74	\$ 175.72	\$ -	\$ 8,202.46
	35 ARE YOU OK? GRANT	\$ 3,016.05	\$ 13.40	\$ -	\$ 3,029.45
	36 LIBRARY	\$ 7,779.68	\$ 601.62	\$ 1,176.88	\$ 7,204.42
	37 T C COLLECTION SITE	\$ 19,489.01	\$ 9,671.72	\$ 7,593.27	\$ 21,567.46
	38 VAWSP	\$ -	\$ 4,976.31	\$ -	\$ 4,976.31
	39 TXCDBG SMALL BUSINESS LOAN	\$ -	\$ 557.50	\$ 557.50	\$ -
	40 TXCDBG WATER IMPROVEMENTS GRANT	\$ -	\$ -	\$ -	\$ -
	41 PEACE OFFICER SERVICE FEES	\$ 7,651.62	\$ 34.05	\$ -	\$ 7,685.67
	42 HELP AMERICA VOTE ACT GRANT	\$ (163,695.93)	\$ -	\$ -	\$ (163,695.93)
	43 JAIL I&S	\$ 41,215.06	\$ 373.84	\$ 3,400.00	\$ 38,188.90
	44 COURTHOUSE SECURITY	\$ 79,795.34	\$ 1,780.19	\$ 2,693.92	\$ 78,881.61
	45 COUNTY RMP	\$ 54,867.12	\$ 384.22	\$ -	\$ 55,251.34
	46 CRIME STOPPERS	\$ 44.66	\$ 0.19	\$ 38.70	\$ 6.15
	47 COUNTY WIDE ROW	\$ 5,757.39	\$ 25.61	\$ -	\$ 5,783.00
	48 RITA DISASTER RELIEF FUND	\$ 510,964.50	\$ 2,274.50	\$ 36,664.35	\$ 476,574.65
	49 CDA TRUST	\$ 24,617.16	\$ -	\$ 23,572.61	\$ 1,044.55
	50 CDA HOT CHECK FEES	\$ 33,469.66	\$ -	\$ 1,404.63	\$ 32,065.03
	51 CDA STATE APPROPRIATIONS	\$ 34,533.47	\$ 153.70	\$ -	\$ 34,687.17

Treasurer's Monthly Report Continued

DATE

October

2007

NAME	BEGINNING BALANCE	RECEIPTS	DISBURSEMENTS	FUNDS BALANCE
52 ALTERNATE DISPUTE RESOLUTION	\$ 806.47	\$ 438.56	\$ 806.47	\$ 438.56
53 ADULT PROBATION	\$ 171,287.03	\$ 16,562.32	\$ 25,228.83	\$ 162,620.52
54 JUVENILE PROBATION	\$ (8,917.67)	\$ 37,886.21	\$ 25,784.91	\$ 3,183.63
55 STATE COSTS-CJP	\$ 6.04	\$ -	\$ -	\$ 6.04
56 JUDICIAL EDUCATION	\$ 103.54	\$ 13.45	\$ 80.10	\$ 36.89
57 STATE LEOCE	\$ 0.40	\$ -	\$ -	\$ 0.40
58 JUVENILE DIVERSION	\$ -	\$ -	\$ -	\$ -
59 STATE CVC	\$ 1,940.81	\$ 258.61	\$ 1,535.70	\$ 663.72
60 STATE OCLF	\$ 967.30	\$ 296.14	\$ 770.52	\$ 492.92
61 DPS ARREST FEES	\$ 3,639.00	\$ 671.17	\$ 394.84	\$ 3,915.33
62 STATE CR	\$ 0.50	\$ -	\$ -	\$ 0.50
63 STATE GR	\$ 0.50	\$ -	\$ -	\$ 0.50
64 STATE LEMI	\$ 0.15	\$ -	\$ -	\$ 0.15
65 STATE BAT	\$ -	\$ -	\$ -	\$ -
66 STATE-LEOA	\$ 0.35	\$ -	\$ -	\$ 0.35
67 STATE TLFTA	\$ 364.72	\$ 151.61	\$ 278.00	\$ 238.33
68 TIME PAYMENT	\$ 2,343.05	\$ 320.42	\$ 825.50	\$ 1,837.97
69 FUGITIVE APPR.	\$ 249.68	\$ 51.10	\$ 193.50	\$ 107.28
70 CON. COURT COSTS	\$ 19,402.90	\$ 5,096.85	\$ 15,407.10	\$ 9,092.65
71 JUV. DELIQUENT-CRIME	\$ 34.31	\$ 4.89	\$ 19.57	\$ 19.63
72 TYLER CO. SEARCH & RESCUE	\$ 186.25	\$ 0.82	\$ -	\$ 187.07
73 JUSTICE COURT TECHNOLOGY	\$ 30,666.81	\$ 628.50	\$ -	\$ 31,295.31
74 HOMELAND SECURITY	\$ 19,106.59	\$ 85.02	\$ -	\$ 19,191.61
75 CMIT	\$ 264.64	\$ 94.16	\$ 212.85	\$ 145.95
76 EMERGENCY OPERATIONS CENTER	\$ 7,961.88	\$ 35.41	\$ 2,147.46	\$ 5,849.83
77 STATE TERTIARY CARE	\$ 16,434.28	\$ 756.15	\$ -	\$ 17,190.43
78 STATE TRAFFIC FEE	\$ 8,368.17	\$ 3,224.22	\$ 7,376.59	\$ 4,215.80
79 STATE BAIL BOND FEE	\$ 3,137.71	\$ 568.93	\$ 2,470.50	\$ 1,236.14
80 STATE EMS TRAUMA FUND	\$ 1,820.20	\$ 170.07	\$ 1,530.00	\$ 460.27
81 STATE SEXUAL ASSAULT PROGRAM	\$ -	\$ -	\$ -	\$ -
82 STATE SUBSTANCE ABUSE FELONY	\$ -	\$ -	\$ -	\$ -
83 STATE DNA TESTING FEE	\$ 60.88	\$ 0.25	\$ 47.70	\$ 13.43
84 STATE CHILD ABUSE PREVENTION	\$ -	\$ -	\$ -	\$ -
85 STATE JUDICIAL SUPPORT FEES	\$ 1,128.58	\$ 1,041.01	\$ 3,487.00	\$ (1,317.41)
86 JURY REIMBURSEMNT FEE	\$ 371.57	\$ 93.64	\$ 309.60	\$ 155.61
88 TJPC - TITLE IV E FUND	\$ 50,474.10	\$ 9,499.80	\$ 0.81	\$ 59,973.09
GRAND TOTALS	\$ 6,271,696.43	\$ 476,466.73	\$ 677,256.35	\$ 6,070,906.81

WITNESS OUR HANDS, officially, this 16 day of November A.D., 2007

Jacques L. Blanchette, County Judge
Tyler County, Texas

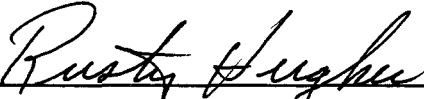

Martin F. Nash, Pct. I Commissioner
Tyler County, Texas

James T. "Rusty" Hughes, Pct. II Commissioner
Tyler County, Texas

Joe Marshall, Pct. III Commissioner
Tyler County, Texas

Julius A. Walston, Pct. IV Commissioner
Tyler County, Texas

SWORN AND SUBSCRIBED before me by, Hon. Jacques L. Blanchette, County Judge, Hon. Martin F. Nash, Commissioner Pct. I, Hon. James T. "Rusty" Hughes, Commissioner Pct. II, Hon. Joe Marshall, Commissioner Pct. III, Hon. Julius A. Walston, Commissioner Pct. IV, County Commissioners' Court of Tyler County, Woodville, Texas each and Respectively, on the 16 day of November, A.D., 2007

Donece Gregory
County Clerk, Tyler County

PERMIT FOR GAS PIPELINE BENEATH COUNTY ROAD RIGHTS-OF-WAY

I.

Springfield Pipeline Company, LLC, ("Springfield") whose principal business address is 1201 Lake Robbins Drive, The Woodlands, Texas 77380, does hereby apply for a permit as hereinafter provided to utilize and cross beneath Tyler County Road 4400 ("CR 4400"), collectively referred to as "county road".

II.

Springfield is a natural gas utility under the Texas Utilities Code § 121.000, *et seq* and is a gatherer, transporter and purchaser of natural gas produced by various wells, including but not limited to the Anadarko Petroleum Well, in Jasper County, Texas situated in the A. Issacs Survey, Abstract No. 316.

III.

Springfield will construct, operate and maintain a pipeline, not greater than twelve inches (12") in diameter, to transport natural gas produced from the Anadarko well. Said pipeline will cross CR 4400, seven tenths (0.7) of a mile, west state hwy. 92.

IV.

Springfield will construct, operate and maintain the pipeline in a good and workman-like manner, in compliance with ordinary care in the pipeline industry and in accordance with applicable laws and regulations.

V.

Springfield will construct the pipeline using ordinary care across the rights-of-way for CR 4400 to a depth of up to ten feet (10'), but not less than six feet (6') below the crest of the county

road. Springfield will restore the surface of the county road to the same or better condition than its current condition.

VI.

Springfield hereby indemnifies and agrees to hold Tyler County and its officials harmless from any and all claims for personal injury (including death), damage to equipment, supplies or personal property or other claims which arise from Springfield's negligent use of the CR 4400 rights-of-way.

VII.

It is agreed that for the consideration stated in this permit, including indemnifying Tyler County and burying the pipeline up to ten feet, but not less than six feet below the crest of CR 4400, Springfield shall not be required by Tyler County, the Commissioners' Court of Tyler County or the Tyler County Judge to remove the pipeline crossing CR 4400. However, Springfield shall be required to relocate said pipeline only if doing so becomes necessary due to a bona fide public emergency. The relocation shall be within Springfield's thirty-foot rights-of-way beneath CR 4400. Tyler County, the Commissioners' Court of Tyler County and/or the Tyler County Judge shall not require Springfield to relocate the pipeline except for public emergencies, including, but not limited to allowing widening or other changing of any traffic lane. Springfield will remove and relocate the gathering line at its sole cost and expense upon ninety (90) days written notification by Tyler County.

VIII.

Tyler County makes no warranty of title or representation of its right to use the rights-of-way for CR 4400.

IX.

Springfield and the Commissioners' Court of Tyler County, Texas agree that use of the right-of-way shall be limited to the purpose stated herein. By execution hereof in the space provided below, Springfield hereby applies for the permit as stated herein and Tyler County, Texas does hereby grant a permit to Springfield for use of its rights-of-way for CR 4400.

X.

Springfield is required to pay a \$200.00 Administration Fee to Tyler County Commissioners' Precinct where line will be located. Payment is due prior to time of approval by Tyler County Commissioners' Court. Payment may be made payable by check, cashiers check, or money order.

Dated this 16 day of NOV, 2007.

**HONORABLE TYLER COUNTY JUDGE
OR COMMISSIONERS' COURT OF
TYLER COUNTY, TEXAS**

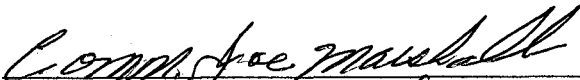
By: 
Printed Name: JOE MARSHALL
Authorized representative of Tyler County, Texas

SPRINGFIELD PIPELINE COMPANY, LLC

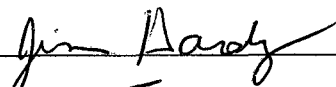
By: 
Printed Name: Jim Hardy
Authorized Representative of Springfield Pipeline Company, LLC

WESLEY W. HANKS
ABSTRACT 348

TOWN BLUFF LAKE LOTS
(SECTION 1)

TOWN BLUFF LAKE LOTS
(SECTION 1)

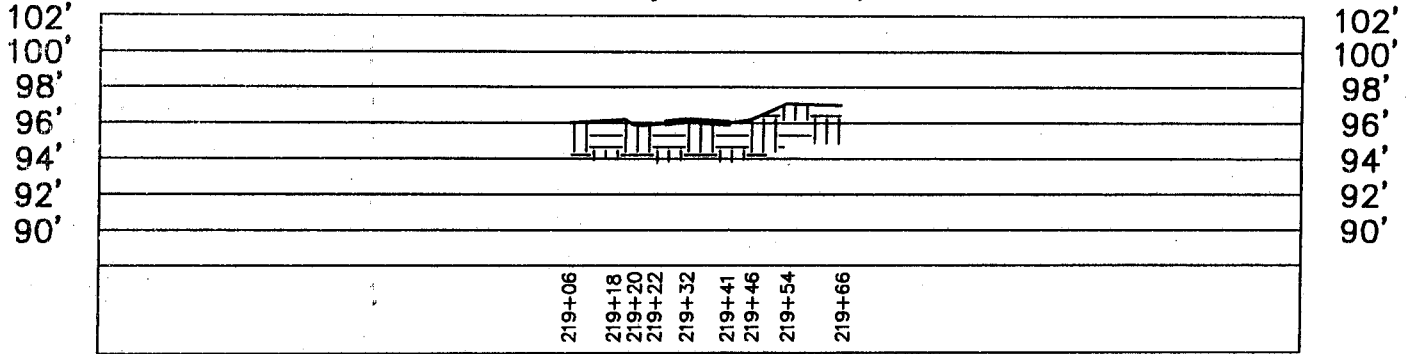
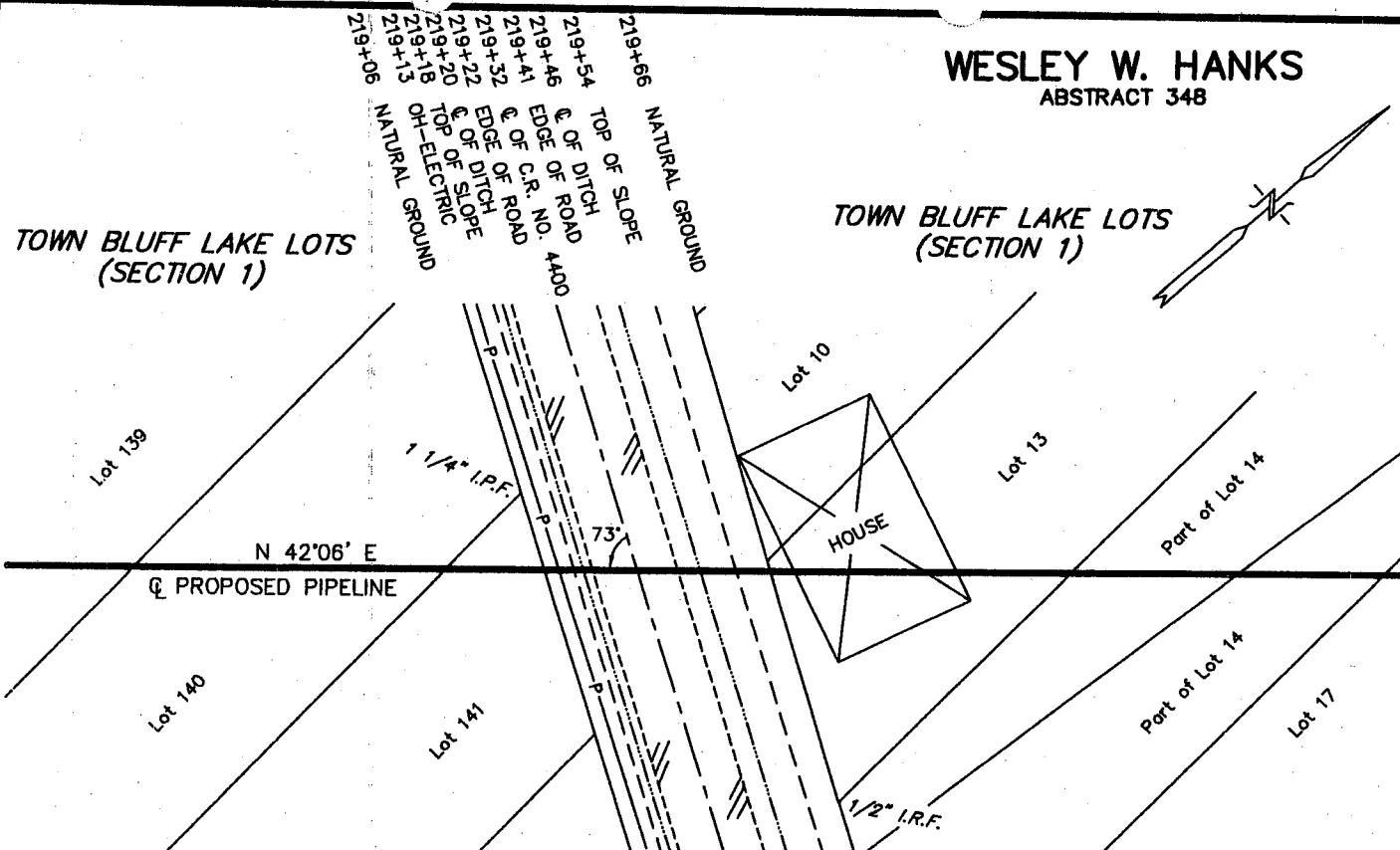

Profile

Scale: 1" = 40' Horiz.
1" = 10' Vert.

**ELEVATION VIEW
OF PROPOSED PIPELINE
CROSSING COUNTY RD. NO. 4400**

- PIPE SPECIFICATIONS
1. Contents:
 2. Carrier Pipe:
 3. Crossing Method:
 4. M.A.O.P.:

WALKER & ASSOCIATES SURVEYING, INC.
TYLER, TEXAS PH: 903-534-9000

SPRINGFIELD PIPELINE, LLC

PROPOSED PIPELINE ACROSS COUNTY RD. NO. 4400
LOCATED 0.7 MILES WEST OF F.M. HWY. NO. 92
WESLEY W. HANKS SURVEY, ABSTRACT 348
TYLER COUNTY, TEXAS

Scale: 1" = 40' Drawn by: R.A.W. Date: 09/27/06

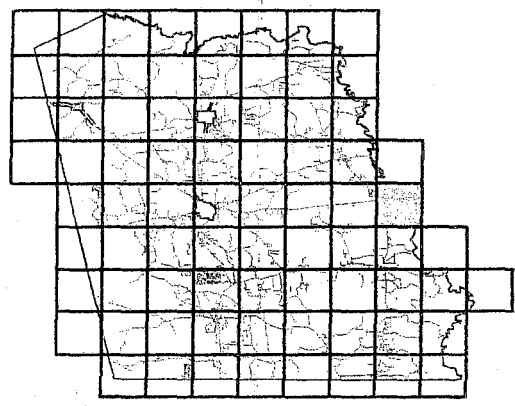
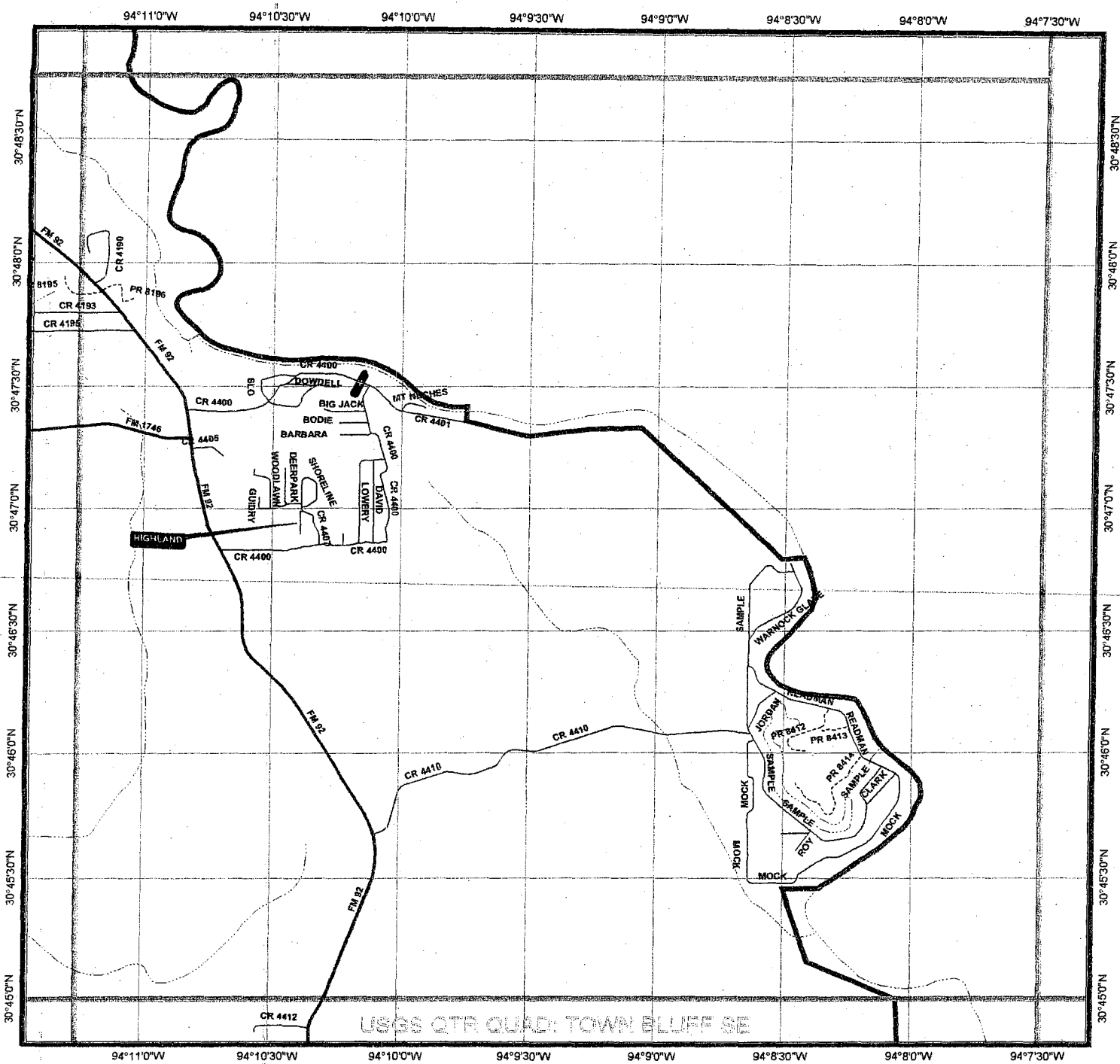

29	30	31	32	33	
37	38	39	40		
45	46	47	48	49	50



TYLER COUNTY

Print Date: August 2003

41

CERTIFICATE OF INSURANCE

ISSUE DATE November 1, 2007

PRODUCER

Alliant Insurance Services Houston LLC
 5847 San Felipe, Suite 2750
 Houston, TX 77057

THIS CERTIFICATE IS ISSUED AS A MATTER OF INFORMATION ONLY AND CONFERS NO RIGHTS UPON THE CERTIFICATE HOLDER. THIS CERTIFICATE DOES NOT AMEND, EXTEND OR ALTER THE COVERAGE AFFORDED BY THE POLICIES BELOW.

COMPANIES AFFORDING COVERAGE

INSURED

Anadarko Petroleum Corporation
 and its subsidiaries including
Springfield Pipeline LLC
 1201 Lake Robbins Drive
 The Woodlands, TX 77380

Insurer A	Associated Electric and Gas Insurance Services
Insurer B	
Insurer C	
Insurer D	
Insurer E	

COVERAGES

THIS IS TO CERTIFY THAT THE POLICIES LISTED BELOW HAVE BEEN ISSUED TO THE INSURED NAMED ABOVE FOR THE POLICY PERIOD INDICATED. NOTWITHSTANDING ANY REQUIREMENT, TERM OR CONDITION OF ANY CONTRACT OR OTHER DOCUMENT WITH RESPECT TO WHICH THIS CERTIFICATE MAY BE ISSUED OR MAY PERTAIN, THE INSURANCE AFFORDED BY THE POLICIES DESCRIBED HEREIN IS SUBJECT TO ALL THE TERMS, EXCLUSIONS AND CONDITIONS OF SUCH POLICIES. LIMITS SHOWN MAY HAVE BEEN REDUCED BY PAID CLAIMS.

CO LTR	TYPE OF INSURANCE	POLICY NUMBER	POLICY EFFECTIVE DATE (MM/DD/YY)	POLICY EXPIRATION DATE (MM/DD/YY)	LIMITS	
	GENERAL LIABILITY				GENERAL AGGREGATE	\$
	<input type="checkbox"/> COMMERCIAL GENERAL LIABILITY				PRODUCTS-COMP/OP AGG.	\$
	<input type="checkbox"/> CLAIMS MADE <input type="checkbox"/> OCCUR				PERSONAL & ADV. INJURY	\$
					EACH OCCURRENCE	\$
					FIRE DAMAGE (Any one fire)	\$
					MED EXPENSE (Any one person)	\$
	AUTOMOBILE LIABILITY				COMBINED SINGLE LIMIT	\$
	<input type="checkbox"/> ANY AUTO				BODILY INJURY (Per person)	\$
	<input type="checkbox"/> ALL OWNED AUTOS				BODILY INJURY (Per accident)	\$
	<input type="checkbox"/> SCHEDULED AUTOS				PROPERTY DAMAGE	\$
	<input type="checkbox"/> HIRED AUTOS					
	<input type="checkbox"/> NON-OWNED AUTOS					
A	EXCESS LIABILITY	X0598A1A07	6/30/2007	6/30/2008	EACH OCCURRENCE	\$1,000,000
	<input type="checkbox"/> UMBRELLA FORM				AGGREGATE	\$1,000,000
	<input checked="" type="checkbox"/> OTHER THAN UMBRELLA FORM					
	WORKERS COMPENSATION AND EMPLOYERS' LIABILITY				STATUTORY LIMITS	
					EACH ACCIDENT	
					DISEASE-POLICY LIMIT	
					DISEASE EACH EMPLOYEE	
	OTHER:					

Anadarko Petroleum Corporation is self-insured for General Liability exposure(s) US \$5,000,000 each occurrence, above which amount the excess liabilities evidenced hereon will respond.

Re: Range-Sutton 12" Loop Pipeline. Tyler County Road 4400 bore crossing for pipeline construction.

Tyler County, Texas Commissioners Court is named as an Additional insured as required by written contract but only to the extent of those liabilities assumed by the Named Insured therein and furthermore, limited to the operations of the Named Insured.

CERTIFICATE HOLDER

Tyler County Commissioners Court
 Attn: County Judge Jacques Blanchette
 100 West Bluff
 Woodville, TX 75979

CANCELLATION

SHOULD ANY OF THE ABOVE DESCRIBED POLICIES BE CANCELED BEFORE THE EXPIRATION DATE THEREOF, THE ISSUING COMPANY WILL ENDEAVOR TO MAIL 30 DAYS WRITTEN NOTICE TO THE CERTIFICATE HOLDER NAMED TO THE LEFT, BUT FAILURE TO MAIL SUCH NOTICE SHALL IMPOSE NO OBLIGATION OR LIABILITY OF ANY KIND UPON THE COMPANY, ITS AGENTS OR REPRESENTATIVES.

AUTHORIZED REPRESENTATIVE
 Alliant Insurance Services Houston LLC

IMPORTANT

If the certificate holder is an **ADDITIONAL INSURED**, the policy(ies) must be endorsed. A statement on this certificate does not confer rights to the certificate holder in lieu of such endorsement(s).

If **SUBROGATION IS WAIVED**, subject to the terms and conditions of the policy, certain policies may require an endorsement. A statement on this certificate does not confer rights to the certificate holder in lieu of such endorsement(s).

DISCLAIMER

The Certificate of Insurance on the reverse side of this form does not constitute a contract between the issuing insurer(s), authorized representative or producer, and the certificate holder, nor does it affirmatively or negatively amend, extend or alter the coverage afforded by the policies listed thereon.

PERMIT FOR GAS PIPELINE BENEATH COUNTY ROAD RIGHTS-OF-WAY

I.

Springfield Pipeline Company, LLC, ("Springfield") whose principal business address is 1201 Lake Robbins Drive, The Woodlands, Texas 77380, does hereby apply for a permit as hereinafter provided to utilize and cross beneath Tyler County Road 4320 ("CR 4320"), collectively referred to as "county road".

II.

Springfield is a natural gas utility under the Texas Utilities Code § 121.000, *et seq* and is a gatherer, transporter and purchaser of natural gas produced by various wells, including but not limited to the Anadarko Petroleum Well, in Jasper County, Texas situated in the A. Issacs Survey, Abstract No. 316.

III.

Springfield will construct, operate and maintain a pipeline, not greater than twelve inches (12") in diameter, to transport natural gas produced from the Anadarko well. Said pipeline will cross CR 4320, seven tenths (0.7) of a mile, south of the intersection of CR 4320 and FM 1746.

IV.

Springfield will construct, operate and maintain the pipeline in a good and workman-like manner, in compliance with ordinary care in the pipeline industry and in accordance with applicable laws and regulations.

V.

Springfield will construct the pipeline using ordinary care across the rights-of-way for CR 4320 to a depth of up to ten feet (10'), but not less than six feet (6') below the crest of the county

PERMIT FOR GAS PIPELINE BENEATH COUNTY ROAD RIGHTS-OF-WAY

I.

Springfield Pipeline Company, LLC, ("Springfield") whose principal business address is 1201 Lake Robbins Drive, The Woodlands, Texas 77380, does hereby apply for a permit as hereinafter provided to utilize and cross beneath Tyler County Road 4320 ("CR 4320"), collectively referred to as "county road".

II.

Springfield is a natural gas utility under the Texas Utilities Code § 121.000, *et seq* and is a gatherer, transporter and purchaser of natural gas produced by various wells, including but not limited to the Anadarko Petroleum Well, in Jasper County, Texas situated in the A. Issacs Survey, Abstract No. 316.

III.

Springfield will construct, operate and maintain a pipeline, not greater than twelve inches (12") in diameter, to transport natural gas produced from the Anadarko well. Said pipeline will cross CR 4320, seven tenths (0.7) of a mile, south of the intersection of CR 4320 and FM 1746.

IV.

Springfield will construct, operate and maintain the pipeline in a good and workman-like manner, in compliance with ordinary care in the pipeline industry and in accordance with applicable laws and regulations.

V.

Springfield will construct the pipeline using ordinary care across the rights-of-way for CR 4320 to a depth of up to ten feet (10'), but not less than six feet (6') below the crest of the county

road. Springfield will restore the surface of the county road to the same or better condition than its current condition.

VI.

Springfield hereby indemnifies and agrees to hold Tyler County and its officials harmless from any and all claims for personal injury (including death), damage to equipment, supplies or personal property or other claims which arise from Springfield's negligent use of the CR 4320 rights-of-way.

VII.

It is agreed that for the consideration stated in this permit, including indemnifying Tyler County and burying the pipeline up to ten feet, but not less than six feet below the crest of CR 4320, Springfield shall not be required by Tyler County, the Commissioners' Court of Tyler County or the Tyler County Judge to remove the pipeline crossing CR 4320. However, Springfield shall be required to relocate said pipeline only if doing so becomes necessary due to a bona fide public emergency. The relocation shall be within Springfield's thirty-foot rights-of-way beneath CR 4320. Tyler County, the Commissioners' Court of Tyler County and/or the Tyler County Judge shall not require Springfield to relocate the pipeline except for public emergencies, including, but not limited to allowing widening or other changing of any traffic lane. Springfield will remove and relocate the gathering line at its sole cost and expense upon ninety (90) days written notification by Tyler County.

VIII.

Tyler County makes no warranty of title or representation of its right to use the rights-of-way for CR 4320.

IX.

Springfield and the Commissioners' Court of Tyler County, Texas agree that use of the right-of-way shall be limited to the purpose stated herein. By execution hereof in the space provided below, Springfield hereby applies for the permit as stated herein and Tyler County, Texas does hereby grant a permit to Springfield for use of its rights-of-way for CR 4320.

X.

Springfield is required to pay a \$200.00 Administration Fee to Tyler County Commissioners' Precinct where line will be located. Payment is due prior to time of approval by Tyler County Commissioners' Court. Payment may be made payable by check, cashiers check, or money order.

Dated this 16 day of November, 2007.

**HONORABLE TYLER COUNTY JUDGE
OR COMMISSIONERS' COURT OF
TYLER COUNTY, TEXAS**

By: *J. A. Walston*
Printed Name: Julius A. Walston
Authorized representative of Tyler County, Texas

SPRINGFIELD PIPELINE COMPANY, LLC

By: *Jim Hardy*
Printed Name: Jim Hardy
Authorized Representative of Springfield Pipeline Company, LLC

312+00 GROUND

312+50 GROUND

313+00 GROUND
313+10 TOP OF SLOPE
313+17 Q.C. OF DITCH
313+21 EDGE OF ROAD
313+27 Q.C. OF ROAD
313+35 EDGE OF ROAD
313+39 BOTTOM OF SLOPE

314+00 TOP OF SLOPE

314+53 GROUND

315+00 GROUND

Julia Ann Clark Hughes, et vir
Called 92.81 Acres
Volume 438, Page 777

JEAN BATISTE CAZENAVE
ABSTRACT 10

Q PROPOSED PIPELINE
N 86°19' E

N 86°53' E

Hancock Timber Management
(MO 2157)
Called 170 Acres
Volume 821, Page 666

JOSE FALCON
ABSTRACT 15

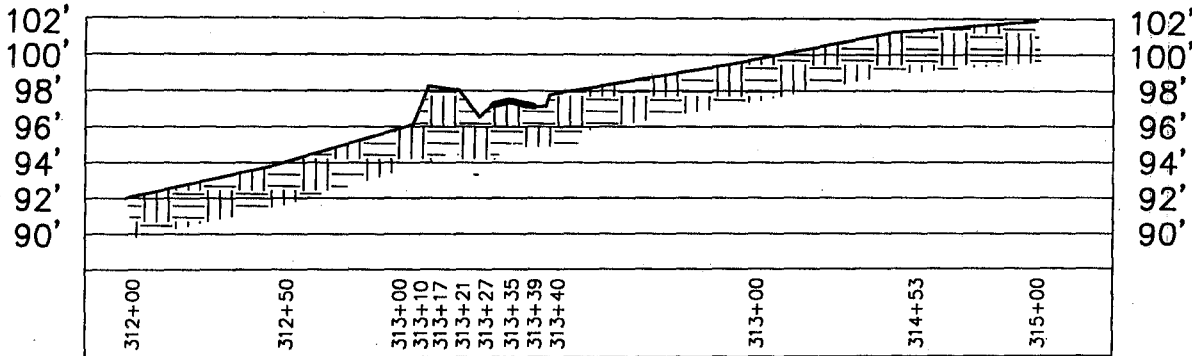

Profile

Scale: 1" = 60' Horiz.
1" = 10' Vert.

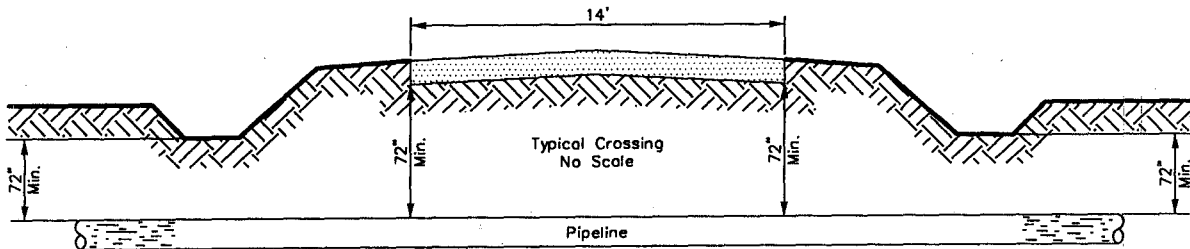

**ELEVATION VIEW
OF PROPOSED PIPELINE
CROSSING COUNTY ROAD NO. 4320**

PIPE SPECIFICATIONS

SPRINGFIELD PIPELINE, LLC

PROPOSED PIPELINE ACROSS COUNTY ROAD NO. 4320
LOCATED 0.7 MILES SOUTH OF F.M. HWY. NO. 1746
JOSE FALCON SURVEY, ABSTRACT 15
TYLER COUNTY, TEXAS

1. Contents:
2. Carrier Pipe:
3. Crossing Method:
4. M.A.O.P.:

WALKER & ASSOCIATES SURVEYING, INC.
TYLER, TEXAS PH: 903-534-9000

Scale: 1" = 60'	Drawn by: R.A.W.	Date: 05/15/06
--------------------	---------------------	-------------------

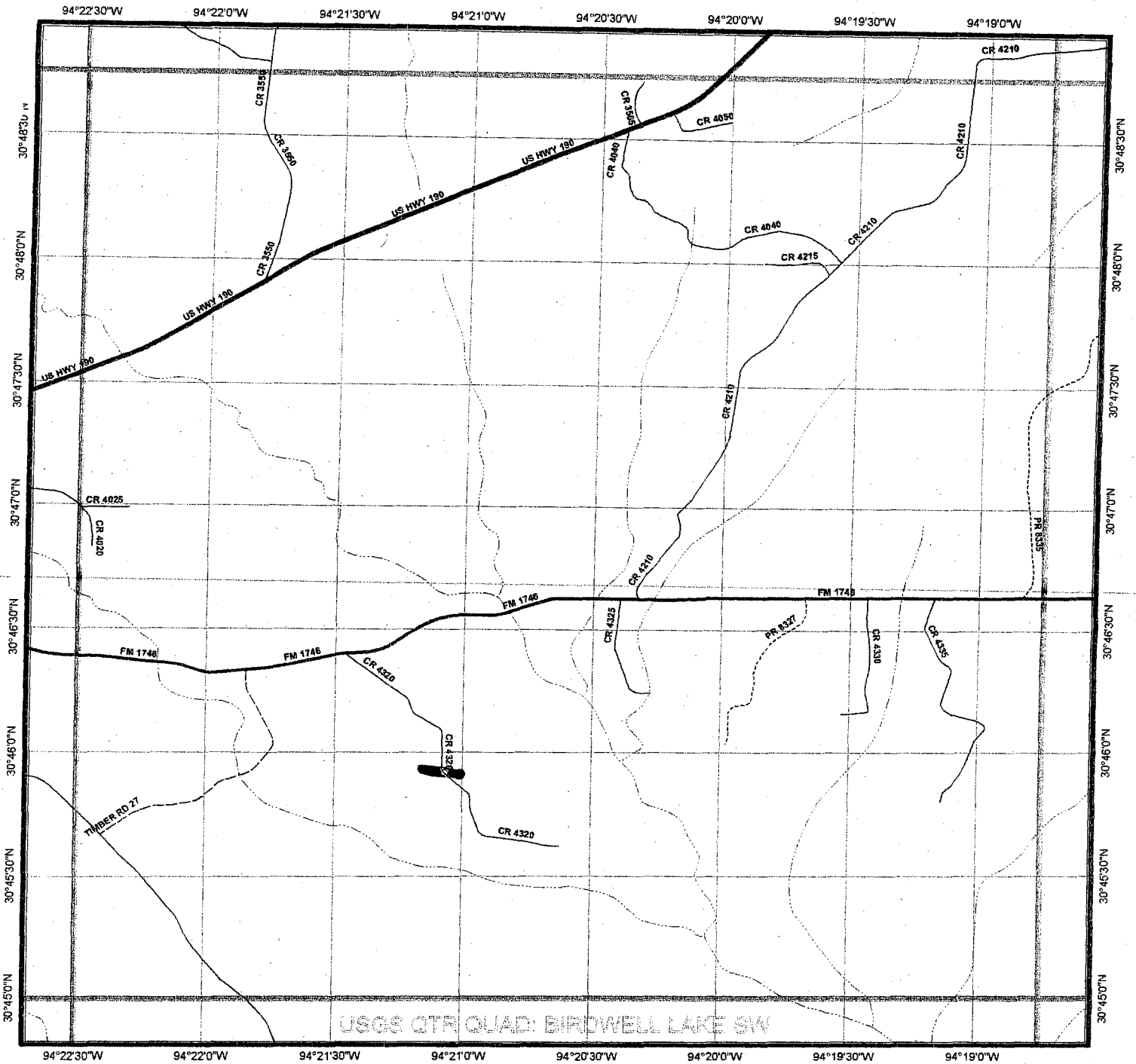

USGS QTR QUAD: BIRDWELL LAKE SW

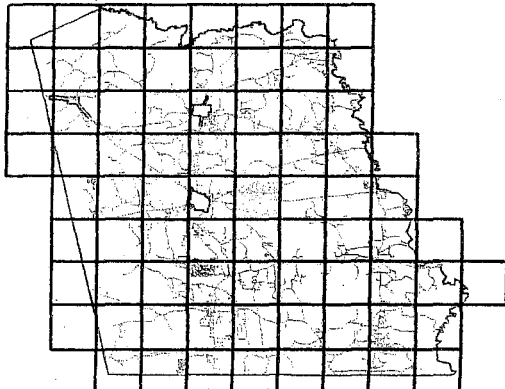

26	27	28	29	30	31	32	33	
34	35	36	37	38	39	40	41	
42	43	44	45	46	47	48	49	50



TYLER COUNTY

Print Date: August 2003

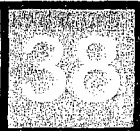

CERTIFICATE OF INSURANCE ISSUE DATE **October 31, 2007**

PRODUCER
Alliant Insurance Services Houston LLC
5847 San Felipe, Suite 2750
Houston, TX 77057

THIS CERTIFICATE IS ISSUED AS A MATTER OF INFORMATION ONLY AND CONFERS NO RIGHTS UPON THE CERTIFICATE HOLDER. THIS CERTIFICATE DOES NOT AMEND, EXTEND OR ALTER THE COVERAGE AFFORDED BY THE POLICIES BELOW.

COMPANIES AFFORDING COVERAGE

INSURED
Anadarko Petroleum Corporation
and its subsidiaries including
Springfield Pipeline LLC
1201 Lake Robbins Drive
The Woodlands, TX 77380

Insurer A	Associated Electric and Gas Insurance Services
Insurer B	
Insurer C	
Insurer D	
Insurer E	

COVERAGES

THIS IS TO CERTIFY THAT THE POLICIES LISTED BELOW HAVE BEEN ISSUED TO THE INSURED NAMED ABOVE FOR THE POLICY PERIOD INDICATED, NOTWITHSTANDING ANY REQUIREMENT, TERM OR CONDITION OF ANY CONTRACT OR OTHER DOCUMENT WITH RESPECT TO WHICH THIS CERTIFICATE MAY BE ISSUED OR MAY PERTAIN. THE INSURANCE AFFORDED BY THE POLICIES DESCRIBED HEREIN IS SUBJECT TO ALL THE TERMS, EXCLUSIONS AND CONDITIONS OF SUCH POLICIES. LIMITS SHOWN MAY HAVE BEEN REDUCED BY PAID CLAIMS.

CO LTR	TYPE OF INSURANCE	POLICY NUMBER	POLICY EFFECTIVE DATE (MM/DD/YY)	POLICY EXPIRATION DATE (MM/DD/YY)	LIMITS	
	GENERAL LIABILITY <input type="checkbox"/> COMMERCIAL GENERAL LIABILITY <input type="checkbox"/> CLAIMS MADE <input type="checkbox"/> OCCUR				GENERAL AGGREGATE	\$
					PRODUCTS-COMP/OP AGG.	\$
					PERSONAL & ADV. INJURY	\$
					EACH OCCURRENCE	\$
					FIRE DAMAGE (Any one fire)	\$
					MED EXPENSE (Any one person)	\$
	AUTOMOBILE LIABILITY <input type="checkbox"/> ANY AUTO <input type="checkbox"/> ALL OWNED AUTOS <input type="checkbox"/> SCHEDULED AUTOS <input type="checkbox"/> HIRED AUTOS <input type="checkbox"/> NON-OWNED AUTOS <input type="checkbox"/> GARAGE LIABILITY <input type="checkbox"/> OTHER				COMBINED SINGLE LIMIT	\$
					BODILY INJURY (Per person)	\$
					BODILY INJURY (Per accident)	\$
					PROPERTY DAMAGE	\$
A	EXCESS LIABILITY <input type="checkbox"/> UMBRELLA FORM <input checked="" type="checkbox"/> OTHER THAN UMBRELLA FORM	X0598A1A07	6/30/2007	6/30/2008	EACH OCCURRENCE	\$1,000,000
					AGGREGATE	\$1,000,000
	WORKERS COMPENSATION AND EMPLOYERS' LIABILITY				STATUTORY LIMITS	
					EACH ACCIDENT	
					DISEASE-POLICY LIMIT	
					DISEASE EACH EMPLOYEE	
	OTHER:					

Anadarko Petroleum Corporation is self-insured for General Liability exposure(s) US \$5,000,000 each occurrence, above which amount the excess liabilities evidenced hereon will respond.
 Re: Range-Sutton 12" Loop Pipeline. Tyler County Road 4320 bore crossing for pipeline construction.
 Tyler County, Texas Commissioners Court is named as an Additional insured as required by written contract but only to the extent of those liabilities assumed by the Named Insured therein and furthermore, limited to the operations of the Named Insured.

CERTIFICATE HOLDER

Tyler County Commissioners Court
 Attn: County Judge Jacques Blanchette
 100 West Bluff
 Woodville, TX 75799

CANCELLATION

SHOULD ANY OF THE ABOVE DESCRIBED POLICIES BE CANCELED BEFORE THE EXPIRATION DATE THEREOF, THE ISSUING COMPANY WILL ENDEAVOR TO MAIL 30 DAYS WRITTEN NOTICE TO THE CERTIFICATE HOLDER NAMED TO THE LEFT, BUT FAILURE TO MAIL SUCH NOTICE SHALL IMPOSE NO OBLIGATION OR LIABILITY OF ANY KIND UPON THE COMPANY, ITS AGENTS OR REPRESENTATIVES.
 AUTHORIZED REPRESENTATIVE
 Alliant Insurance Services Houston LLC

IMPORTANT

If the certificate holder is an **ADDITIONAL INSURED**, the policy(ies) must be endorsed. A statement on this certificate does not confer rights to the certificate holder in lieu of such endorsement(s).

If **SUBROGATION IS WAIVED**, subject to the terms and conditions of the policy, certain policies may require an endorsement. A statement on this certificate does not confer rights to the certificate holder in lieu of such endorsement(s).

DISCLAIMER

The Certificate of Insurance on the reverse side of this form does not constitute a contract between the issuing insurer(s), authorized representative or producer, and the certificate holder, nor does it affirmatively or negatively amend, extend or alter the coverage afforded by the policies listed thereon.



**Cost Summary for Tyler County
Justice of the Peace Case Management
Precincts 2, 3, & 4**

June 29, 2007

P.O. Box 422
Sulphur Springs, TX 75483
(800) 465-5127
www.netdatacorp.net



June 29, 2007

Cost Summary

- **Justice of the Peace Case Management Application (3 pcts)** **\$ 25,000**
- **Onsite Training (80 Hours)** **\$ 8,000**
- **Annual Maintenance & Support~J.P. Case** **\$ 6,000**

TOTAL COST: \$39,000

Many of our customers choose to finance technology for various reasons. Based on planning rates supplied by Government Capital, LLC, the above hardware and software solution could be lease purchased through Government Capital, LLC for the following. This **DOES NOT** include annual maintenance, since that is an annual agreement. The planning rates can change based on credit ratings and the market.

60 month Lease Purchase
\$ 645/month

All pricing and costs included are valid for 90 days from proposal date unless extended in writing by NET Data.

NET Data is designated as a Catalog Information System Vendor (CISV) through the TBPC. For more information please visit the following link.
<http://www.tbpc.state.tx.us/stpurch/cisv.html>



P.O. Box 422
Sulphur Springs, TX 75483
(800) 465-5127
www.netdatacorp.net

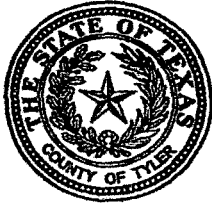

TYLER COUNTY COMMISSIONERS COURT

November 16, 2007 Tyler County Courthouse, Room 101
8:30 A.M. Woodville, Texas

STATEMENT OF NO OPPOSITION

WHEREAS, the Commissioners' Court of Tyler County Texas does hereby recognize a request by Independent Metal Exchange, Inc. (IMEX, Inc.) to establish a facility in Tyler County to conduct recycling operations.

WHEREAS, this said recycling facility will be located about two miles N. of Warren on Hwy. 69, turn right on CR 4470, turn left on CR 4472, go about two hundred yards, gated entry on right with a legal description as A0472 M.MCCORMICK, ACRES 17.53.

WHEREAS, said recycling facility desires to recycle such alloys as aluminum, brass, copper, iron, stainless, tin, and lead.

WHEREAS, such facility will be owned and operated by Alex L. Rawls, Sr. and said operator has communicated with and received communications from Texas Commission on Environmental Quality, Waste Permits Division, MC 124/Municipal Solid Waste Permits Section, P. O. Box 13087, Austin, Texas 78711-3087.

THEREFORE, be it known that the Tyler County Commissioners' Court in its special meeting on the 16th of November 2007 offers a "Statement of No Opposition" to such establishment or existence of IMEX, Inc. presence in Tyler County

Approved on this the 16th day of August 2007.

Martin Nash
Commissioner, Pct. 1

James (Rusty) Hughes
Commissioner, Pct. 3

Joe Marshall
Commissioner, Pct. 3

Jack Walston
Commissioner, Pct. 4

Jacques L. Blanchette
County Judge



COPY

#10

TCEQ Use Only

TCEQ Core Data Form

For detailed instructions regarding completion of this form, please read the Core Data Form Instructions or call 512-239-5175.

SECTION I: General Information

1. Reason for Submission (If other is checked please describe in space provided)			
<input checked="" type="checkbox"/> New Permit, Registration or Authorization (Core Data Form should be submitted with the program application)			
<input type="checkbox"/> Renewal (Core Data Form should be submitted with the renewal form)		<input type="checkbox"/> Other	
2. Attachments Describe Any Attachments: (ex. Title V Application, Waste Transporter Application, etc.)			
<input checked="" type="checkbox"/> Yes <input type="checkbox"/> No			
3. Customer Reference Number (if issued)		Follow this link to search for CN or RN numbers in Central Registry**	4. Regulated Entity Reference Number (if issued)
CN			RN

SECTION II: Customer Information

5. Effective Date for Customer Information Updates (mm/dd/yyyy)			
6. Customer Role (Proposed or Actual) - as it relates to the Regulated Entity listed on this form. Please check only one of the following:			
<input type="checkbox"/> Owner	<input type="checkbox"/> Operator	<input checked="" type="checkbox"/> Owner & Operator	
<input type="checkbox"/> Occupational Licensee	<input type="checkbox"/> Responsible Party	<input type="checkbox"/> Voluntary Cleanup Applicant	<input type="checkbox"/> Other: _____
7. General Customer Information			
<input checked="" type="checkbox"/> New Customer	<input type="checkbox"/> Update to Customer Information	<input type="checkbox"/> Change in Regulated Entity Ownership	
<input type="checkbox"/> Change in Legal Name (Verifiable with the Texas Secretary of State)		<input type="checkbox"/> No Change**	
**If "No Change" and Section I is complete, skip to Section III - Regulated Entity Information.			
8. Type of Customer:	<input checked="" type="checkbox"/> Corporation	<input type="checkbox"/> Individual	<input type="checkbox"/> Sole Proprietorship- D.B.A
<input type="checkbox"/> City Government	<input type="checkbox"/> County Government	<input type="checkbox"/> Federal Government	<input type="checkbox"/> State Government
<input type="checkbox"/> Other Government	<input type="checkbox"/> General Partnership	<input type="checkbox"/> Limited Partnership	<input type="checkbox"/> Other: _____
9. Customer Legal Name (If an individual, print last name first. ex: Doe, John)			If new Customer, enter previous Customer below
IMEX - Independent Metal Exchange, Inc.			End Date:
10. Mailing Address:	436 County Road 4472		
City	Warren	State	TX
ZIP	77664	ZIP + 4	
11. Country Mailing Information (if outside USA)		12. E-Mail Address (if applicable)	
		Imex436@att.net	
13. Telephone Number	14. Extension or Code	15. Fax Number (if applicable)	
(409) 547-0744		(409) 547-0706	
16. Federal Tax ID (9 digits)	17. TX State Franchise Tax ID (11 digits)	18. DUNS Number (if applicable)	19. TX SOS Filing Number (if applicable)
261358164			800886985
20. Number of Employees			21. Independently Owned and Operated?
<input checked="" type="checkbox"/> 0-20	<input type="checkbox"/> 21-100	<input type="checkbox"/> 101-250	<input type="checkbox"/> 251-500
<input type="checkbox"/> 501 and higher		<input checked="" type="checkbox"/> Yes	<input type="checkbox"/> No

SECTION III: Regulated Entity Information

22. General Regulated Entity Information (If 'New Regulated Entity' is selected below this form should be accompanied by a permit application)			
<input checked="" type="checkbox"/> New Regulated Entity	<input type="checkbox"/> Update to Regulated Entity Name	<input type="checkbox"/> Update to Regulated Entity Information	<input type="checkbox"/> No Change** (See below)
**If "NO CHANGE" is checked and Section I is complete, skip to Section IV, Preparer Information.			
23. Regulated Entity Name (name of the site where the regulated action is taking place)			
IMEX - Independent Metal Exchange, Inc.			

NOTICE OF INTENT TO OPERATE A RECYCLING FACILITY

Applicant Information:

Applicant Name:	IMEX – Independent Metal Exchange, Inc
Customer Reference Number - if known* (9 digits)	CN

* If you do not have this number, complete the customer information section of the Core Data Form (TCEQ-10400) and submit it with this application.

Facility Information:

Facility Name:	IMEX – Independent Metal Exchange, Inc.
----------------	---

Regulated Entity Reference Number - if known* (9 digits) RN

* If you do not have this number, complete the regulated entity information section of the Core Data Form (TCEQ-10400) and submit it with this application.

Property Owner Information:

Name:	Alex L. Rawls Sr.
-------	-------------------

Customer Reference Number - if known* (9 digits) CN

* If you do not have this number, complete the customer information section of the Core Data Form (TCEQ-10400) and submit it with this application.

Contact Information:

Name	Patricia L. Phillips
Title	Secretary

Site Location:

1. Provide a city or county roadway map with the site shown and labeled (attach as an exhibit).
2. Provide a description of how to get to the site from an intersection of two state roadways:

About two miles N. of Warren on Hwy.69, turn right on CR 4470, turn left on CR4472 go about two hundred yards, gated entry on right.

3. Provide as an attachment, a list of adjacent property owners and their mailing address.

4. Legal description of the property A0472 M. MCCORMICK, ACRES 17.53

Feed Stock Information:

Material	Average Monthly Acceptance Rate	Maximum Storage Amount	End Product Uses
Aluminum	5,000 #	None in Storage Can Store 10,000#	Metals Buyer
Brass	4,000 #	None in Storage Can Store 8,000#	Metals Buyer
Copper	5,000 #	None in Storage Can Store 10,000#	Metals Buyer
Iron	20,000 #	None in Storage Can Store 40,000#	Metals Buyer
Stainless	5,000 #	None in Storage Can Store 10,000#	Metals Buyer
Tin	10,000 #	None in Storage Can Store 20,000#	Metals Buyer
Lead	2,000 #	None in Storage Can Store 4,000#	Metals Buyer

Recycling and Storage Description:

(please provide enough detail in accordance with 30 TAG Chapter 328, Sections 328.5(b)(2) and 328.5(b)(3)).

All metals purchased will be sorted out accordingly until enough has been received to haul to Houston to a metals buyer. We have a building on site that is to be used for sorting and storing until the metals are taken to Houston. As for Feed Stock information, monthly acceptance rate depends on how much is brought in. We are a small business; in all fairness I have no idea what will come in. Due to cash flow, the metal will not be sitting there for very long.

Financial Assurance:

If you store combustible material outdoors or your operation poses a significant risk to public health and safety, you are required by 30 TAG §328.5(d) to establish financial assurance unless your facility is excluded by 30 TAG §328.5(a). For more information, refer to *Guidelines for Complying with Financial Assurance Requirements for Recycling, Composting, and Mulching Facilities*, at www.tceq.state.tx.us/assets/public/permitting/waste/msw/recycling_fa_guide.pdf.

Applicant's Statement:

"I certify under penalty of law that this document and all attachments were prepared under my direction or supervision in accordance with a system designed to assure that qualified personnel properly gather and evaluate the information submitted. Based on my inquiry of the person or persons who manage the system, or those persons directly responsible for gathering the information, the information submitted is, to the best of my knowledge and belief, true, accurate, and complete. I am aware there are significant penalties for submitting false information, including the possibility of fine and imprisonment for knowing violations." [30 TAC §305.44(b)]

Alex L. Rawls Sr
Signature of the Owner/Operator

11-7-07
Date

Alex L. Rawls Sr
Printed Name

Owner
Title

This form is required by 30 Texas Administrative Code §328.5(b), and must be submitted for current recycling facilities and prior to start-up for a new recycling facility. Owners/operators are required to meet the provisions set forth in §328.3 "General Requirements", §328.4 "Limitations on Storage of Recyclable Materials", and §328.5 "Reporting and Recordkeeping Requirements". Subsequent forms shall be submitted to update or change any information within 90 days of the effective date of the change.

If you have any questions, please contact the Waste Permits Division of TCEQ at (512) 239-2334.

Please submit this completed form and one or more TCEQ Core Data Form(s) (TCEQ-10400) to:

TEXAS COMMISSION ON ENVIRONMENTAL QUALITY

Waste Permits Division

MC 124/Municipal Solid Waste Permits Section

P.O. Box 13087

Austin, Texas 78711-3087



Sorry! When printing directly from the browser your map may be incorrectly cropped. To print the entire map, try clicking the "Printer-Friendly" link at the top of your results page.



★ 436 County Road 4472
Warren, TX 77664, US



Sorry! When printing directly from the browser your map may be incorrectly cropped. To print the entire map, try clicking the "Printer-Friendly" link at the top of your results page.

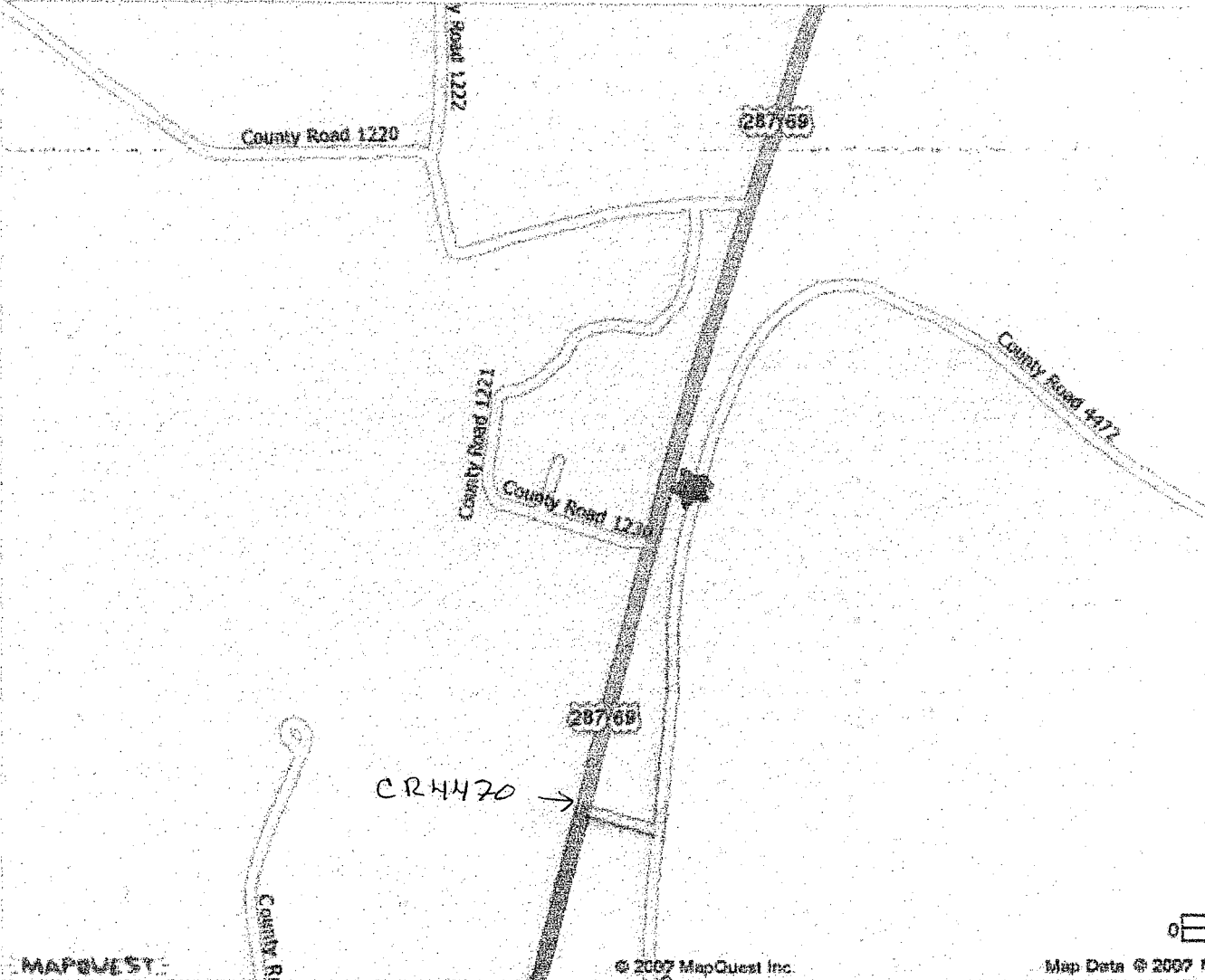

All rights reserved. Use Subject to License/Copyright

This map is informational only. No representation is made or warranty given as to its content. User assumes all risk of use. MapQuest and its suppliers assume no responsibility for any loss or delay resulting from such use.

R25536

R25537

US HWY 69 S

R72110

CR 447

R57010

R57016

R57286

R57288

- - Property Data Selection Menu - -

Prop ID: ~~79910~~ (Real Property) Owner: READ, ATTLE A & MARY LEE
 Ref ID: (47318) P O BOX 85
 Legal : A0472 M.MCCORMICK & A0744 R.H.COUSINS, WOODVILLE, TX 75979
 ACRES 33.069

Status : CR4472 Owner Phone: 283-3443
 POLE M LAND FOR R62431,R62428, Prop Links : R62431, R62428
 Entities : G229, GSP, HOS, SW, ESD4 Nbhd. Code : A0744
 AD (Yes) Mort Lender:
 Exemptions : Freeze Year:
 Agent Info Total Land HS/NHS : 3,450
 RB Docs : Total Prod. Mkt. : 50,020
 Chief Appr : Total Imp. HS/NHS : 2,000
 Entity Docs: Total Mkt. Value : 55,470

Alt. (D)isp.	(P)rimary	(S)econdary	(L)and/Impr.
(G)en. Appr.	(O)wnership	(H)istory	(.) More

Enter Option from Above, or "RETURN" to Exit: _____

- - Property Data Selection Menu - -

Top ID: ~~87215~~ (Real Property)
 Ref ID:
 Legal : A0472 M. MCCORMICK, ACRES 14.67

Owner: BURNS, DANIEL J
 (7214) P O BOX 512
 WARREN, TX 77664

Status : 839 CR4472
 Activities : G229, GSP, HOS, SW, ESD4
 AD (Yes)
 Exemptions : HS

Owner Phone: 547-3775
 Prop Links :
 Nbhd. Code : A0472
 Mort Lender:
 Freeze Year:

Agent Info
 B Docs :
 Chief Appr :
 Property Docs:

Total Land HS/NHS : 30,740
 Total Prod. Mkt. : 0
 Total Imp. HS/NHS : 173,600
 Total Mkt. Value : 204,340

Alt. (D)isp. (G)en. Appr.	(P)rimary (O)wnership	(S)econdary (H)istory	(L)and/Impr. (.) More
------------------------------	--------------------------	--------------------------	--------------------------

Enter Option from Above, or "RETURN" to Exit: _____



TCEQ Use Only

TCEQ Core Data Form

For detailed instructions regarding completion of this form, please read the Core Data Form Instructions or call 512-239-5175.

SECTION I: General Information

1. Reason for Submission (If other is checked please describe in space provided)		
<input checked="" type="checkbox"/> New Permit, Registration or Authorization (Core Data Form should be submitted with the program application)		
<input type="checkbox"/> Renewal (Core Data Form should be submitted with the renewal form)	<input type="checkbox"/> Other	
2. Attachments Describe Any Attachments: (ex. Title V Application, Waste Transporter Application, etc.)		
<input checked="" type="checkbox"/> Yes <input type="checkbox"/> No		
3. Customer Reference Number (if issued)	Follow this link to search for CN or RN numbers in Central Registry**	4. Regulated Entity Reference Number (if issued)
CN		RN

SECTION II: Customer Information

5. Effective Date for Customer Information Updates (mm/dd/yyyy)			
6. Customer Role (Proposed or Actual) – as it relates to the Regulated Entity listed on this form. Please check only one of the following:			
<input type="checkbox"/> Owner	<input type="checkbox"/> Operator	<input checked="" type="checkbox"/> Owner & Operator	
<input type="checkbox"/> Occupational Licensee	<input type="checkbox"/> Responsible Party	<input type="checkbox"/> Voluntary Cleanup Applicant	<input type="checkbox"/> Other: _____
7. General Customer Information			
<input checked="" type="checkbox"/> New Customer		<input type="checkbox"/> Update to Customer Information	<input type="checkbox"/> Change in Regulated Entity Ownership
<input type="checkbox"/> Change in Legal Name (Verifiable with the Texas Secretary of State)		<input type="checkbox"/> No Change**	
**If "No Change" and Section I is complete, skip to Section III – Regulated Entity Information.			
8. Type of Customer:			
<input checked="" type="checkbox"/> Corporation	<input type="checkbox"/> Individual	<input type="checkbox"/> Sole Proprietorship- D.B.A	
<input type="checkbox"/> City Government	<input type="checkbox"/> County Government	<input type="checkbox"/> Federal Government	<input type="checkbox"/> State Government
<input type="checkbox"/> Other Government	<input type="checkbox"/> General Partnership	<input type="checkbox"/> Limited Partnership	<input type="checkbox"/> Other: _____
9. Customer Legal Name (If an individual, print last name first. ex. Doe, John)		If new Customer, enter previous Customer End Date:	
IMEX - Independent Metal Exchange, Inc.			
10. Mailing Address:			
436 County Road 4472			
City	Warren	State	TX
ZIP	77664	ZIP + 4	
11. Country Mailing Information (if outside USA)		12. E-Mail Address (if applicable)	
		Imex436@att.net	
13. Telephone Number		14. Extension or Code	
(409) 547-0744			
		15. Fax Number (if applicable)	
		(409) 547-0706	
16. Federal Tax ID (9 digits)	17. TX State Franchise Tax ID (11 digits)	18. DUNS Number (if applicable)	19. TX SOS Filing Number (if applicable)
261358164			800886985
20. Number of Employees			21. Independently Owned and Operated?
<input checked="" type="checkbox"/> 0-20 <input type="checkbox"/> 21-100 <input type="checkbox"/> 101-250 <input type="checkbox"/> 251-500 <input type="checkbox"/> 501 and higher			<input checked="" type="checkbox"/> Yes <input type="checkbox"/> No

SECTION III: Regulated Entity Information

22. General Regulated Entity information (If 'New Regulated Entity' is selected below this form should be accompanied by a permit application)			
<input checked="" type="checkbox"/> New Regulated Entity		<input type="checkbox"/> Update to Regulated Entity Name	<input type="checkbox"/> Update to Regulated Entity Information
		<input type="checkbox"/> No Change** (See below)	
**If "NO CHANGE" is checked and Section I is complete, skip to Section IV, Preparer Information.			
23. Regulated Entity Name (name of the site where the regulated action is taking place)			
IMEX - Independent Metal Exchange, Inc.			

Fact Sheet

Senior Community Service Employment Program

For more information contact Communications
703-522-7272 or info@experienceworks.org

Senior Community Service Employment Program - The largest program offered by Experience Works is the Senior Community Service Employment Program (SCSEP). This program, funded under Title V of the Older Americans Act as well as state and local grants, enables us to help thousands of low-income individuals, age 55 and older, throughout the United States.

- Through this program, seniors benefit from training, counseling, and community service assignments at faith-based and community organizations in their communities, prior to transitioning into the workforce.
- Participants are placed at eligible host agencies* (primarily at faith-based and community organizations) for which they are paid the minimum wage for an average of 20 hours per week.
- Nationally, in the 2005-06 program year, we served more than 23,000 seniors, and provided services to more than 8,650 nonprofit and public organizations in 39 states and territories. Seniors on our programs contributed more than 11 million hours of community service while living productive and independent lives.
- In the last ten years more than 55,600 low-income seniors found employment through our services.

Program Objectives

- To foster and promote useful part-time community service opportunities for economically disadvantaged persons.
- Enhance the abilities, skills, and aptitudes of the participants to increase their opportunities to obtain jobs offering improved income and benefits.
- Change negative attitudes and stereotypes about older individuals through public education and demonstrated success.
- Conduct projects that promote innovative work alternatives, second career training, and the placement of participants into employment.
- Gain valuable new skills and experience that help secure meaningful employment and provide valuable services to host agencies and communities.

Job Training Objectives

- Gain job-related training designed to assist participants in performing their community service assignments and in finding employment.
- Develop new skills and upgrade existing skills.
- Understand safe work practices and healthful work environments.
- Learn effective job search skills and develop good work habits.

Program Qualifications

- Be 55 years of age or older, and a resident of the state where he or she is enrolled in the SCSEP program.
- Annual family income must not be more than 125% of the established federal poverty income guidelines.
- Be eligible to work in the United States.
- Be currently under-employed.

* A host agency is either a private nonprofit organization (other than a political party) that is tax exempt under section 501(c) (3) of the Internal Revenue code of 1954, or a public agency operated by a unit of government.

For more information, please contact Sandy Abshire or Sandy Smith – 936-327-0250
Toll free number: 1-877-781-9953

SUMMARY REPORT

TYLER COUNTY, TEXAS
JOINT ELECTION
NOVEMBER 6, 2007

RUN DATE:11/19/07 04:09 PM

	VOTES	PERCENT
PRECINCTS COUNTED (OF 18)	18	100.00
REGISTERED VOTERS - TOTAL	0	
BALLOTS CAST - TOTAL	1,455	
PROP 1 TYLER COUNTYWIDE		
VOTE FOR 1		
FOR (A FAVOR)	681	57.08
AGAINST (EN CONTRA)	512	42.92
PROP 2 TYLER COUNTYWIDE		
VOTE FOR 1		
FOR (A FAVOR)	768	62.09
AGAINST (EN CONTRA)	469	37.91
PROP 3 TYLER COUNTYWIDE		
VOTE FOR 1		
FOR (A FAVOR)	804	66.50
AGAINST (EN CONTRA)	405	33.50
PROP 4 TYLER COUNTYWIDE		
VOTE FOR 1		
FOR (A FAVOR)	649	52.85
AGAINST (EN CONTRA)	579	47.15
PROP 5 TYLER COUNTYWIDE		
VOTE FOR 1		
FOR (A FAVOR)	772	64.44
AGAINST (EN CONTRA)	426	35.56
PROP 6 TYLER COUNTYWIDE		
VOTE FOR 1		
FOR (A FAVOR)	870	70.67
AGAINST (EN CONTRA)	361	29.33
PROP 7 TYLER COUNTYWIDE		
VOTE FOR 1		
FOR (A FAVOR)	974	80.23
AGAINST (EN CONTRA)	240	19.77
PROP 8 TYLER COUNTYWIDE		
VOTE FOR 1		
FOR (A FAVOR)	898	74.52
AGAINST (EN CONTRA)	307	25.48
PROP 9 TYLER COUNTYWIDE		
VOTE FOR 1		
FOR (A FAVOR)	1,075	85.73
AGAINST (EN CONTRA)	179	14.27

	VOTES	PERCENT
PROP 10 TYLER COUNTYWIDE		
VOTE FOR 1		
FOR (A FAVOR)	881	73.05
AGAINST (EN CONTRA)	325	26.95
PROP 11 TYLER COUNTYWIDE		
VOTE FOR 1		
FOR (A FAVOR)	942	78.63
AGAINST (EN CONTRA)	256	21.37
PROP 12 TYLER COUNTYWIDE		
VOTE FOR 1		
FOR (A FAVOR)	770	62.55
AGAINST (EN CONTRA)	461	37.45
PROP 13 TYLER COUNTYWIDE		
VOTE FOR 1		
FOR (A FAVOR)	1,039	82.99
AGAINST (EN CONTRA)	213	17.01
PROP 14 TYLER COUNTYWIDE		
VOTE FOR 1		
FOR (A FAVOR)	909	73.90
AGAINST (EN CONTRA)	321	26.10
PROP 15 TYLER COUNTYWIDE		
VOTE FOR 1		
FOR (A FAVOR)	856	68.81
AGAINST (EN CONTRA)	388	31.19
PROP 16 TYLER COUNTYWIDE		
VOTE FOR 1		
FOR (A FAVOR)	707	57.81
AGAINST (EN CONTRA)	516	42.19
WARREN ISD PROP		
VOTE FOR 1		
FOR (A FAVOR)	543	66.63
AGAINST (EN CONTRA)	272	33.37

E.V.
 PRECINCT REPORT

TYLER COUNTY, TEXAS
 JOINT ELECTION
 NOVEMBER 6, 2007

REPORT-EL30

PAGE 0001-01

RUN DATE:11/06/07 05:18 PM

0001 PRECINCT 1

	VOTES	PERCENT
REGISTERED VOTERS - TOTAL	0	
BALLOTS CAST - TOTAL	35	
PROP 1 TYLER COUNTYWIDE		
VOTE FOR 1		
FOR (A FAVOR)	20	60.61
AGAINST (EN CONTRA)	13	39.39
Over Votes	0	
Under Votes	2	
PROP 2 TYLER COUNTYWIDE		
VOTE FOR 1		
FOR (A FAVOR)	19	54.29
AGAINST (EN CONTRA)	16	45.71
Over Votes	0	
Under Votes	0	
PROP 3 TYLER COUNTYWIDE		
VOTE FOR 1		
FOR (A FAVOR)	19	57.58
AGAINST (EN CONTRA)	14	42.42
Over Votes	0	
Under Votes	2	
PROP 4 TYLER COUNTYWIDE		
VOTE FOR 1		
FOR (A FAVOR)	13	38.24
AGAINST (EN CONTRA)	21	61.76
Over Votes	0	
Under Votes	1	
PROP 5 TYLER COUNTYWIDE		
VOTE FOR 1		
FOR (A FAVOR)	18	52.94
AGAINST (EN CONTRA)	16	47.06
Over Votes	0	
Under Votes	1	
PROP 6 TYLER COUNTYWIDE		
VOTE FOR 1		
FOR (A FAVOR)	19	55.88
AGAINST (EN CONTRA)	15	44.12
Over Votes	0	
Under Votes	1	
PROP 7 TYLER COUNTYWIDE		
VOTE FOR 1		
FOR (A FAVOR)	25	73.53
AGAINST (EN CONTRA)	9	26.47
Over Votes	0	
Under Votes	1	

PROP 8 TYLER COUNTYWIDE		
VOTE FOR 1		
FOR (A FAVOR)	19	55.88
AGAINST (EN CONTRA)	15	44.12
Over Votes	0	
Under Votes	1	

PROP 9 TYLER COUNTYWIDE		
VOTE FOR 1		
FOR (A FAVOR)	25	71.43
AGAINST (EN CONTRA)	10	28.57
Over Votes	0	
Under Votes	0	

PROP 10 TYLER COUNTYWIDE		
VOTE FOR 1		
FOR (A FAVOR)	24	72.73
AGAINST (EN CONTRA)	9	27.27
Over Votes	0	
Under Votes	2	

PROP 11 TYLER COUNTYWIDE		
VOTE FOR 1		
FOR (A FAVOR)	21	61.76
AGAINST (EN CONTRA)	13	38.24
Over Votes	0	
Under Votes	1	

PROP 12 TYLER COUNTYWIDE		
VOTE FOR 1		
FOR (A FAVOR)	18	51.43
AGAINST (EN CONTRA)	17	48.57
Over Votes	0	
Under Votes	0	

PROP 13 TYLER COUNTYWIDE		
VOTE FOR 1		
FOR (A FAVOR)	24	68.57
AGAINST (EN CONTRA)	11	31.43
Over Votes	0	
Under Votes	0	

PROP 14 TYLER COUNTYWIDE		
VOTE FOR 1		
FOR (A FAVOR)	23	65.71
AGAINST (EN CONTRA)	12	34.29
Over Votes	0	
Under Votes	0	

RUN DATE:11/06/07 05:18 PM

0001 PRECINCT 1

VOTES PERCENT

PROP 15 TYLER COUNTYWIDE

VOTE FOR 1

FOR (A FAVOR)	12	34.29
AGAINST (EN CONTRA)	23	65.71
Over Votes	0	
Under Votes	0	

PROP 16 TYLER COUNTYWIDE

VOTE FOR 1

FOR (A FAVOR)	20	57.14
AGAINST (EN CONTRA)	15	42.86
Over Votes	0	
Under Votes	0	

RUN DATE:11/06/07 05:18 PM

0002 PRECINCT 2

	VOTES	PERCENT
REGISTERED VOTERS - TOTAL	0	
BALLOTS CAST - TOTAL	15	
PROP 1 TYLER COUNTYWIDE		
VOTE FOR 1		
FOR (A FAVOR)	8	61.54
AGAINST (EN CONTRA)	5	38.46
Over Votes	0	
Under Votes	2	
PROP 2 TYLER COUNTYWIDE		
VOTE FOR 1		
FOR (A FAVOR)	12	80.00
AGAINST (EN CONTRA)	3	20.00
Over Votes	0	
Under Votes	0	
PROP 3 TYLER COUNTYWIDE		
VOTE FOR 1		
FOR (A FAVOR)	9	60.00
AGAINST (EN CONTRA)	6	40.00
Over Votes	0	
Under Votes	0	
PROP 4 TYLER COUNTYWIDE		
VOTE FOR 1		
FOR (A FAVOR)	8	53.33
AGAINST (EN CONTRA)	7	46.67
Over Votes	0	
Under Votes	0	
PROP 5 TYLER COUNTYWIDE		
VOTE FOR 1		
FOR (A FAVOR)	10	66.67
AGAINST (EN CONTRA)	5	33.33
Over Votes	0	
Under Votes	0	
PROP 6 TYLER COUNTYWIDE		
VOTE FOR 1		
FOR (A FAVOR)	12	80.00
AGAINST (EN CONTRA)	3	20.00
Over Votes	0	
Under Votes	0	
PROP 7 TYLER COUNTYWIDE		
VOTE FOR 1		
FOR (A FAVOR)	11	84.62
AGAINST (EN CONTRA)	2	15.38
Over Votes	0	
Under Votes	2	

PROP 8 TYLER COUNTYWIDE

	VOTES	PERCENT
VOTE FOR 1		
FOR (A FAVOR)	11	78.57
AGAINST (EN CONTRA)	3	21.43
Over Votes	0	
Under Votes	1	

PROP 9 TYLER COUNTYWIDE

	VOTES	PERCENT
VOTE FOR 1		
FOR (A FAVOR)	12	80.00
AGAINST (EN CONTRA)	3	20.00
Over Votes	0	
Under Votes	0	

PROP 10 TYLER COUNTYWIDE

	VOTES	PERCENT
VOTE FOR 1		
FOR (A FAVOR)	13	100.00
AGAINST (EN CONTRA)	0	
Over Votes	0	
Under Votes	2	

PROP 11 TYLER COUNTYWIDE

	VOTES	PERCENT
VOTE FOR 1		
FOR (A FAVOR)	11	73.33
AGAINST (EN CONTRA)	4	26.67
Over Votes	0	
Under Votes	0	

PROP 12 TYLER COUNTYWIDE

	VOTES	PERCENT
VOTE FOR 1		
FOR (A FAVOR)	9	60.00
AGAINST (EN CONTRA)	6	40.00
Over Votes	0	
Under Votes	0	

PROP 13 TYLER COUNTYWIDE

	VOTES	PERCENT
VOTE FOR 1		
FOR (A FAVOR)	10	66.67
AGAINST (EN CONTRA)	5	33.33
Over Votes	0	
Under Votes	0	

PROP 14 TYLER COUNTYWIDE

	VOTES	PERCENT
VOTE FOR 1		
FOR (A FAVOR)	10	66.67
AGAINST (EN CONTRA)	5	33.33
Over Votes	0	
Under Votes	0	

RUN DATE:11/06/07 05:18 PM

0002 PRECINCT 2

VOTES PERCENT

PROP 15 TYLER COUNTYWIDE

VOTE FOR 1

FOR (A FAVOR)	10	66.67
AGAINST (EN CONTRA)	5	33.33
Over Votes	0	
Under Votes	0	

PROP 16 TYLER COUNTYWIDE

VOTE FOR 1

FOR (A FAVOR)	10	66.67
AGAINST (EN CONTRA)	5	33.33
Over Votes	0	
Under Votes	0	

RUN DATE:11/06/07 05:18 PM

0003 PRECINCT 3

	VOTES	PERCENT
REGISTERED VOTERS - TOTAL	0	
BALLOTS CAST - TOTAL	38	
PROP 1 TYLER COUNTYWIDE		
VOTE FOR 1		
FOR (A FAVOR)	19	50.00
AGAINST (EN CONTRA)	19	50.00
Over Votes	0	
Under Votes	0	
PROP 2 TYLER COUNTYWIDE		
VOTE FOR 1		
FOR (A FAVOR)	23	60.53
AGAINST (EN CONTRA)	15	39.47
Over Votes	0	
Under Votes	0	
PROP 3 TYLER COUNTYWIDE		
VOTE FOR 1		
FOR (A FAVOR)	25	69.44
AGAINST (EN CONTRA)	11	30.56
Over Votes	0	
Under Votes	2	
PROP 4 TYLER COUNTYWIDE		
VOTE FOR 1		
FOR (A FAVOR)	21	56.76
AGAINST (EN CONTRA)	16	43.24
Over Votes	1	
Under Votes	0	
PROP 5 TYLER COUNTYWIDE		
VOTE FOR 1		
FOR (A FAVOR)	25	65.79
AGAINST (EN CONTRA)	13	34.21
Over Votes	0	
Under Votes	0	
PROP 6 TYLER COUNTYWIDE		
VOTE FOR 1		
FOR (A FAVOR)	29	76.32
AGAINST (EN CONTRA)	9	23.68
Over Votes	0	
Under Votes	0	
PROP 7 TYLER COUNTYWIDE		
VOTE FOR 1		
FOR (A FAVOR)	30	78.95
AGAINST (EN CONTRA)	8	21.05
Over Votes	0	
Under Votes	0	

PROP 8 TYLER COUNTYWIDE

	VOTES	PERCENT
VOTE FOR 1		
FOR (A FAVOR)	30	81.08
AGAINST (EN CONTRA)	7	18.92
Over Votes	0	
Under Votes	1	

PROP 9 TYLER COUNTYWIDE

	VOTES	PERCENT
VOTE FOR 1		
FOR (A FAVOR)	34	91.89
AGAINST (EN CONTRA)	3	8.11
Over Votes	0	
Under Votes	1	

PROP 10 TYLER COUNTYWIDE

	VOTES	PERCENT
VOTE FOR 1		
FOR (A FAVOR)	27	72.97
AGAINST (EN CONTRA)	10	27.03
Over Votes	0	
Under Votes	1	

PROP 11 TYLER COUNTYWIDE

	VOTES	PERCENT
VOTE FOR 1		
FOR (A FAVOR)	29	78.38
AGAINST (EN CONTRA)	8	21.62
Over Votes	0	
Under Votes	1	

PROP 12 TYLER COUNTYWIDE

	VOTES	PERCENT
VOTE FOR 1		
FOR (A FAVOR)	22	59.46
AGAINST (EN CONTRA)	15	40.54
Over Votes	0	
Under Votes	1	

PROP 13 TYLER COUNTYWIDE

	VOTES	PERCENT
VOTE FOR 1		
FOR (A FAVOR)	32	86.49
AGAINST (EN CONTRA)	5	13.51
Over Votes	0	
Under Votes	1	

PROP 14 TYLER COUNTYWIDE

	VOTES	PERCENT
VOTE FOR 1		
FOR (A FAVOR)	30	81.08
AGAINST (EN CONTRA)	7	18.92
Over Votes	0	
Under Votes	1	

RUN DATE:11/06/07 05:18 PM

0003 PRECINCT 3

VOTES PERCENT

PROP 15 TYLER COUNTYWIDE

VOTE FOR 1

FOR (A FAVOR)	22	59.46
AGAINST (EN CONTRA)	15	40.54
Over Votes	0	
Under Votes	1	

PROP 16 TYLER COUNTYWIDE

VOTE FOR 1

FOR (A FAVOR)	25	67.57
AGAINST (EN CONTRA)	12	32.43
Over Votes	0	
Under Votes	1	

WARREN ISD PROP

VOTE FOR 1

FOR (A FAVOR)	3	30.00
AGAINST (EN CONTRA)	7	70.00
Over Votes	0	
Under Votes	0	

RUN DATE:11/06/07 05:18 PM

0004 PRECINCT 4

	VOTES	PERCENT
REGISTERED VOTERS - TOTAL	0	
BALLOTS CAST - TOTAL	83	
PROP 1 TYLER COUNTYWIDE		
VOTE FOR 1		
FOR (A FAVOR)	41	66.13
AGAINST (EN CONTRA)	21	33.87
Over Votes	0	
Under Votes	21	
PROP 2 TYLER COUNTYWIDE		
VOTE FOR 1		
FOR (A FAVOR)	49	70.00
AGAINST (EN CONTRA)	21	30.00
Over Votes	0	
Under Votes	13	
PROP 3 TYLER COUNTYWIDE		
VOTE FOR 1		
FOR (A FAVOR)	50	73.53
AGAINST (EN CONTRA)	18	26.47
Over Votes	0	
Under Votes	15	
PROP 4 TYLER COUNTYWIDE		
VOTE FOR 1		
FOR (A FAVOR)	46	71.88
AGAINST (EN CONTRA)	18	28.13
Over Votes	0	
Under Votes	19	
PROP 5 TYLER COUNTYWIDE		
VOTE FOR 1		
FOR (A FAVOR)	49	80.33
AGAINST (EN CONTRA)	12	19.67
Over Votes	0	
Under Votes	22	
PROP 6 TYLER COUNTYWIDE		
VOTE FOR 1		
FOR (A FAVOR)	46	70.77
AGAINST (EN CONTRA)	19	29.23
Over Votes	0	
Under Votes	18	
PROP 7 TYLER COUNTYWIDE		
VOTE FOR 1		
FOR (A FAVOR)	57	85.07
AGAINST (EN CONTRA)	10	14.93
Over Votes	0	
Under Votes	16	

	VOTES	PERCENT
PROP 8 TYLER COUNTYWIDE		
VOTE FOR 1		
FOR (A FAVOR)	46	75.41
AGAINST (EN CONTRA)	15	24.59
Over Votes	0	
Under Votes	22	

	VOTES	PERCENT
PROP 9 TYLER COUNTYWIDE		
VOTE FOR 1		
FOR (A FAVOR)	60	89.55
AGAINST (EN CONTRA)	7	10.45
Over Votes	0	
Under Votes	16	

	VOTES	PERCENT
PROP 10 TYLER COUNTYWIDE		
VOTE FOR 1		
FOR (A FAVOR)	49	76.56
AGAINST (EN CONTRA)	15	23.44
Over Votes	0	
Under Votes	19	

	VOTES	PERCENT
PROP 11 TYLER COUNTYWIDE		
VOTE FOR 1		
FOR (A FAVOR)	49	77.78
AGAINST (EN CONTRA)	14	22.22
Over Votes	0	
Under Votes	20	

	VOTES	PERCENT
PROP 12 TYLER COUNTYWIDE		
VOTE FOR 1		
FOR (A FAVOR)	49	75.38
AGAINST (EN CONTRA)	16	24.62
Over Votes	0	
Under Votes	18	

	VOTES	PERCENT
PROP 13 TYLER COUNTYWIDE		
VOTE FOR 1		
FOR (A FAVOR)	63	88.73
AGAINST (EN CONTRA)	8	11.27
Over Votes	0	
Under Votes	12	

	VOTES	PERCENT
PROP 14 TYLER COUNTYWIDE		
VOTE FOR 1		
FOR (A FAVOR)	52	77.61
AGAINST (EN CONTRA)	15	22.39
Over Votes	0	
Under Votes	16	

RUN DATE:11/06/07 05:18 PM

0004 PRECINCT 4

VOTES PERCENT

PROP 15 TYLER COUNTYWIDE

VOTE FOR 1		
FOR (A FAVOR)	52	77.61
AGAINST (EN CONTRA)	15	22.39
Over Votes	0	
Under Votes	16	

PROP 16 TYLER COUNTYWIDE

VOTE FOR 1		
FOR (A FAVOR)	45	69.23
AGAINST (EN CONTRA)	20	30.77
Over Votes	0	
Under Votes	18	

WARREN ISD PROP

VOTE FOR 1		
FOR (A FAVOR)	59	71.08
AGAINST (EN CONTRA)	24	28.92
Over Votes	0	
Under Votes	0	

RUN DATE:11/06/07 05:18 PM

0005 PRECINCT 5

	VOTES	PERCENT
REGISTERED VOTERS - TOTAL	0	
BALLOTS CAST - TOTAL	6	
PROP 1 TYLER COUNTYWIDE		
VOTE FOR 1		
FOR (A FAVOR)	3	50.00
AGAINST (EN CONTRA)	3	50.00
Over Votes	0	
Under Votes	0	
PROP 2 TYLER COUNTYWIDE		
VOTE FOR 1		
FOR (A FAVOR)	0	
AGAINST (EN CONTRA)	6	100.00
Over Votes	0	
Under Votes	0	
PROP 3 TYLER COUNTYWIDE		
VOTE FOR 1		
FOR (A FAVOR)	4	66.67
AGAINST (EN CONTRA)	2	33.33
Over Votes	0	
Under Votes	0	
PROP 4 TYLER COUNTYWIDE		
VOTE FOR 1		
FOR (A FAVOR)	0	
AGAINST (EN CONTRA)	6	100.00
Over Votes	0	
Under Votes	0	
PROP 5 TYLER COUNTYWIDE		
VOTE FOR 1		
FOR (A FAVOR)	3	50.00
AGAINST (EN CONTRA)	3	50.00
Over Votes	0	
Under Votes	0	
PROP 6 TYLER COUNTYWIDE		
VOTE FOR 1		
FOR (A FAVOR)	4	66.67
AGAINST (EN CONTRA)	2	33.33
Over Votes	0	
Under Votes	0	
PROP 7 TYLER COUNTYWIDE		
VOTE FOR 1		
FOR (A FAVOR)	4	66.67
AGAINST (EN CONTRA)	2	33.33
Over Votes	0	
Under Votes	0	

	VOTES	PERCENT
PROP 8 TYLER COUNTYWIDE		
VOTE FOR 1		
FOR (A FAVOR)	3	50.00
AGAINST (EN CONTRA)	3	50.00
Over Votes	0	
Under Votes	0	

	VOTES	PERCENT
PROP 9 TYLER COUNTYWIDE		
VOTE FOR 1		
FOR (A FAVOR)	4	66.67
AGAINST (EN CONTRA)	2	33.33
Over Votes	0	
Under Votes	0	

	VOTES	PERCENT
PROP 10 TYLER COUNTYWIDE		
VOTE FOR 1		
FOR (A FAVOR)	3	50.00
AGAINST (EN CONTRA)	3	50.00
Over Votes	0	
Under Votes	0	

	VOTES	PERCENT
PROP 11 TYLER COUNTYWIDE		
VOTE FOR 1		
FOR (A FAVOR)	4	66.67
AGAINST (EN CONTRA)	2	33.33
Over Votes	0	
Under Votes	0	

	VOTES	PERCENT
PROP 12 TYLER COUNTYWIDE		
VOTE FOR 1		
FOR (A FAVOR)	1	16.67
AGAINST (EN CONTRA)	5	83.33
Over Votes	0	
Under Votes	0	

	VOTES	PERCENT
PROP 13 TYLER COUNTYWIDE		
VOTE FOR 1		
FOR (A FAVOR)	4	66.67
AGAINST (EN CONTRA)	2	33.33
Over Votes	0	
Under Votes	0	

	VOTES	PERCENT
PROP 14 TYLER COUNTYWIDE		
VOTE FOR 1		
FOR (A FAVOR)	3	50.00
AGAINST (EN CONTRA)	3	50.00
Over Votes	0	
Under Votes	0	

RUN DATE:11/06/07 05:18 PM

0005 PRECINCT 5

VOTES PERCENT

PROP 15 TYLER COUNTYWIDE

VOTE FOR 1

FOR (A FAVOR)	4	66.67
AGAINST (EN CONTRA)	2	33.33
Over Votes	0	
Under Votes	0	

PROP 16 TYLER COUNTYWIDE

VOTE FOR 1

FOR (A FAVOR)	2	33.33
AGAINST (EN CONTRA)	4	66.67
Over Votes	0	
Under Votes	0	

RUN DATE:11/06/07 05:18 PM

0006 PRECINCT 6

	VOTES	PERCENT
REGISTERED VOTERS - TOTAL	0	
BALLOTS CAST - TOTAL	35	
PROP 1 TYLER COUNTYWIDE		
VOTE FOR 1		
FOR (A FAVOR)	24	75.00
AGAINST (EN CONTRA)	8	25.00
Over Votes	0	
Under Votes	3	
PROP 2 TYLER COUNTYWIDE		
VOTE FOR 1		
FOR (A FAVOR)	22	66.67
AGAINST (EN CONTRA)	11	33.33
Over Votes	0	
Under Votes	2	
PROP 3 TYLER COUNTYWIDE		
VOTE FOR 1		
FOR (A FAVOR)	23	71.88
AGAINST (EN CONTRA)	9	28.13
Over Votes	0	
Under Votes	3	
PROP 4 TYLER COUNTYWIDE		
VOTE FOR 1		
FOR (A FAVOR)	22	66.67
AGAINST (EN CONTRA)	11	33.33
Over Votes	0	
Under Votes	2	
PROP 5 TYLER COUNTYWIDE		
VOTE FOR 1		
FOR (A FAVOR)	22	68.75
AGAINST (EN CONTRA)	10	31.25
Over Votes	0	
Under Votes	3	
PROP 6 TYLER COUNTYWIDE		
VOTE FOR 1		
FOR (A FAVOR)	22	70.97
AGAINST (EN CONTRA)	9	29.03
Over Votes	0	
Under Votes	4	
PROP 7 TYLER COUNTYWIDE		
VOTE FOR 1		
FOR (A FAVOR)	25	78.13
AGAINST (EN CONTRA)	7	21.88
Over Votes	0	
Under Votes	3	

PROP 8 TYLER COUNTYWIDE

	VOTES	PERCENT
VOTE FOR 1		
FOR (A FAVOR)	26	81.25
AGAINST (EN CONTRA)	6	18.75
Over Votes	0	
Under Votes	3	

PROP 9 TYLER COUNTYWIDE

	VOTES	PERCENT
VOTE FOR 1		
FOR (A FAVOR)	30	90.91
AGAINST (EN CONTRA)	3	9.09
Over Votes	0	
Under Votes	2	

PROP 10 TYLER COUNTYWIDE

	VOTES	PERCENT
VOTE FOR 1		
FOR (A FAVOR)	30	90.91
AGAINST (EN CONTRA)	3	9.09
Over Votes	0	
Under Votes	2	

PROP 11 TYLER COUNTYWIDE

	VOTES	PERCENT
VOTE FOR 1		
FOR (A FAVOR)	31	96.88
AGAINST (EN CONTRA)	1	3.13
Over Votes	0	
Under Votes	3	

PROP 12 TYLER COUNTYWIDE

	VOTES	PERCENT
VOTE FOR 1		
FOR (A FAVOR)	31	91.18
AGAINST (EN CONTRA)	3	8.82
Over Votes	0	
Under Votes	1	

PROP 13 TYLER COUNTYWIDE

	VOTES	PERCENT
VOTE FOR 1		
FOR (A FAVOR)	31	93.94
AGAINST (EN CONTRA)	2	6.06
Over Votes	0	
Under Votes	2	

PROP 14 TYLER COUNTYWIDE

	VOTES	PERCENT
VOTE FOR 1		
FOR (A FAVOR)	25	78.13
AGAINST (EN CONTRA)	7	21.88
Over Votes	0	
Under Votes	3	

RUN DATE:11/06/07 05:18 PM

0006 PRECINCT 6

VOTES PERCENT

PROP 15 TYLER COUNTYWIDE

VOTE FOR 1

FOR (A FAVOR)	27	81.82
AGAINST (EN CONTRA)	6	18.18
Over Votes	0	
Under Votes	2	

PROP 16 TYLER COUNTYWIDE

VOTE FOR 1

FOR (A FAVOR)	23	71.88
AGAINST (EN CONTRA)	9	28.13
Over Votes	0	
Under Votes	3	

WARREN ISD PROP

VOTE FOR 1

FOR (A FAVOR)	22	62.86
AGAINST (EN CONTRA)	13	37.14
Over Votes	0	
Under Votes	0	

RUN DATE:11/06/07 05:18 PM

0007 PRECINCT 7

	VOTES	PERCENT
REGISTERED VOTERS - TOTAL	0	
BALLOTS CAST - TOTAL	8	
PROP 1 TYLER COUNTYWIDE		
VOTE FOR 1		
FOR (A FAVOR)	1	25.00
AGAINST (EN CONTRA)	3	75.00
Over Votes	0	
Under Votes	4	
PROP 2 TYLER COUNTYWIDE		
VOTE FOR 1		
FOR (A FAVOR)	4	57.14
AGAINST (EN CONTRA)	3	42.86
Over Votes	0	
Under Votes	1	
PROP 3 TYLER COUNTYWIDE		
VOTE FOR 1		
FOR (A FAVOR)	3	37.50
AGAINST (EN CONTRA)	5	62.50
Over Votes	0	
Under Votes	0	
PROP 4 TYLER COUNTYWIDE		
VOTE FOR 1		
FOR (A FAVOR)	0	
AGAINST (EN CONTRA)	4	100.00
Over Votes	0	
Under Votes	4	
PROP 5 TYLER COUNTYWIDE		
VOTE FOR 1		
FOR (A FAVOR)	4	57.14
AGAINST (EN CONTRA)	3	42.86
Over Votes	0	
Under Votes	1	
PROP 6 TYLER COUNTYWIDE		
VOTE FOR 1		
FOR (A FAVOR)	7	87.50
AGAINST (EN CONTRA)	1	12.50
Over Votes	0	
Under Votes	0	
PROP 7 TYLER COUNTYWIDE		
VOTE FOR 1		
FOR (A FAVOR)	4	80.00
AGAINST (EN CONTRA)	1	20.00
Over Votes	0	
Under Votes	3	

	VOTES	PERCENT
PROP 8 TYLER COUNTYWIDE		
VOTE FOR 1		
FOR (A FAVOR)	5	71.43
AGAINST (EN CONTRA)	2	28.57
Over Votes	0	
Under Votes	1	

	VOTES	PERCENT
PROP 9 TYLER COUNTYWIDE		
VOTE FOR 1		
FOR (A FAVOR)	7	87.50
AGAINST (EN CONTRA)	1	12.50
Over Votes	0	
Under Votes	0	

	VOTES	PERCENT
PROP 10 TYLER COUNTYWIDE		
VOTE FOR 1		
FOR (A FAVOR)	6	75.00
AGAINST (EN CONTRA)	2	25.00
Over Votes	0	
Under Votes	0	

	VOTES	PERCENT
PROP 11 TYLER COUNTYWIDE		
VOTE FOR 1		
FOR (A FAVOR)	4	80.00
AGAINST (EN CONTRA)	1	20.00
Over Votes	0	
Under Votes	3	

	VOTES	PERCENT
PROP 12 TYLER COUNTYWIDE		
VOTE FOR 1		
FOR (A FAVOR)	1	14.29
AGAINST (EN CONTRA)	6	85.71
Over Votes	0	
Under Votes	1	

	VOTES	PERCENT
PROP 13 TYLER COUNTYWIDE		
VOTE FOR 1		
FOR (A FAVOR)	4	57.14
AGAINST (EN CONTRA)	3	42.86
Over Votes	0	
Under Votes	1	

	VOTES	PERCENT
PROP 14 TYLER COUNTYWIDE		
VOTE FOR 1		
FOR (A FAVOR)	7	87.50
AGAINST (EN CONTRA)	1	12.50
Over Votes	0	
Under Votes	0	

RUN DATE:11/06/07 05:18 PM

0007 PRECINCT 7

VOTES PERCENT

PROP 15 TYLER COUNTYWIDE

VOTE FOR 1

FOR (A FAVOR)	6	85.71
AGAINST (EN CONTRA)	1	14.29
Over Votes	0	
Under Votes	1	

PROP 16 TYLER COUNTYWIDE

VOTE FOR 1

FOR (A FAVOR)	5	71.43
AGAINST (EN CONTRA)	2	28.57
Over Votes	0	
Under Votes	1	

RUN DATE:11/06/07 05:18 PM

0008 PRECINCT 8

	VOTES	PERCENT
REGISTERED VOTERS - TOTAL	0	
BALLOTS CAST - TOTAL	6	
PROP 1 TYLER COUNTYWIDE		
VOTE FOR 1		
FOR (A FAVOR)	2	33.33
AGAINST (EN CONTRA)	4	66.67
Over Votes	0	
Under Votes	0	
PROP 2 TYLER COUNTYWIDE		
VOTE FOR 1		
FOR (A FAVOR)	4	66.67
AGAINST (EN CONTRA)	2	33.33
Over Votes	0	
Under Votes	0	
PROP 3 TYLER COUNTYWIDE		
VOTE FOR 1		
FOR (A FAVOR)	4	80.00
AGAINST (EN CONTRA)	1	20.00
Over Votes	0	
Under Votes	1	
PROP 4 TYLER COUNTYWIDE		
VOTE FOR 1		
FOR (A FAVOR)	3	50.00
AGAINST (EN CONTRA)	3	50.00
Over Votes	0	
Under Votes	0	
PROP 5 TYLER COUNTYWIDE		
VOTE FOR 1		
FOR (A FAVOR)	6	100.00
AGAINST (EN CONTRA)	0	
Over Votes	0	
Under Votes	0	
PROP 6 TYLER COUNTYWIDE		
VOTE FOR 1		
FOR (A FAVOR)	4	66.67
AGAINST (EN CONTRA)	2	33.33
Over Votes	0	
Under Votes	0	
PROP 7 TYLER COUNTYWIDE		
VOTE FOR 1		
FOR (A FAVOR)	6	100.00
AGAINST (EN CONTRA)	0	
Over Votes	0	
Under Votes	0	

	VOTES	PERCENT
PROP 8 TYLER COUNTYWIDE		
VOTE FOR 1		
FOR (A FAVOR)	6	100.00
AGAINST (EN CONTRA)	0	
Over Votes	0	
Under Votes	0	
PROP 9 TYLER COUNTYWIDE		
VOTE FOR 1		
FOR (A FAVOR)	6	100.00
AGAINST (EN CONTRA)	0	
Over Votes	0	
Under Votes	0	
PROP 10 TYLER COUNTYWIDE		
VOTE FOR 1		
FOR (A FAVOR)	6	100.00
AGAINST (EN CONTRA)	0	
Over Votes	0	
Under Votes	0	
PROP 11 TYLER COUNTYWIDE		
VOTE FOR 1		
FOR (A FAVOR)	6	100.00
AGAINST (EN CONTRA)	0	
Over Votes	0	
Under Votes	0	
PROP 12 TYLER COUNTYWIDE		
VOTE FOR 1		
FOR (A FAVOR)	3	50.00
AGAINST (EN CONTRA)	3	50.00
Over Votes	0	
Under Votes	0	
PROP 13 TYLER COUNTYWIDE		
VOTE FOR 1		
FOR (A FAVOR)	5	83.33
AGAINST (EN CONTRA)	1	16.67
Over Votes	0	
Under Votes	0	
PROP 14 TYLER COUNTYWIDE		
VOTE FOR 1		
FOR (A FAVOR)	6	100.00
AGAINST (EN CONTRA)	0	
Over Votes	0	
Under Votes	0	

RUN DATE:11/06/07 05:18 PM

0008 PRECINCT 8

VOTES PERCENT

PROP 15 TYLER COUNTYWIDE

VOTE FOR 1		
FOR (A FAVOR)	3	50.00
AGAINST (EN CONTRA)	3	50.00
Over Votes	0	
Under Votes	0	

PROP 16 TYLER COUNTYWIDE

VOTE FOR 1		
FOR (A FAVOR)	3	50.00
AGAINST (EN CONTRA)	3	50.00
Over Votes	0	
Under Votes	0	

RUN DATE:11/06/07 05:18 PM

0009 PRECINCT 9

	VOTES	PERCENT
REGISTERED VOTERS - TOTAL	0	
BALLOTS CAST - TOTAL	5	
PROP 1 TYLER COUNTYWIDE		
VOTE FOR 1		
FOR (A FAVOR)	1	25.00
AGAINST (EN CONTRA)	3	75.00
Over Votes	0	
Under Votes	1	
PROP 2 TYLER COUNTYWIDE		
VOTE FOR 1		
FOR (A FAVOR)	3	60.00
AGAINST (EN CONTRA)	2	40.00
Over Votes	0	
Under Votes	0	
PROP 3 TYLER COUNTYWIDE		
VOTE FOR 1		
FOR (A FAVOR)	1	33.33
AGAINST (EN CONTRA)	2	66.67
Over Votes	0	
Under Votes	2	
PROP 4 TYLER COUNTYWIDE		
VOTE FOR 1		
FOR (A FAVOR)	1	20.00
AGAINST (EN CONTRA)	4	80.00
Over Votes	0	
Under Votes	0	
PROP 5 TYLER COUNTYWIDE		
VOTE FOR 1		
FOR (A FAVOR)	3	60.00
AGAINST (EN CONTRA)	2	40.00
Over Votes	0	
Under Votes	0	
PROP 6 TYLER COUNTYWIDE		
VOTE FOR 1		
FOR (A FAVOR)	4	80.00
AGAINST (EN CONTRA)	1	20.00
Over Votes	0	
Under Votes	0	
PROP 7 TYLER COUNTYWIDE		
VOTE FOR 1		
FOR (A FAVOR)	5	100.00
AGAINST (EN CONTRA)	0	
Over Votes	0	
Under Votes	0	

	VOTES	PERCENT
PROP 8 TYLER COUNTYWIDE		
VOTE FOR 1		
FOR (A FAVOR)	3	75.00
AGAINST (EN CONTRA)	1	25.00
Over Votes	0	
Under Votes	1	

	VOTES	PERCENT
PROP 9 TYLER COUNTYWIDE		
VOTE FOR 1		
FOR (A FAVOR)	4	80.00
AGAINST (EN CONTRA)	1	20.00
Over Votes	0	
Under Votes	0	

	VOTES	PERCENT
PROP 10 TYLER COUNTYWIDE		
VOTE FOR 1		
FOR (A FAVOR)	3	60.00
AGAINST (EN CONTRA)	2	40.00
Over Votes	0	
Under Votes	0	

	VOTES	PERCENT
PROP 11 TYLER COUNTYWIDE		
VOTE FOR 1		
FOR (A FAVOR)	3	100.00
AGAINST (EN CONTRA)	0	
Over Votes	0	
Under Votes	2	

	VOTES	PERCENT
PROP 12 TYLER COUNTYWIDE		
VOTE FOR 1		
FOR (A FAVOR)	3	60.00
AGAINST (EN CONTRA)	2	40.00
Over Votes	0	
Under Votes	0	

	VOTES	PERCENT
PROP 13 TYLER COUNTYWIDE		
VOTE FOR 1		
FOR (A FAVOR)	4	100.00
AGAINST (EN CONTRA)	0	
Over Votes	0	
Under Votes	1	

	VOTES	PERCENT
PROP 14 TYLER COUNTYWIDE		
VOTE FOR 1		
FOR (A FAVOR)	4	80.00
AGAINST (EN CONTRA)	1	20.00
Over Votes	0	
Under Votes	0	

RUN DATE:11/06/07 05:18 PM

0009 PRECINCT 9

VOTES PERCENT

PROP 15 TYLER COUNTYWIDE
VOTE FOR 1

FOR (A FAVOR)	2	50.00
AGAINST (EN CONTRA)	2	50.00
Over Votes	0	
Under Votes	1	

PROP 16 TYLER COUNTYWIDE
VOTE FOR 1

FOR (A FAVOR)	2	40.00
AGAINST (EN CONTRA)	3	60.00
Over Votes	0	
Under Votes	0	

RUN DATE:11/06/07 05:18 PM

0010 PRECINCT 10

	VOTES	PERCENT
REGISTERED VOTERS - TOTAL	0	
BALLOTS CAST - TOTAL	14	
PROP 1 TYLER COUNTYWIDE		
VOTE FOR 1		
FOR (A FAVOR)	11	78.57
AGAINST (EN CONTRA)	3	21.43
Over Votes	0	
Under Votes	0	
PROP 2 TYLER COUNTYWIDE		
VOTE FOR 1		
FOR (A FAVOR)	11	78.57
AGAINST (EN CONTRA)	3	21.43
Over Votes	0	
Under Votes	0	
PROP 3 TYLER COUNTYWIDE		
VOTE FOR 1		
FOR (A FAVOR)	13	92.86
AGAINST (EN CONTRA)	1	7.14
Over Votes	0	
Under Votes	0	
PROP 4 TYLER COUNTYWIDE		
VOTE FOR 1		
FOR (A FAVOR)	11	78.57
AGAINST (EN CONTRA)	3	21.43
Over Votes	0	
Under Votes	0	
PROP 5 TYLER COUNTYWIDE		
VOTE FOR 1		
FOR (A FAVOR)	9	64.29
AGAINST (EN CONTRA)	5	35.71
Over Votes	0	
Under Votes	0	
PROP 6 TYLER COUNTYWIDE		
VOTE FOR 1		
FOR (A FAVOR)	9	64.29
AGAINST (EN CONTRA)	5	35.71
Over Votes	0	
Under Votes	0	
PROP 7 TYLER COUNTYWIDE		
VOTE FOR 1		
FOR (A FAVOR)	11	78.57
AGAINST (EN CONTRA)	3	21.43
Over Votes	0	
Under Votes	0	

PROP 8 TYLER COUNTYWIDE		
VOTE FOR 1		
FOR (A FAVOR)	11	78.57
AGAINST (EN CONTRA)	3	21.43
Over Votes	0	
Under Votes	0	
PROP 9 TYLER COUNTYWIDE		
VOTE FOR 1		
FOR (A FAVOR)	12	85.71
AGAINST (EN CONTRA)	2	14.29
Over Votes	0	
Under Votes	0	
PROP 10 TYLER COUNTYWIDE		
VOTE FOR 1		
FOR (A FAVOR)	13	92.86
AGAINST (EN CONTRA)	1	7.14
Over Votes	0	
Under Votes	0	
PROP 11 TYLER COUNTYWIDE		
VOTE FOR 1		
FOR (A FAVOR)	14	100.00
AGAINST (EN CONTRA)	0	
Over Votes	0	
Under Votes	0	
PROP 12 TYLER COUNTYWIDE		
VOTE FOR 1		
FOR (A FAVOR)	11	78.57
AGAINST (EN CONTRA)	3	21.43
Over Votes	0	
Under Votes	0	
PROP 13 TYLER COUNTYWIDE		
VOTE FOR 1		
FOR (A FAVOR)	12	100.00
AGAINST (EN CONTRA)	0	
Over Votes	0	
Under Votes	2	
PROP 14 TYLER COUNTYWIDE		
VOTE FOR 1		
FOR (A FAVOR)	13	92.86
AGAINST (EN CONTRA)	1	7.14
Over Votes	0	
Under Votes	0	

RUN DATE:11/06/07 05:18 PM

0010 PRECINCT 10

VOTES PERCENT

PROP 15 TYLER COUNTYWIDE

VOTE FOR 1

FOR (A FAVOR)	9	64.29
AGAINST (EN CONTRA)	5	35.71
Over Votes	0	
Under Votes	0	

PROP 16 TYLER COUNTYWIDE

VOTE FOR 1

FOR (A FAVOR)	8	61.54
AGAINST (EN CONTRA)	5	38.46
Over Votes	0	
Under Votes	1	

RUN DATE:11/06/07 05:18 PM

0011 PRECINCT 11

	VOTES	PERCENT
REGISTERED VOTERS - TOTAL	0	
BALLOTS CAST - TOTAL	2	
PROP 1 TYLER COUNTYWIDE		
VOTE FOR 1		
FOR (A FAVOR)	2	100.00
AGAINST (EN CONTRA)	0	
Over Votes	0	
Under Votes	0	
PROP 2 TYLER COUNTYWIDE		
VOTE FOR 1		
FOR (A FAVOR)	2	100.00
AGAINST (EN CONTRA)	0	
Over Votes	0	
Under Votes	0	
PROP 3 TYLER COUNTYWIDE		
VOTE FOR 1		
FOR (A FAVOR)	2	100.00
AGAINST (EN CONTRA)	0	
Over Votes	0	
Under Votes	0	
PROP 4 TYLER COUNTYWIDE		
VOTE FOR 1		
FOR (A FAVOR)	2	100.00
AGAINST (EN CONTRA)	0	
Over Votes	0	
Under Votes	0	
PROP 5 TYLER COUNTYWIDE		
VOTE FOR 1		
FOR (A FAVOR)	2	100.00
AGAINST (EN CONTRA)	0	
Over Votes	0	
Under Votes	0	
PROP 6 TYLER COUNTYWIDE		
VOTE FOR 1		
FOR (A FAVOR)	2	100.00
AGAINST (EN CONTRA)	0	
Over Votes	0	
Under Votes	0	
PROP 7 TYLER COUNTYWIDE		
VOTE FOR 1		
FOR (A FAVOR)	2	100.00
AGAINST (EN CONTRA)	0	
Over Votes	0	
Under Votes	0	

PROP 8 TYLER COUNTYWIDE

	VOTES	PERCENT
VOTE FOR 1		
FOR (A FAVOR)	1	50.00
AGAINST (EN CONTRA)	1	50.00
Over Votes	0	
Under Votes	0	

PROP 9 TYLER COUNTYWIDE

	VOTES	PERCENT
VOTE FOR 1		
FOR (A FAVOR)	2	100.00
AGAINST (EN CONTRA)	0	
Over Votes	0	
Under Votes	0	

PROP 10 TYLER COUNTYWIDE

	VOTES	PERCENT
VOTE FOR 1		
FOR (A FAVOR)	2	100.00
AGAINST (EN CONTRA)	0	
Over Votes	0	
Under Votes	0	

PROP 11 TYLER COUNTYWIDE

	VOTES	PERCENT
VOTE FOR 1		
FOR (A FAVOR)	2	100.00
AGAINST (EN CONTRA)	0	
Over Votes	0	
Under Votes	0	

PROP 12 TYLER COUNTYWIDE

	VOTES	PERCENT
VOTE FOR 1		
FOR (A FAVOR)	0	
AGAINST (EN CONTRA)	2	100.00
Over Votes	0	
Under Votes	0	

PROP 13 TYLER COUNTYWIDE

	VOTES	PERCENT
VOTE FOR 1		
FOR (A FAVOR)	1	50.00
AGAINST (EN CONTRA)	1	50.00
Over Votes	0	
Under Votes	0	

PROP 14 TYLER COUNTYWIDE

	VOTES	PERCENT
VOTE FOR 1		
FOR (A FAVOR)	0	
AGAINST (EN CONTRA)	2	100.00
Over Votes	0	
Under Votes	0	

RUN DATE:11/06/07 05:18 PM

0011 PRECINCT 11

VOTES PERCENT

PROP 15 TYLER COUNTYWIDE

VOTE FOR 1		
FOR (A FAVOR)	0	
AGAINST (EN CONTRA)	2	100.00
Over Votes	0	
Under Votes	0	

PROP 16 TYLER COUNTYWIDE

VOTE FOR 1		
FOR (A FAVOR)	0	
AGAINST (EN CONTRA)	2	100.00
Over Votes	0	
Under Votes	0	

RUN DATE:11/06/07 05:18 PM

0013 PRECINCT 13

	VOTES	PERCENT
REGISTERED VOTERS - TOTAL	0	
BALLOTS CAST - TOTAL	10	
PROP 1 TYLER COUNTYWIDE		
VOTE FOR 1		
FOR (A FAVOR)	7	70.00
AGAINST (EN CONTRA)	3	30.00
Over Votes	0	
Under Votes	0	
PROP 2 TYLER COUNTYWIDE		
VOTE FOR 1		
FOR (A FAVOR)	7	70.00
AGAINST (EN CONTRA)	3	30.00
Over Votes	0	
Under Votes	0	
PROP 3 TYLER COUNTYWIDE		
VOTE FOR 1		
FOR (A FAVOR)	8	80.00
AGAINST (EN CONTRA)	2	20.00
Over Votes	0	
Under Votes	0	
PROP 4 TYLER COUNTYWIDE		
VOTE FOR 1		
FOR (A FAVOR)	9	90.00
AGAINST (EN CONTRA)	1	10.00
Over Votes	0	
Under Votes	0	
PROP 5 TYLER COUNTYWIDE		
VOTE FOR 1		
FOR (A FAVOR)	7	70.00
AGAINST (EN CONTRA)	3	30.00
Over Votes	0	
Under Votes	0	
PROP 6 TYLER COUNTYWIDE		
VOTE FOR 1		
FOR (A FAVOR)	9	90.00
AGAINST (EN CONTRA)	1	10.00
Over Votes	0	
Under Votes	0	
PROP 7 TYLER COUNTYWIDE		
VOTE FOR 1		
FOR (A FAVOR)	9	90.00
AGAINST (EN CONTRA)	1	10.00
Over Votes	0	
Under Votes	0	

	VOTES	PERCENT
PROP 8 TYLER COUNTYWIDE		
VOTE FOR 1		
FOR (A FAVOR)	9	90.00
AGAINST (EN CONTRA)	1	10.00
Over Votes	0	
Under Votes	0	
PROP 9 TYLER COUNTYWIDE		
VOTE FOR 1		
FOR (A FAVOR)	8	80.00
AGAINST (EN CONTRA)	2	20.00
Over Votes	0	
Under Votes	0	
PROP 10 TYLER COUNTYWIDE		
VOTE FOR 1		
FOR (A FAVOR)	6	66.67
AGAINST (EN CONTRA)	3	33.33
Over Votes	0	
Under Votes	1	
PROP 11 TYLER COUNTYWIDE		
VOTE FOR 1		
FOR (A FAVOR)	10	100.00
AGAINST (EN CONTRA)	0	
Over Votes	0	
Under Votes	0	
PROP 12 TYLER COUNTYWIDE		
VOTE FOR 1		
FOR (A FAVOR)	6	60.00
AGAINST (EN CONTRA)	4	40.00
Over Votes	0	
Under Votes	0	
PROP 13 TYLER COUNTYWIDE		
VOTE FOR 1		
FOR (A FAVOR)	9	90.00
AGAINST (EN CONTRA)	1	10.00
Over Votes	0	
Under Votes	0	
PROP 14 TYLER COUNTYWIDE		
VOTE FOR 1		
FOR (A FAVOR)	9	90.00
AGAINST (EN CONTRA)	1	10.00
Over Votes	0	
Under Votes	0	

RUN DATE:11/06/07 05:18 PM

0013 PRECINCT 13

VOTES PERCENT

PROP 15 TYLER COUNTYWIDE

VOTE FOR 1

FOR (A FAVOR)	7	70.00
AGAINST (EN CONTRA)	3	30.00
Over Votes	0	
Under Votes	0	

PROP 16 TYLER COUNTYWIDE

VOTE FOR 1

FOR (A FAVOR)	6	60.00
AGAINST (EN CONTRA)	4	40.00
Over Votes	0	
Under Votes	0	

RUN DATE:11/06/07 05:18 PM

0014 PRECINCT 14

	VOTES	PERCENT
REGISTERED VOTERS - TOTAL	0	
BALLOTS CAST - TOTAL	18	
PROP 1 TYLER COUNTYWIDE		
VOTE FOR 1		
FOR (A FAVOR)	14	82.35
AGAINST (EN CONTRA)	3	17.65
Over Votes	0	
Under Votes	1	
PROP 2 TYLER COUNTYWIDE		
VOTE FOR 1		
FOR (A FAVOR)	10	55.56
AGAINST (EN CONTRA)	8	44.44
Over Votes	0	
Under Votes	0	
PROP 3 TYLER COUNTYWIDE		
VOTE FOR 1		
FOR (A FAVOR)	15	83.33
AGAINST (EN CONTRA)	3	16.67
Over Votes	0	
Under Votes	0	
PROP 4 TYLER COUNTYWIDE		
VOTE FOR 1		
FOR (A FAVOR)	10	58.82
AGAINST (EN CONTRA)	7	41.18
Over Votes	0	
Under Votes	1	
PROP 5 TYLER COUNTYWIDE		
VOTE FOR 1		
FOR (A FAVOR)	14	82.35
AGAINST (EN CONTRA)	3	17.65
Over Votes	0	
Under Votes	1	
PROP 6 TYLER COUNTYWIDE		
VOTE FOR 1		
FOR (A FAVOR)	17	94.44
AGAINST (EN CONTRA)	1	5.56
Over Votes	0	
Under Votes	0	
PROP 7 TYLER COUNTYWIDE		
VOTE FOR 1		
FOR (A FAVOR)	16	94.12
AGAINST (EN CONTRA)	1	5.88
Over Votes	0	
Under Votes	1	

PROP 8 TYLER COUNTYWIDE		
VOTE FOR 1		
FOR (A FAVOR)	18	100.00
AGAINST (EN CONTRA)	0	
Over Votes	0	
Under Votes	0	
PROP 9 TYLER COUNTYWIDE		
VOTE FOR 1		
FOR (A FAVOR)	15	83.33
AGAINST (EN CONTRA)	3	16.67
Over Votes	0	
Under Votes	0	
PROP 10 TYLER COUNTYWIDE		
VOTE FOR 1		
FOR (A FAVOR)	17	100.00
AGAINST (EN CONTRA)	0	
Over Votes	0	
Under Votes	1	
PROP 11 TYLER COUNTYWIDE		
VOTE FOR 1		
FOR (A FAVOR)	17	94.44
AGAINST (EN CONTRA)	1	5.56
Over Votes	0	
Under Votes	0	
PROP 12 TYLER COUNTYWIDE		
VOTE FOR 1		
FOR (A FAVOR)	13	72.22
AGAINST (EN CONTRA)	5	27.78
Over Votes	0	
Under Votes	0	
PROP 13 TYLER COUNTYWIDE		
VOTE FOR 1		
FOR (A FAVOR)	15	88.24
AGAINST (EN CONTRA)	2	11.76
Over Votes	0	
Under Votes	1	
PROP 14 TYLER COUNTYWIDE		
VOTE FOR 1		
FOR (A FAVOR)	16	88.89
AGAINST (EN CONTRA)	2	11.11
Over Votes	0	
Under Votes	0	

RUN DATE:11/06/07 05:18 PM

0014 PRECINCT 14

VOTES PERCENT

PROP 15 TYLER COUNTYWIDE

VOTE FOR 1

FOR (A FAVOR)	10	62.50
AGAINST (EN CONTRA)	6	37.50
Over Votes	0	
Under Votes	2	

PROP 16 TYLER COUNTYWIDE

VOTE FOR 1

FOR (A FAVOR)	12	70.59
AGAINST (EN CONTRA)	5	29.41
Over Votes	0	
Under Votes	1	

WARREN ISD PROP

VOTE FOR 1

FOR (A FAVOR)	2	66.67
AGAINST (EN CONTRA)	1	33.33
Over Votes	0	
Under Votes	0	

RUN DATE:11/06/07 05:18 PM

0015 PRECINCT 15

	VOTES	PERCENT		VOTES	PERCENT
REGISTERED VOTERS - TOTAL	0				
BALLOTS CAST - TOTAL	83				
PROP 1 TYLER COUNTYWIDE					
VOTE FOR 1					
FOR (A FAVOR)	33	49.25			
AGAINST (EN CONTRA)	34	50.75			
Over Votes	0				
Under Votes	16				
PROP 2 TYLER COUNTYWIDE					
VOTE FOR 1					
FOR (A FAVOR)	46	63.01			
AGAINST (EN CONTRA)	27	36.99			
Over Votes	0				
Under Votes	10				
PROP 3 TYLER COUNTYWIDE					
VOTE FOR 1					
FOR (A FAVOR)	43	67.19			
AGAINST (EN CONTRA)	21	32.81			
Over Votes	0				
Under Votes	19				
PROP 4 TYLER COUNTYWIDE					
VOTE FOR 1					
FOR (A FAVOR)	40	58.82			
AGAINST (EN CONTRA)	28	41.18			
Over Votes	0				
Under Votes	15				
PROP 5 TYLER COUNTYWIDE					
VOTE FOR 1					
FOR (A FAVOR)	41	62.12			
AGAINST (EN CONTRA)	25	37.88			
Over Votes	0				
Under Votes	17				
PROP 6 TYLER COUNTYWIDE					
VOTE FOR 1					
FOR (A FAVOR)	52	73.24			
AGAINST (EN CONTRA)	19	26.76			
Over Votes	0				
Under Votes	12				
PROP 7 TYLER COUNTYWIDE					
VOTE FOR 1					
FOR (A FAVOR)	48	76.19			
AGAINST (EN CONTRA)	15	23.81			
Over Votes	0				
Under Votes	20				
PROP 8 TYLER COUNTYWIDE					
VOTE FOR 1					
FOR (A FAVOR)	49	72.06			
AGAINST (EN CONTRA)	19	27.94			
Over Votes	0				
Under Votes	15				
PROP 9 TYLER COUNTYWIDE					
VOTE FOR 1					
FOR (A FAVOR)	58	82.86			
AGAINST (EN CONTRA)	12	17.14			
Over Votes	0				
Under Votes	13				
PROP 10 TYLER COUNTYWIDE					
VOTE FOR 1					
FOR (A FAVOR)	37	56.06			
AGAINST (EN CONTRA)	29	43.94			
Over Votes	0				
Under Votes	17				
PROP 11 TYLER COUNTYWIDE					
VOTE FOR 1					
FOR (A FAVOR)	46	73.02			
AGAINST (EN CONTRA)	17	26.98			
Over Votes	0				
Under Votes	20				
PROP 12 TYLER COUNTYWIDE					
VOTE FOR 1					
FOR (A FAVOR)	43	63.24			
AGAINST (EN CONTRA)	25	36.76			
Over Votes	0				
Under Votes	15				
PROP 13 TYLER COUNTYWIDE					
VOTE FOR 1					
FOR (A FAVOR)	57	81.43			
AGAINST (EN CONTRA)	13	18.57			
Over Votes	0				
Under Votes	13				
PROP 14 TYLER COUNTYWIDE					
VOTE FOR 1					
FOR (A FAVOR)	49	72.06			
AGAINST (EN CONTRA)	19	27.94			
Over Votes	0				
Under Votes	15				

RUN DATE:11/06/07 05:18 PM

0015 PRECINCT 15

VOTES PERCENT

PROP 15 TYLER COUNTYWIDE

VOTE FOR 1

FOR (A FAVOR)	51	76.12
AGAINST (EN CONTRA)	16	23.88
Over Votes	0	
Under Votes	16	

PROP 16 TYLER COUNTYWIDE

VOTE FOR 1

FOR (A FAVOR)	38	54.29
AGAINST (EN CONTRA)	32	45.71
Over Votes	0	
Under Votes	13	

WARREN ISD PROP

VOTE FOR 1

FOR (A FAVOR)	71	86.59
AGAINST (EN CONTRA)	11	13.41
Over Votes	0	
Under Votes	1	

RUN DATE:11/06/07 05:18 PM

0016 PRECINCT 16

	VOTES	PERCENT		VOTES	PERCENT
REGISTERED VOTERS - TOTAL	0				
BALLOTS CAST - TOTAL	54				
PROP 1 TYLER COUNTYWIDE					
VOTE FOR 1					
FOR (A FAVOR)	27	57.45			
AGAINST (EN CONTRA)	20	42.55			
Over Votes	0				
Under Votes	7				
PROP 2 TYLER COUNTYWIDE					
VOTE FOR 1					
FOR (A FAVOR)	28	57.14			
AGAINST (EN CONTRA)	21	42.86			
Over Votes	0				
Under Votes	5				
PROP 3 TYLER COUNTYWIDE					
VOTE FOR 1					
FOR (A FAVOR)	22	48.89			
AGAINST (EN CONTRA)	23	51.11			
Over Votes	0				
Under Votes	9				
PROP 4 TYLER COUNTYWIDE					
VOTE FOR 1					
FOR (A FAVOR)	27	57.45			
AGAINST (EN CONTRA)	20	42.55			
Over Votes	0				
Under Votes	7				
PROP 5 TYLER COUNTYWIDE					
VOTE FOR 1					
FOR (A FAVOR)	27	60.00			
AGAINST (EN CONTRA)	18	40.00			
Over Votes	0				
Under Votes	9				
PROP 6 TYLER COUNTYWIDE					
VOTE FOR 1					
FOR (A FAVOR)	30	63.83			
AGAINST (EN CONTRA)	17	36.17			
Over Votes	0				
Under Votes	7				
PROP 7 TYLER COUNTYWIDE					
VOTE FOR 1					
FOR (A FAVOR)	38	79.17			
AGAINST (EN CONTRA)	10	20.83			
Over Votes	0				
Under Votes	6				
PROP 8 TYLER COUNTYWIDE					
VOTE FOR 1					
FOR (A FAVOR)	30	66.67			
AGAINST (EN CONTRA)	15	33.33			
Over Votes	0				
Under Votes	9				
PROP 9 TYLER COUNTYWIDE					
VOTE FOR 1					
FOR (A FAVOR)	40	81.63			
AGAINST (EN CONTRA)	9	18.37			
Over Votes	0				
Under Votes	5				
PROP 10 TYLER COUNTYWIDE					
VOTE FOR 1					
FOR (A FAVOR)	29	65.91			
AGAINST (EN CONTRA)	15	34.09			
Over Votes	0				
Under Votes	10				
PROP 11 TYLER COUNTYWIDE					
VOTE FOR 1					
FOR (A FAVOR)	37	80.43			
AGAINST (EN CONTRA)	9	19.57			
Over Votes	0				
Under Votes	8				
PROP 12 TYLER COUNTYWIDE					
VOTE FOR 1					
FOR (A FAVOR)	29	65.91			
AGAINST (EN CONTRA)	15	34.09			
Over Votes	0				
Under Votes	10				
PROP 13 TYLER COUNTYWIDE					
VOTE FOR 1					
FOR (A FAVOR)	39	81.25			
AGAINST (EN CONTRA)	9	18.75			
Over Votes	0				
Under Votes	6				
PROP 14 TYLER COUNTYWIDE					
VOTE FOR 1					
FOR (A FAVOR)	36	78.26			
AGAINST (EN CONTRA)	10	21.74			
Over Votes	0				
Under Votes	8				

RUN DATE:11/06/07 05:18 PM

0016 PRECINCT 16

VOTES PERCENT

PROP 15 TYLER COUNTYWIDE

VOTE FOR 1

FOR (A FAVOR)	34	72.34
AGAINST (EN CONTRA)	13	27.66
Over Votes	0	
Under Votes	7	

PROP 16 TYLER COUNTYWIDE

VOTE FOR 1

FOR (A FAVOR)	22	47.83
AGAINST (EN CONTRA)	24	52.17
Over Votes	0	
Under Votes	8	

WARREN ISD PROP

VOTE FOR 1

FOR (A FAVOR)	31	57.41
AGAINST (EN CONTRA)	23	42.59
Over Votes	0	
Under Votes	0	

RUN DATE:11/06/07 05:18 PM

0017 PRECINCT 17

	VOTES	PERCENT		VOTES	PERCENT
REGISTERED VOTERS - TOTAL	0				
BALLOTS CAST - TOTAL	2				
PROP 1 TYLER COUNTYWIDE					
VOTE FOR 1					
FOR (A FAVOR)	1	50.00			
AGAINST (EN CONTRA)	1	50.00			
Over Votes	0				
Under Votes	0				
PROP 2 TYLER COUNTYWIDE					
VOTE FOR 1					
FOR (A FAVOR)	1	50.00			
AGAINST (EN CONTRA)	1	50.00			
Over Votes	0				
Under Votes	0				
PROP 3 TYLER COUNTYWIDE					
VOTE FOR 1					
FOR (A FAVOR)	2	100.00			
AGAINST (EN CONTRA)	0				
Over Votes	0				
Under Votes	0				
PROP 4 TYLER COUNTYWIDE					
VOTE FOR 1					
FOR (A FAVOR)	1	50.00			
AGAINST (EN CONTRA)	1	50.00			
Over Votes	0				
Under Votes	0				
PROP 5 TYLER COUNTYWIDE					
VOTE FOR 1					
FOR (A FAVOR)	1	50.00			
AGAINST (EN CONTRA)	1	50.00			
Over Votes	0				
Under Votes	0				
PROP 6 TYLER COUNTYWIDE					
VOTE FOR 1					
FOR (A FAVOR)	2	100.00			
AGAINST (EN CONTRA)	0				
Over Votes	0				
Under Votes	0				
PROP 7 TYLER COUNTYWIDE					
VOTE FOR 1					
FOR (A FAVOR)	1	50.00			
AGAINST (EN CONTRA)	1	50.00			
Over Votes	0				
Under Votes	0				
PROP 8 TYLER COUNTYWIDE					
VOTE FOR 1					
FOR (A FAVOR)	2	100.00			
AGAINST (EN CONTRA)	0				
Over Votes	0				
Under Votes	0				
PROP 9 TYLER COUNTYWIDE					
VOTE FOR 1					
FOR (A FAVOR)	1	50.00			
AGAINST (EN CONTRA)	1	50.00			
Over Votes	0				
Under Votes	0				
PROP 10 TYLER COUNTYWIDE					
VOTE FOR 1					
FOR (A FAVOR)	0				
AGAINST (EN CONTRA)	2	100.00			
Over Votes	0				
Under Votes	0				
PROP 11 TYLER COUNTYWIDE					
VOTE FOR 1					
FOR (A FAVOR)	1	50.00			
AGAINST (EN CONTRA)	1	50.00			
Over Votes	0				
Under Votes	0				
PROP 12 TYLER COUNTYWIDE					
VOTE FOR 1					
FOR (A FAVOR)	1	50.00			
AGAINST (EN CONTRA)	1	50.00			
Over Votes	0				
Under Votes	0				
PROP 13 TYLER COUNTYWIDE					
VOTE FOR 1					
FOR (A FAVOR)	2	100.00			
AGAINST (EN CONTRA)	0				
Over Votes	0				
Under Votes	0				
PROP 14 TYLER COUNTYWIDE					
VOTE FOR 1					
FOR (A FAVOR)	1	50.00			
AGAINST (EN CONTRA)	1	50.00			
Over Votes	0				
Under Votes	0				

RUN DATE:11/06/07 05:18 PM

0017 PRECINCT 17

VOTES PERCENT

PROP 15 TYLER COUNTYWIDE

VOTE FOR 1		
FOR (A FAVOR)	2	100.00
AGAINST (EN CONTRA)	0	
Over Votes	0	
Under Votes	0	

PROP 16 TYLER COUNTYWIDE

VOTE FOR 1		
FOR (A FAVOR)	1	50.00
AGAINST (EN CONTRA)	1	50.00
Over Votes	0	
Under Votes	0	

RUN DATE:11/06/07 05:18 PM

0012 PRECINCT 18

	VOTES	PERCENT
REGISTERED VOTERS - TOTAL	0	
BALLOTS CAST - TOTAL	57	
PROP 1 TYLER COUNTYWIDE		
VOTE FOR 1		
FOR (A FAVOR)	32	60.38
AGAINST (EN CONTRA)	21	39.62
Over Votes	0	
Under Votes	4	
PROP 2 TYLER COUNTYWIDE		
VOTE FOR 1		
FOR (A FAVOR)	35	63.64
AGAINST (EN CONTRA)	20	36.36
Over Votes	0	
Under Votes	2	
PROP 3 TYLER COUNTYWIDE		
VOTE FOR 1		
FOR (A FAVOR)	43	78.18
AGAINST (EN CONTRA)	12	21.82
Over Votes	0	
Under Votes	2	
PROP 4 TYLER COUNTYWIDE		
VOTE FOR 1		
FOR (A FAVOR)	29	53.70
AGAINST (EN CONTRA)	25	46.30
Over Votes	0	
Under Votes	3	
PROP 5 TYLER COUNTYWIDE		
VOTE FOR 1		
FOR (A FAVOR)	39	69.64
AGAINST (EN CONTRA)	17	30.36
Over Votes	0	
Under Votes	1	
PROP 6 TYLER COUNTYWIDE		
VOTE FOR 1		
FOR (A FAVOR)	38	67.86
AGAINST (EN CONTRA)	18	32.14
Over Votes	0	
Under Votes	1	
PROP 7 TYLER COUNTYWIDE		
VOTE FOR 1		
FOR (A FAVOR)	43	75.44
AGAINST (EN CONTRA)	14	24.56
Over Votes	0	
Under Votes	0	

PROP 8 TYLER COUNTYWIDE

VOTE FOR 1		
FOR (A FAVOR)	45	78.95
AGAINST (EN CONTRA)	12	21.05
Over Votes	0	
Under Votes	0	

PROP 9 TYLER COUNTYWIDE

VOTE FOR 1		
FOR (A FAVOR)	48	84.21
AGAINST (EN CONTRA)	9	15.79
Over Votes	0	
Under Votes	0	

PROP 10 TYLER COUNTYWIDE

VOTE FOR 1		
FOR (A FAVOR)	43	76.79
AGAINST (EN CONTRA)	13	23.21
Over Votes	0	
Under Votes	1	

PROP 11 TYLER COUNTYWIDE

VOTE FOR 1		
FOR (A FAVOR)	45	80.36
AGAINST (EN CONTRA)	11	19.64
Over Votes	0	
Under Votes	1	

PROP 12 TYLER COUNTYWIDE

VOTE FOR 1		
FOR (A FAVOR)	37	66.07
AGAINST (EN CONTRA)	19	33.93
Over Votes	0	
Under Votes	1	

PROP 13 TYLER COUNTYWIDE

VOTE FOR 1		
FOR (A FAVOR)	53	92.98
AGAINST (EN CONTRA)	4	7.02
Over Votes	0	
Under Votes	0	

PROP 14 TYLER COUNTYWIDE

VOTE FOR 1		
FOR (A FAVOR)	42	73.68
AGAINST (EN CONTRA)	15	26.32
Over Votes	0	
Under Votes	0	

RUN DATE:11/06/07 05:18 PM

0012 PRECINCT 18

VOTES PERCENT

PROP 15 TYLER COUNTYWIDE

VOTE FOR 1

FOR (A FAVOR)	34	59.65
AGAINST (EN CONTRA)	23	40.35
Over Votes	0	
Under Votes	0	

PROP 16 TYLER COUNTYWIDE

VOTE FOR 1

FOR (A FAVOR)	35	61.40
AGAINST (EN CONTRA)	22	38.60
Over Votes	0	
Under Votes	0	

RUN DATE:11/06/07 05:18 PM

0018 HARDIN CO PRECINCT 8 & 11

VOTES PERCENT

REGISTERED VOTERS - TOTAL 0
BALLOTS CAST - TOTAL 15

WARREN ISD PROP

VOTE FOR 1

FOR (A FAVOR) 14 93.33
AGAINST (EN CONTRA) 1 6.67
Over Votes 0